

1/2  
MAR 08 1999

KENT COUNTY REMONUMENTATION

SECTION

LAND CORNER RECORDATION CERTIFICATE  
Filing Requirement of Act 74, Mich. P.A. 1970

For corners in

KENT COUNTY

(County)

Located In:

Corner Code #

- |                                    |              |               |            |
|------------------------------------|--------------|---------------|------------|
| 1. Public Land Survey              | T <u>9</u> N | R <u>12</u> W | <u>L-2</u> |
|                                    | T _____      | R _____       | _____      |
|                                    | T _____      | R _____       | _____      |
|                                    | T _____      | R _____       | _____      |
| 2. Property Controlling in Section | S _____      | T _____       | R _____    |
|                                    | S _____      | T _____       | R _____    |
| 3. Miscellaneous Property in Sec.  | S _____      | T _____       | R _____    |
|                                    | S _____      | T _____       | R _____    |

STATE OF MICHIGAN  
COUNTY OF KENT  
RECEIVED FOR RECORD  
38 OCT -7 AM 10:15  
REG. OF DEEDS  
*Lucy Spauld*

10727

Register of Deeds Stamp & File Number

4. Lot No. \_\_\_\_\_, Recorded Plat \_\_\_\_\_  
5. Private Claims \_\_\_\_\_

I, Kirk Breitels, in a field survey on Sept. 2, 1998 do hereby state that under requirements of P.A. 74, Michigan P.A. of 1970, the corner points mentioned in lines 1 and 2 above were in conformance with regulations and rules therefore as required in the current manual of survey instructions of the United States Department of the Interior, Bureau of Land Management or by a decree of a Court of Law and /or that the corner points mentioned in lines 3, 4 and 5 above were in conformance with the rules of the Michigan Board of Land Surveyors or by a Decree of a Court of Law; established, re-established, monumented, recovered, found as expressed below:

NOTE: Not more than 2 corners, all in the same town and range, may be recorded on this certificate.

	A	B	C	D	E	F	G	H	I	J	K	L	M
1													
2		6		5		4		3		2		1	
3													
4		7		8		9		10		11		12	
5													
6		18		17		16		15		14		13	
7													
8		19		20		21		22		23		24	
9													
10		30		29		28		27		26		25	
11													
12		31		32		33		34		35		36	
13													

A. Description of original monument and accessories and/or subsequent restoration:

- |     |      |               |          |                          |
|-----|------|---------------|----------|--------------------------|
| L-2 | 1837 | GLO           | Whitcomb | Not Set                  |
|     |      | Kent Co. Wits |          | Iron in Mon. Box         |
|     | 1979 | LCRC #3320    |          | 3/4" Iron in Mon. Box    |
|     | 1992 | LCRC #6610    | Bueche   | Set Kent County Monument |

P.A. 345 1990 KENT COUNTY  
PEER APPROVED 9/24/98  
CHAIRMAN Harry Haber

The position of this corner was previously approved by the Kent County Remonumentation Peer Group, monumented by John C. Bueche on 10-12-92 and was recorded per LCRC #6610.

B. Description of corner evidence found and/or method applied in restoring or reestablishing corner:

L-2 Found Kent County Monument (Harrison) per witnesses from above LCRC as set by John C. Bueche in place of the "T" Iron inside a 3/4" Iron he found inside a Mon. Box. Both Irons check with Kent Co. Wit. and LCRC #3320.  
LCRC #6610

- |  |       |         |
|--|-------|---------|
| NE corner of school house              | S30°W | 145.10' |
| Nail & Remon. tag E. side 24" Sycamore | S05°W | 137.98' |
| Nail & Remon. tag W. side 8" Elm       | S30°E | 80.94'  |
| Nail & Remon. tag N. side P. Pole      | S70°E | 128.68' |
| Nail & Remon. tag E. side P. Pole      | S35°W | 43.74'  |

Corner is 0.64' N. and 1.57' E. of intersection of 1/4 lines. On C/L road to East, N-S road is 2' East

The selected location is accepted by me and is generally accepted by professional surveyors as the best available evidence of the position of the corner.

C. Description of monument for corner and accessories established to perpetuate locating the position of the corner:

- L-2 Standard Kent County Monument
- |   |       |         |
|---|-------|---------|
| NE corner of school house foundation      | S30°W | 145.40' |
| Nail & KC Remon. tag E. side 24" Sycamore | S05°W | 137.98' |
| Nail & KC Remon. tag N. side P. Pole      | S70°E | 128.68' |
| Nail & KC Remon. tag E. side P. Pole      | S35°W | 43.74'  |
| Nail & KC Remon. tag NW side Twin Elm     | N40°E | 73.74'  |
| SE face of 4" steel pipe                  | N35°W | 52.40'  |
- Corner is 0.7' N. and 1.7' E. of intersection of 1/4 lines.  
Corner is on C/L road to East ±, N-S road is 5' East ± (road const. 1997)

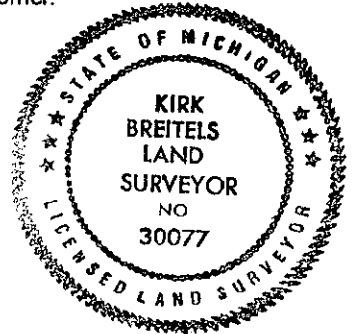

Signed by *Kirk Breitels*  
Surveyor's Michigan License No. 30077

Date 9/24/98