



SURVEY & REMONUMENTATION

MAR 08 1999

KENT COUNTY REMONUMENTATION

SECTION

LAND CORNER RECORDATION CERTIFICATE
Filing Requirement of Act 74, Mich. P.A. 1970

For corners in
KENT COUNTY
(County)

Located in:	Corner Code #
1. Public Land Survey	T 9N R 12W L-12
	T _____ R _____
	T _____ R _____
	T _____ R _____
2. Property Controlling in Section	S _____ T _____ R _____
	S _____ T _____ R _____
3. Miscellaneous Property in Sec.	S _____ T _____ R _____
	S _____ T _____ R _____

STATE OF MICHIGAN
 COUNTY OF KENT
 RECEIVED FOR RECORD
 98 OCT -7 AM 10:15
 REG. OF DEEDS
Luci Sand

10729

Register of Deeds Stamp & File Number

4. Lot No. _____, Recorded Plat _____
 5. Private Claims _____

I, Kirk Breitels, in a field survey on July 2, 1998 do hereby state that under requirements of P.A. 74, Michigan P.A. of 1970, the corner points mentioned in lines 1 and 2 above were in conformance with regulations and rules therefore as required in the current manual of survey instructions of the United States Department of the Interior, Bureau of Land Management or by a decree of a Court of Law and/or that the corner points mentioned in lines 3, 4 and 5 above were in conformance with the rules of the Michigan Board of Land Surveyors or by a Decree of a Court of Law; established, re-established, monumented, recovered, found as expressed below:

NOTE: Not more than 2 corners, all in the same town and range, may be recorded on this certificate.

	A	B	C	D	E	F	G	H	I	J	K	L	M
1													
2	6		5		4		3		2		1		
3													
4	7		8		9		10		11		12		
5													
6	18		17		16		15		14		13		
7													
8	19		20		21		22		23		24		
9													
10	30		29		28		27		26		25		
11													
12	31		32		33		34		35		36		
13	*												

A. Description of original monument and accessories and/or subsequent restoration:

L-12 1837 GLO	Not Set
1946 Williams & Works	Stone
1965-67 Williams & Works	Nail
1972-86 Williams & Works	Mon. Box
1972 LCRC #125	Chambers Iron in Mon. Box
20" Maple N30°E 82.47'	14" Twin Cherry East 32.43'
42" Ash S18°W 107.30'	

P.A. 345 1990 KENT COUNTY
 PEER APPROVED 7/23/98
 CHAIRMAN *[Signature]*

B. Description of corner evidence found and/or method applied in restoring or reestablishing corner:

L-12 Found 1/2" Iron Pipe over a 3" Iron Pipe in Mon. Box per the following witnesses:
 C/L 32" Maple N25°E 82' C/L Triple 14" Cherry N90°E 33' C/L 48" Ash S20°W 107'

Both Iron Pipes in Mon. Box are 6.9' E. (6.6' E. per Williams & Works - 1972) & 0.1' N. of intersection of 1/4 lines and has also been used in surveys by All Points, Ed Glaza, Wally Glaza and Roosien.

The Iron Pipes in Mon. Box are accepted by me and is generally accepted by professional surveyors as the best available evidence of the position of the corner.

C. Description of monument for corner and accessories established to perpetuate locating the position of the corner:

L-12 Set Standard Kent County Monument in place of the 1/2" Iron Pipe, 3" Iron Pipe and Mon. Box.

Nail & KC Remon. tag W. side 32" Maple	N25°E	82.09'
Nail & KC Remon. tag N. side Tri. 14" Cherry	N90°E	32.86'
Nail & KC Remon. tag E. side 48" Ash	S20°W	107.07'
Nail & KC Remon. tag N. side Tw. 6" Elm	S85°W	23.91'
Nail & KC Remon. tag W. side 12" Maple	N35°E	44.17'

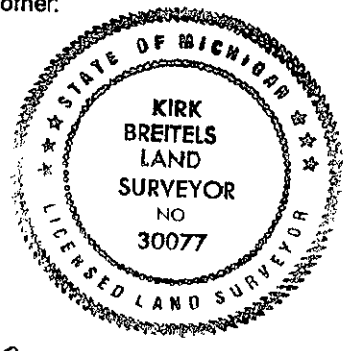

Signed by *Kirk Breitels*
 Surveyor's Michigan License No. 30077

Date 9/25/98