

SURVEY & REMONUMENTATION

KENT COUNTY REMONUMENTATION

\$7.00
\$2.00

MAR 08 1999

LAND CORNER RECORDATION CERTIFICATE
Filing Requirement of Act 74, Mich. P.A. 1970

For corners in SECTION

KENT COUNTY
(County)

Located In: Corner Code #

- 1. Public Land Survey

T 9N	R 12W	M-9
T	R	common with
T 9N	R 11W	A-9
T	R	
- 2. Property Controlling in Section

S	T	R	
S	T	R	
- 3. Miscellaneous Property in Sec.

S	T	R	
S	T	R	

STATE OF MICHIGAN
 COUNTY OF KENT
 RECEIVED FOR RECORD
 98 MAR -5 AM 8:31
 REG. OF DEEDS
Lucy Bond

10503

Register of Deeds Stamp & File Number

- 4. Lot No. _____, Recorded Plat _____
- 5. Private Claims _____

I, Kirk Breitels, in a field survey on Jan. 5, 1998 do hereby state that under requirements of P.A. 74, Michigan P.A. of 1970, the corner points mentioned in lines 1 and 2 above were in conformance with regulations and rules therefore as required in the current manual of survey instructions of the United States Department of the Interior, Bureau of Land Management or by a decree of a Court of Law and/or that the corner points mentioned in lines 3, 4 and 5 above were in conformance with the rules of the Michigan Board of Land Surveyors or by a Decree of a Court of Law; established, re-established, monumented, recovered, found as expressed below:

NOTE: Not more than 2 corners, all in the same town and range, may be recorded on this certificate.

	A	B	C	D	E	F	G	H	I	J	K	L	M
1													
2	6		5		4		3		2		1		
3													
4	7		8		9		10		11		12		
5													
6	18		17		16		15		14		13		
7													
8	19		20		21		22		23		24		
9													
10	30		29		28		27		26		25		
11													
12	31		32		33		34		35		36		
13													

A. Description of original monument and accessories and/or subsequent restoration:

M-9	1837	GLO	Brookfield	Set Post
	1962	Kent Co. Wits		1" Iron
	1983	LCRC #3399	Glaza	PK Nail
	1984	LCRC #4021	Rosema	Set Kent County Monument
	1995	LCRC #8336	Breitels	Kent County Monument

P.A. 345 1990 KENT COUNTY
 PEER APPROVED 2/19/98
 CHAIRMAN *Harry Thayer*

The position of this corner was previously approved by the Kent County Remonumentation Peer Group, monumented by Maurice J. Rosema on 11-20-84 and was recorded per LCRC#4021.

B. Description of corner evidence found and/or method applied in restoring or reestablishing corner:

M-9 Found Kent County Monument (Harrison) per witnesses from above LCRC as set by Maurice J. Rosema in place of the 1/2" Iron Pipe he found over a Leaded Stone. Said Iron & Stone checks with Kent Co. Wits. and LCRC #3399.

LCRC #4021		LCRC #8336
Nail & Remon. tag 18" Maple	N37°W 53.25'	Nail & Remon. tag 22" Maple N37°W 53.28'
Nail & Remon. tag 12" Pine	N41°E 71.08'	Nail & Remon. tag 16" Pine N41°E 71.11'
Nail & Remon. tag 10" Pine	S41°E 49.33'	Nail & Remon. tag 14" Pine S41°E 49.34'
Nail & Remon. tag 28" Oak	S36°W 57.77'	Nail & Remon. tag 32" Oak S36°W 57.78'
Nail & Remon. tag Tri. 12" Walnut	N62°W 51.95'	Nail & Remon. tag Tri. 16" Walnut N62°W 51.86'

On C/L N-S b.t. road

The selected location is accepted by me and is generally accepted by professional surveyors as the best available evidence of the position of the original corner.

C. Description of monument for corner and accessories established to perpetuate locating the position of the corner:

M-9 Standard Kent County Monument

Nail & KC Remon. tag NE side 22" Maple	N37°W 53.28'
Nail & KC Remon. tag NW side 16" Pine	N41°E 71.07'
Nail & KC Remon. tag SW side 14" Pine	S41°E 49.34'
Nail & KC Remon. tag SE side 34" Oak	S36°W 57.75'
Nail & KC Remon. tag S. side Tri. 16" Walnut	N62°W 51.86'

On centerline N-S blacktop road

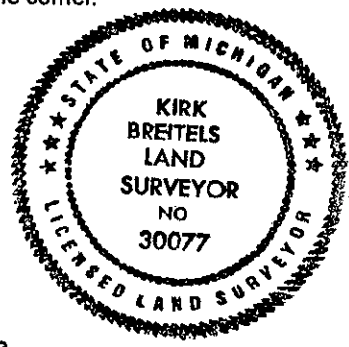

Signed by *Kirk Breitels*
 Surveyor's Michigan License No. 30077

Date 2/19/98