

\$7.00  
\$2.00

MAY 22 2000 KENT COUNTY REMONUMENTATION

SECTION LAND CORNER RECORDATION CERTIFICATE  
Filing Requirement of Act 74, Mich. P.A. 1970

For corners in

KENT COUNTY  
(County)

Located in: Corner Code #

- 1. Public Land Survey
 

T 10NR 11W	M-2 Solon Twp.
T R	Common
T 10NR 10W	A-2 Nelson Twp.
T R	
- 2. Property Controlling in Section
 

S T R	
S T R	
- 3. Miscellaneous Property in Sec.
 

S T R	
S T R	

STATE OF MICHIGAN  
COUNTY OF KENT  
RECEIVED FOR RECORD

1999 MAR 24 AM 8:00

11111

Register of Deeds Stamp & File Number

- 4. Lot No. \_\_\_\_\_, Recorded Plat \_\_\_\_\_
- 5. Private Claims \_\_\_\_\_

I, Kirk Breitels, in a field survey on Feb. 9, 1999 do hereby state that under requirements of P.A. 74, Michigan P.A. of 1970, the corner points mentioned in lines 1 and 2 above were in conformance with regulations and rules therefore as required in the current manual of survey instructions of the United States Department of the Interior, Bureau of Land Management or by a decree of a Court of Law and /or that the corner points mentioned in lines 3, 4 and 5 above were in conformance with the rules of the Michigan Board of Land Surveyors or by a Decree of a Court of Law, established, re-established, monumented, recovered, found as expressed below.

NOTE: Not more than 2 corners, all in the same town and range, may be recorded on this certificate.

	A	B	C	D	E	F	G	H	I	J	K	L	M
1													
2	6	5	4	3	2	1							
3													
4	7	8	9	10	11	12							
5													
6	10	17	16	15	14	13							
7													
8	19	20	21	22	23	24							
9													
10	30	29	28	27	26	25							
11													
12	31	32	33	34	35	36							
13													

A. Description of original monument and accessories and/or subsequent restoration:

- M-2 1837 GLO Brookfield Set Post
- 1901 Williams & Works Stake & Crockery
- 1961 Kent Co. Wits 2" Iron
- 1981 LCRC #3564 VanKooten Iron in Mon. Box
- 1983 LCRC #3610 Hackbardt Iron in Mon. Box
- 1992 LCRC #6596 Bueche Set Kent County Monument in Mon. Box

P.A. 345 1930 KENT COUNTY  
PEER APPROVED 2/25/99  
CHAIRMAN [Signature]

The position of this corner was previously approved by the Kent County Remonumentation Peer Group, monumented by John C. Bueche on 10-12-96 and was recorded per LCRC #6596.

B. Description of corner evidence found and/or method applied in restoring or reestablishing corner:

M-2 Found Kent County Monument (Harrison) per witnesses from above LCRC as set by John C. Bueche in place of the Iron he found in a Mon. Box. Said Iron checks with LCRC's #3564 & #3610. No Kent Co. Wits. remain.

- LCRC #6596
- Square Spike S. side P. Pole N70°E 106.99'
- Nail & Remon. tag in curb joint N45°E 41.43'
- SE corner concrete porch N60°W 111.84'
- NW corner house foundation S60°E 126.17'
- "X" on curb S25°E 50.18'

On C/L bit. N-S and on C/L gravel East

The selected location is accepted by me and is generally accepted by professional surveyors as the best available evidence of the position of the original corner.

C. Description of monument for corner and accessories established to perpetuate locating the position of the corner:

- M-2 Standard Kent County Monument in Mon. Box
- Square Spike in S. side P. Pole N70°E 107.05'
- Nail & KC Remon. tag in curb joint N45°E 41.46'
- SE corner concrete porch N60°W 111.78'
- NW corner house foundation S60°E 126.25'
- "X" on curb S25°E 50.18'

On C/L N-S asphalt road and on C/L gravel road East ±

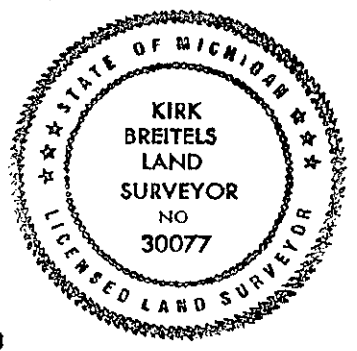

Signed by [Signature]  
Surveyor's Michigan License No. 30077

Date 2/25/99