

JAN 24 1996

KENT COUNTY REMONUMENTATION COMMISSION

LAND CORNER RECORDATION CERTIFICATE

Filing Requirement of Act 74, Mich. P.A. 1970

\$7.00 \$2.00

For corners in KENT COUNTY (County)

Located In: Corner Code #

- 1. Public Land Survey T 10N R 10W B-7
2. Property Controlling in Section S T R
3. Miscellaneous Property in Section S T R

- 4. Lot No. Recorded Plat
5. Private Claims

Stamp area containing 'STATE OF MICHIGAN COUNTY OF KENT RECEIVED FOR RECORD', 'REG. OF DEEDS', date '95 DEC 20 AM 8:36', and '875736 Register of Deeds Stamp & File Number'.

I, Kirk Breitels, in a field survey on Nov. 13, 1995

do hereby certify that under requirements of P.A. 74, Michigan P.A. of 1970, the corner points mentioned in lines 1 and 2 above were in conformance with regulations and rules therefore as required in the current manual of survey instructions of the United States Department of the Interior, Bureau of Land Management or by a decree of a Court of Law and/or that the corner points mentioned in lines 3, 4 and 5 above were in conformance with the rules of the Michigan Board of Professional Surveyors or by a Decree of a Court of Law; established, re-established, monumented, re-monumented, recovered, found as expressed below:

NOTE: Not more than 4 corners, all in the same town and range, may be recorded on this certificate.

Grid table with columns A-M and rows 2-13, used for recording corner locations.

A. Description of original monument and accessories and/or subsequent restoration:

- B-7 1837 GLO Cathcart Set Post 1906 Williams & Works Stake
1955-68 Williams & Works Set Iron on C/L old road 2643.0' W. of NE cor. Sec. 19
1957 Blass Surveys Boat Spike & 2" x 2" Hub
12" Willow N60°E 36.15' 12" Willow S35°E 28.38' 4" Willow N55°W 20.77'
1967 MDSH Boat Spike on fence line
22" Cherry NE 4.56' 12" Maple SE 41.64' 9" Maple SW 23.41'
1987 LCRC #4550 Hackbardt 1 1/4" Iron on C/L E-W trail
3" Maple Cl. S05°W 5.65' 12" Maple S20°E 51.0'
14" Maple S70°W 51.1' 15" Db1. Maple S80°W 70.75'

B. Description of corner evidence found and/or method applied in restoring or reestablishing corner:

B-7 Found 1 1/4" Iron Pipe on C/L old road through swampy area per witnesses from LCRC #4550 - 3" Maple Cl. S05°W 5.65' - 14" Maple S70°W 51.0' - 15" db1. Maple S80°W 70.75'. Did not find Boat Spike, however witnesses from 1957 Blass Surveys fit ± to C/L Willows at bearings given. No witnesses from 1967 MDSH remain. Measured the following using the 1 1/4" Iron Pipe:

- 2739.1' W. to NW cor. Sec. 19 (2741.5' WW 1906 - 2739' GLO)
2642.3' E. to NE cor. Sec. 19 (2643.0' WW 1906 & 1955 - 2640 GLO)
1321.0' E. to Iron Pipe @ 1/8 cor. ± (1321.5' WW 1955)
(Iron Pipe @ 1/8 cor. is 0.6' N. of line)
10.5' N. of a line between the NW & NE cor. (12' WW 1906)

The 1 1/4" Iron Pipe is accepted by me and is generally accepted by professional surveyors as the best available evidence of the position of the original corner.

C. Description of monument for corner and accessories established to perpetuate locating the position of the corner:

- B-7 Set Standard Kent County Monument in place of the 1 1/4" Iron Pipe
Set Nail & KC Remon. tag W. side 15" Maple S15°E 51.00'
Set Nail & KC Remon. tag W. side cluster 6" Maple S15°W 5.96'
Set Nail & KC Remon. tag E. side cluster 6" Maple S50°W 24.84'
Set Nail & KC Remon. tag N. side 4" Maple S80°W 20.88'
Set Nail & KC Remon. tag SE side 3" Maple N50°E 10.26'

PEER APPROVED 11/30/95
CHAIRMAN [Signature]

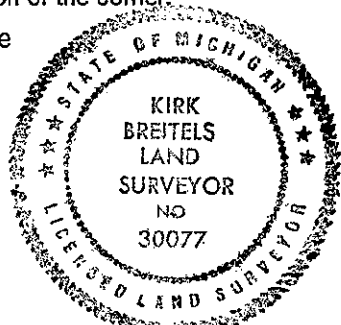

Signed by [Signature]

Date 12/11/95

Surveyor's Michigan License No. 30077