

MAY 22 2000

KENT COUNTY REMONUMENTATION

SECTION LAND CORNER RECORDATION CERTIFICATE
Filing Requirement of Act 74, Mich. P.A. 1970

For corners in

KENT COUNTY (County)

Located In:

Corner Code #

- 1. Public Land Survey T 10N R 12W M-2 Tyrone Twp.
T R Common
T 10N R 11W A-2 Solon Twp.
T R
2. Property Controlling in Section S T R
S T R
3. Miscellaneous S T R
Property in Sec. S T R

STATE OF MICHIGAN COUNTY OF KENT RECEIVED FOR RECORD 1999 MAR 24 AM 6:03 REG. OF DEEDS

11200

Register of Deeds Stamp & File Number

4. Lot No. , Recorded Plat
5. Private Claims

I, Kirk Breitels, in a field survey on Feb. 9, 1999 do hereby state that under requirements of P.A. 74, Michigan P.A. of 1970, the corner points mentioned in lines 1 and 2 above were in conformance with regulations and rules therefore as required in the current manual of survey instructions of the United States Department of the Interior, Bureau of Land Management or by a decree of a Court of Law and/or that the corner points mentioned in lines 3, 4 and 5 above were in conformance with the rules of the Michigan Board of Land Surveyors or by a Decree of a Court of Law; established, re-established, monumented, recovered, found as expressed below:

NOTE: Not more than 2 corners, all in the same town and range, may be recorded on this certificate.

Grid table with columns A-M and rows 1-13. A dot is present in the top right corner of the grid.

A. Description of original monument and accessories and/or subsequent restoration:

Table with 4 columns: Monument ID, Location, Description, Material. Includes entries for Brookfield, Hackbardt, Kolehouse, and Kent County Monument.

P.A. 345 1990 KENT COUNTY PEER APPROVED 2/25/99 CHAIRMAN Harry J. Fisher

The position of this corner was previously approved by the Kent County Remonumentation Peer Group, monumented by Randy J. Kolehouse on 4-5-86 and was recorded per LCRC #4451.

B. Description of corner evidence found and/or method applied in restoring or reestablishing corner:

M-2 Found Kent County Monument (Harrison) per witnesses from above LCRC as set by Randy J. Kolehouse in place of the 1/2" x 3" Leaf Spring he found. Said Leaf Spring checks with Kent Co. Wits. and LCRC #4497.

Table comparing LCRC #4451 and LCRC #6038 with measurements for various monuments and materials like Pine, Cherry, Elm, Maple, and fence post.

The selected location is accepted by me and is generally accepted by professional surveyors as the best available evidence of the position of the original corner.

C. Description of monument for corner and accessories established to perpetuate locating the position of the corner:

Table with 2 columns: Monument ID, Description. Includes M-2 Standard Kent County Monument with measurements for Pine, stump, Elm, Maple, and road bed.

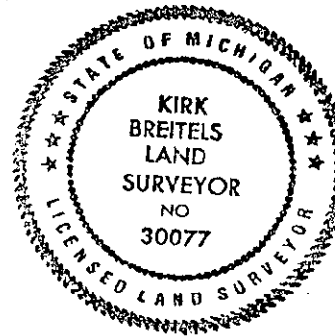

Signed by [Signature] Surveyor's Michigan License No. 30077

Date 2/25/99