

MAY 22 2000

KENT COUNTY REMONUMENTATION

SECTION

LAND CORNER RECORDATION CERTIFICATE
Filing Requirement of Act 74, Mich. P.A. 1970

For corners in

KENT COUNTY

(County)

Located In:

Corner Code #

1. Public Land Survey

T 10N R 12W M-4 Tyrone Twp.

T R Common

T 10N R 11W A-4 Solon Twp.

T R

2. Property Controlling in Section

S T R

S T R

3. Miscellaneous

S T R

Property in Sec.

S T R

4. Lot No. _____, Recorded Plat _____

5. Private Claims _____

I, Kirk Breitels, in a field survey on Feb. 18, 1999 do hereby state that under requirements of P.A. 74, Michigan P.A. of 1970, the corner points mentioned in lines 1 and 2 above were in conformance with regulations and rules therefore as required in the current manual of survey instructions of the United States Department of the Interior, Bureau of Land Management or by a decree of a Court of Law and/or that the corner points mentioned in lines 3, 4 and 5 above were in conformance with the rules of the Michigan Board of Land Surveyors or by a Decree of a Court of Law; established, re-established, monumented, recovered, found as expressed below:

NOTE: Not more than 2 corners, all in the same town and range, may be recorded on this certificate.

A. Description of original monument and accessories and/or subsequent restoration:

| | | | |
|----------|---------------|------------|--------------------------|
| M-4 1837 | GLO | Brookfield | Set Post |
| 1937 | Kent Co. Wits | | Dbl. Barrel of Shotgun |
| 1974 | LCRC #717 | VanKooten | Dbl. Barrel of Shotgun |
| 1980 | LCRC #1747 | Merdzinski | Set Kent County Monument |
| 1991 | LCRC #6040 | Byl | Kent County Monument |

P.A. 345 1990 KENT COUNTY

PEER APPROVED, 2/25/99
CHAIRMAN [Signature]

The position of this corner was previously approved by the Kent County Remonumentation Peer Group, monumented by John A. Merdzinski on 12-15-80 and was recorded per LCRC #1747.

B. Description of corner evidence found and/or method applied in restoring or reestablishing corner:

M-4 Found Kent County Monument (Harrison) per witnesses from above LCRC as set by John A. Merdzinski in place of the Dbl. Barrel of Shotgun he found. Said Dbl. Barrel of Shotgun checks with Kent Co. Wit. and LCRC #717.

| | | |
|------------|-------------------------------|-------------------------------------|
| LCRC #1747 | Nail-tag 18" Oak N15°W 85.00' | Nail-tag 6" Tri. Maple N25°E 55.31' |
| | Nail-tag 14" Oak S75°E 61.61' | Nail-tag 14" Oak S75°W 74.60' |
| | Nail-tag 16" Oak S20°E 28.34' | Nail-tag 10" Maple N70°W 48.31' |
| | Nail-tag 18" Oak S45°W 53.18' | N70°W 48.31' |
| LCRC #6040 | Nail-tag 24" Oak N15°W 84.84' | Nail-tag 6" Tri. Maple N25°E 55.24' |
| | Nail-tag 20" Oak S75°E 61.53' | Nail-tag 20" Oak S75°W 74.57' |
| | Nail-tag 20" Oak S50°E 26.71' | Nail-tag 24" Oak S20°E 28.34' |
| | Nail-tag 24" Oak S45°W 53.29' | N70°W 48.38' |

The selected location is accepted by me and is generally accepted by professional surveyors as the best available evidence of the position of the original corner.

C. Description of monument for corner and accessories established to perpetuate locating the position of the corner:

| | | |
|-----------------------------------|--|--------------|
| M-4 Standard Kent County Monument | Nail & KC Remon. tag E. side 26" Oak | N15°W 84.84' |
| | Nail & KC Remon. tag NW side 8" Tri. Maple | N25°E 55.29' |
| | Nail & KC Remon. tag N. side 22" Oak | S75°E 61.56' |
| | Nail & KC Remon. tag N. side 22" Oak | S50°E 26.74' |
| | Nail & KC Remon. tag NE side 26" Oak | S20°E 28.34' |
| | Nail & KC Remon. tag N. side 26" Oak | S45°W 53.29' |
| | Nail & KC Remon. tag N. side 22" Oak | S75°W 74.61' |
| | Nail & KC Remon. tag S. side 14" Maple | N70°W 48.40' |

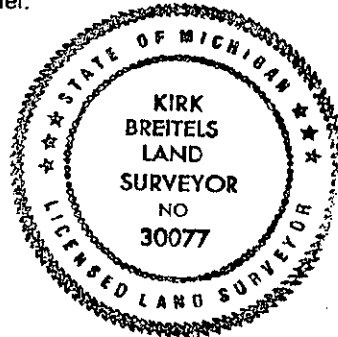

Signed by [Signature]

Date 2/25/99

Surveyor's Michigan License No. 30077

REG. OF DEEDS

STATE OF MICHIGAN
COUNTY OF KENT
RECEIVED FOR RECORD
1999 MAR 24 AM 9:03

11202

Register of Deeds Stamp & File Number

| | | | | | | | | | | | | | |
|----|----|---|----|---|----|---|----|---|----|---|----|---|---|
| | A | B | C | D | E | F | G | H | I | J | K | L | M |
| 1 | | | | | | | | | | | | | |
| 2 | 6 | | 5 | | 4 | | 3 | | 2 | | 1 | | |
| 3 | | | | | | | | | | | | | |
| 4 | 7 | | 8 | | 9 | | 10 | | 11 | | 12 | | |
| 5 | | | | | | | | | | | | | |
| 6 | 18 | | 17 | | 16 | | 15 | | 14 | | 13 | | |
| 7 | | | | | | | | | | | | | |
| 8 | 19 | | 20 | | 21 | | 22 | | 23 | | 24 | | |
| 9 | | | | | | | | | | | | | |
| 10 | 30 | | 29 | | 28 | | 27 | | 26 | | 25 | | |
| 11 | | | | | | | | | | | | | |
| 12 | 31 | | 32 | | 33 | | 34 | | 35 | | 36 | | |
| 13 | | | | | | | | | | | | | |