

SURVEY & REMONUMENTATION

MAY 22 2000 KENT COUNTY REMONUMENTATION

SECTION LAND CORNER RECORDATION CERTIFICATE
 Filing Requirement of Act 74, Mich. P.A. 1970

For corners in

KENT COUNTY
 (County)

Located In:

Corner Code #

1. Public Land Survey

~~T10N R 12W~~ ~~M-12 Tyrone~~
 T___ R___ Common
~~T10N R 11W~~ ~~A-12 Solon~~
 T___ R___

2. Property Controlling in Section

S___ T___ R___

3. Miscellaneous Property in Sec.

S___ T___ R___
 S___ T___ R___

4. Lot No. _____, Recorded Plat _____
 5. Private Claims _____

I, Kirk Breitels, in a field survey on Aug. 20, 1999 do hereby state that under requirements of P.A. 74, Michigan P.A. of 1970, the corner points mentioned in lines 1 and 2 above were in conformance with regulations and rules therefore as required in the current manual of survey instructions of the United States Department of the Interior, Bureau of Land Management or by a decree of a Court of Law and/or that the corner points mentioned in lines 3, 4 and 5 above were in conformance with the rules of the Michigan Board of Land Surveyors or by a Decree of a Court of Law; established, re-established, monumented, recovered, found as expressed below:

NOTE: Not more than 2 corners, all in the same town and range, may be recorded on this certificate.

A. Description of original monument and accessories and/or subsequent restoration:

M-12 1837 GLO Brookfield Set Post
 Williams & Works No information
 1939 Kent Co. Wits Concrete Monument
 8" Poplar SE 9.9' 8" Poplar SW 55.7' 6" Oak WNW 55.1' 3" W. Cherry NE 45.9'

P.A. 345 1999 KENT COUNTY
 PEER APPROVED 8/26/99
 CHAIRMAN Harry J. Huber

B. Description of corner evidence found and/or method applied in restoring or reestablishing corner:

M-12 Found Concrete Monument per the following remaining witnesses:
 C/L Twin 24" Oak WNW 56'
 C/L 8" W. Cherry NE 46'

Concrete Monument is 0.5' West of a straight line and 1.8' South of the midpoint of mile. The C 1/4 corner of Section 31, Solon Twp. is 0.1' N. of a straight line between this Concrete Monument and the E 1/4 corner (Kent Co. Mon.).

The Concrete Monument is accepted by me and is generally accepted by professional surveyors as the best available evidence of the position of the original corner.

C. Description of monument for corner and accessories established to perpetuate locating the position of the corner:

M-12 Concrete Monument with yellow "Kent Co. Remon." cap
 Nail & KC Remon. tag N. side Twin 24" Oak N65°W 56.27'
 Nail & KC Remon. tag SE side 8" W. Cherry N55°E 46.31'
 Nail & KC Remon. tag N. side 16" Maple S40°E 33.31'
 Nail & KC Remon. tag E. side 14" Maple S40°W 35.96'

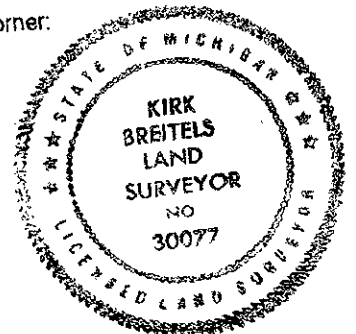

Signed by Kirk Breitels
 Surveyor's Michigan License No. 30077

Date 10/28/99

1999 NOV - 4 AM 8:38
 STATE OF MICHIGAN
 COUNTY OF KENT
 RECEIVED FOR RECORD
 REG. OF DEEDS

11512
 Register of Deeds Stamp & File Number

1	A	B	C	D	E	F	G	H	I	J	K	L	M
2		6		5		4		3		2		1	
3													
4		7		8		9		10		11		12	
5													
6		18		17		16		15		14		13	
7													
8		19		20		21		22		23		24	
9													
10		30		29		28		27		26		25	
11													
12		31		32		33		34		35		36	
13													