

SURVEY & REMONUMENTATION

SEP 18 1995

KENT COUNTY REMONUMENTATION

STATE OF MICHIGAN
COUNTY OF KENT
RECEIVED FOR RECORD

\$7.00 COMMISSION
\$2.00

LAND CORNER RECORDATION CERTIFICATE
Filing Requirement of Act 74, Mich. P.A. 1970

95 MAY 12 AM 10:43

For corners in **KENT COUNTY**

Lucy J. Bond
REG. OF DEEDS

(County)	Located In:	Corner Code #
1. Public Land Survey	T <u>10N</u> R <u>11W</u>	B-1
	T _____ R _____	_____
	T _____ R _____	_____
	T _____ R _____	_____
2. Property Controlling in Section	S _____ T _____ R _____	_____
	S _____ T _____ R _____	_____
3. Miscellaneous Property in Sec.	S _____ T _____ R _____	_____
	S _____ T _____ R _____	_____
4. Lot No. _____, Recorded Plat _____		
5. Private Claims _____		

8356

Register of Deeds Stamp & File Number

	A	B	C	D	E	F	G	H	I	J	K	L	M
2	6	5	4	3	2	1							
3													
4	7	8	9	10	11	12							
5													
6	18	17	16	15	14	13							
7													
8	19	20	21	22	23	24							
9													
10	30	29	28	27	26	25							
11													
12	31	32	33	34	35	36							
13													

I, Kirk Breitels, in a field survey on Feb. 20, 1995, do hereby certify that under requirements of P.A. 74, Michigan P.A. of 1970, the corner points mentioned in lines 1 and 2 above were in conformance with regulations and rules therefore as required in the current manual of survey instructions of the United States Department of the Interior, Bureau of Land Management or by a decree of a Court of Law and/or that the corner points mentioned in lines 3, 4 and 5 above were in conformance with the rules of the Michigan Board of Land Surveyors or by a Decree of a Court of Law; established, re-established, monumented, re-monumented, recovered, found as expressed below:

NOTE: Not more than 4 corners, all in the same town and range, may be recorded on this certificate.

A. Description of original monument and accessories and/or subsequent restoration:

B-1	1837	Not Set
	1911-26 Williams & Works	Stake-Iron
	1985 LCRC #4380	Set Kent County Monument
	1991 LCRC #5736	Reset Kent County Monument
	Ochs	
	Bueche	

The position of this corner was previously approved by the Kent County Remonumentation Peer Group, monumented by Norman L. Ochs on 6/1/85 and was recorded per LCRC #4380.

B. Description of corner evidence found and/or method applied in restoring or reestablishing corner:

B-1 Found standard Kent Co. Mon. (Harrison) per witnesses from above LCRC as set by John C. Bueche at the same location as set in 1985 by Norman L. Ochs on twp. line in place of the 3/4" Iron Pipe and Well Point he found. Both Irons check with Williams & Works information.

LCRC #5736

60d Nail N. side 20" Oak	S75°E	184.85'	(124.54' LCRC #4380)
MBT box	S45°W	63.64'	
60d Nail N. side 10" Cherry	S20°W	69.08'	
Nail S. side fence post	N40°W	76.35'	
SE cor. Sec. 31, Ensley Twp.	West	117.22'	
C/L E-W blacktop - North 4' m/l			

P.A. 345 1990 KENT COUNTY

PEER APPROVED 4/27/95

CHAIRMAN *Harry Huber*

The selected location is accepted by me and is generally accepted by professional surveyors as the best available evidence of the position of the original corner.

C. Description of monument for corner and accessories established to perpetuate locating the position of the corner:

B-1 Standard Kent County Monument			
60d Nail N. side 28" Oak	S75°E	124.85'	
NE cor. MBT box	S45°W	65.40'	
Nail S. side fence post	N40°W	76.51'	
SE cor. Sec. 31, Ensley Twp.	West	117.22'	
NW corner conc. base for elec. box	S05°E	37.02'	
C/L E-W blacktop - North 4' m/l			

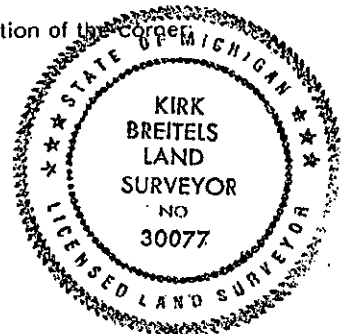

Signed by *Kirk Breitels*

Date 4/20/95

Surveyor's Michigan License No. 30077