

MAY 22 2000

\$7.00  
\$2.00

SECTION

KENT COUNTY REMONUMENTATION

LAND CORNER RECORDATION CERTIFICATE  
Filing Requirement of Act 74, Mich. P.A. 1970

For corners in

KENT COUNTY

(County)

Located In:

Corner Code #

Solon Twp.

1. Public Land Survey

T 10N R 11W

B-4

T R

T R

T R

T R

2. Property Controlling in Section

S T R

S T R

3. Miscellaneous Property in Sec.

S T R

S T R

4. Lot No. \_\_\_\_\_, Recorded Plat \_\_\_\_\_

5. Private Claims \_\_\_\_\_

I, Kirk Breitels, in a field survey on Aug. 9, 1999 do hereby state that under requirements of P.A. 74, Michigan P.A. of 1970, the corner points mentioned in lines 1 and 2 above were in conformance with regulations and rules therefore as required in the current manual of survey instructions of the United States Department of the Interior, Bureau of Land Management or by a decree of a Court of Law and /or that the corner points mentioned in lines 3, 4 and 5 above were in conformance with the rules of the Michigan Board of Land Surveyors or by a Decree of a Court of Law; established, re-established, monumented, recovered, found as expressed below:

NOTE: Not more than 2 corners, all in the same town and range, may be recorded on this certificate.

A. Description of original monument and accessories and/or subsequent restoration:

B-4 1837 GLO Not Set  
Williams & Works No research information  
1937 Kent Co. Wits 1" Iron  
SW cor. tower leg N 231.9' 16" Beech ENE 149.3' 14" Maple WSW 138.3' 6" Maple NW 114.7'  
1990 LCRC #5628 Meyer Monument  
Nail S. side 6" Oak N80°W 70.20' Nail N. side 10" Oak S80°W 130.75'  
Nail S. side Tw. 14" Maple N75°E 86.65' Nail N. side 10" Poplar S70°E 75.80'  
SW corner of tower North 231.2'

P.A. 345 1999 KENT COUNTY

PEER APPROVED 8/26/99  
CHAIRMAN [Signature]

B. Description of corner evidence found and/or method applied in restoring or reestablishing corner:

B-4 Found Concrete Monument (wire style) over a 1" x 12" Iron, per the following remaining witnesses:  
C/L 10" Elm S80°W 131' C/L Tw. 18" Oak N70°E 87'  
Fd. Nail in 10" stump S70°E 75.71' SW corner to tower North 231.2' ±

Said Concrete Monument is 2.2' W. and less than 0.1' N. from intersection of 1/4 lines.

The Concrete Monument is accepted by me and is generally accepted by professional surveyors as the best available evidence of the position of the corner.

C. Description of monument for corner and accessories established to perpetuate locating the position of the corner:

B-4 Set Standard Kent County Monument in place of the Concrete Monument and 1" Iron.  
Set Nail & KC Remon. tag W. side 12" Pine N25°E 118.28' In C/L E-W gravel road ±  
Set Nail & KC Remon. tag S. side Tw. 18" Oak N70°E 86.65'  
Set Nail & KC Remon. tag N. side 12" Poplar S70°E 78.92' N-S fence is 25' West ±  
Set Nail & KC Remon. tag E. side 15" Maple S00°E 161.78'  
Top NW corner of fence post S45°W 35.96'  
Set Nail & KC Remon. tag N. side 15" Elm S80°W 130.86'  
C/L end of single bolt on S. side SW tower leg N00°E 231.45'

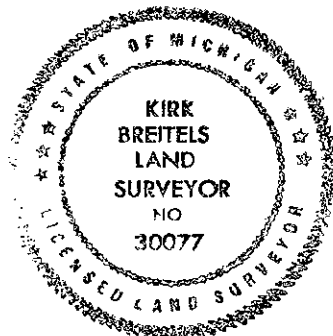

Signed by [Signature]  
Surveyor's Michigan License No. 30077

Date 10/20/99