

**\$7.00** SEP 18 1995  
**\$2.00** COMMISSION

**KENT COUNTY REMONUMENTATION**  
**LAND CORNER RECORDATION CERTIFICATE**  
**Filing Requirement of Act 74, Mich. P.A. 1970**

STATE OF MICHIGAN  
 COUNTY OF KENT  
 RECEIVED FOR RECORD  
 95 MAY 12 AM 10:43

*W. J. Bond*  
 REG. OF DEEDS

For corners in KENT COUNTY (County)

1. Public Land Survey	Located In: T <u>10N</u> R <u>11W</u>	Corner Code # <u>B-9</u>
	T _____ R _____	_____
	T _____ R _____	_____
	T _____ R _____	_____
2. Property Controlling in Section	S _____ T _____ R _____	_____
	S _____ T _____ R _____	_____
3. Miscellaneous Property in Sec.	S _____ T _____ R _____	_____
	S _____ T _____ R _____	_____
4. Lot No. _____, Recorded Plat _____		
5. Private Claims _____		

**8360**  
 Register of Deeds Stamp & File Number

I, Kirk Breitels, in a field survey on Feb. 20, 1995, do hereby certify that under requirements of P.A. 74, Michigan P.A. of 1970, the corner points mentioned in lines 1 and 2 above were in conformance with regulations and rules therefore as required in the current manual of survey instructions of the United States Department of the Interior, Bureau of Land Management or by a decree of a Court of Law and/or that the corner points mentioned in lines 3, 4 and 5 above were in conformance with the rules of the Michigan Board of Land Surveyors or by a Decree of a Court of Law; established, re-established, monumented, re-monumented, recovered, found as expressed below:

A	B	C	D	E	F	G	H	I	J	K	L	M
2	6	5	4	3	2	1						
3												
4	7	8	9	10	11	12						
5												
6	13	17	16	15	14	13						
7												
8	19	20	21	22	23	24						
9	●											
10	30	29	28	27	26	25						
11												
12	31	32	33	34	35	36						

**NOTE: Not more than 4 corners, all in the same town and range, may be recorded on this certificate.**

**A. Description of original monument and accessories and/or subsequent restoration:**

B-9	1837	GLO	Cathcart	Set Post	P.A. 345 1990 KENT COUNTY
		Kent Co. Wit.		Iron	PEER APPROVED <u>4/27/95</u>
	1979	LCRC #1376	VanKooten	1" Pinched Iron	CHAIRMAN <i>Harry Huber</i>
	1980	LCRC #1412	Bissell	1" Pinched Iron	
	1981	LCRC #2118	Jonker	Set Kent County Monument	

The position of this corner was previously approved by the Kent County Remonumentation Peer Group, monumented by Robert J. Jonker on 9/11/81 and was recorded per LCRC #2111

**B. Description of corner evidence found and/or method applied in restoring or reestablishing corner:**

B-9 Found standard Kent Co. Mon. (Harrison) per witnesses from above LCRC as set by Robert J. Jonker in place of the 1" Pinched Iron he found. Said Pinched Iron checks with Kent Co. Wit. and LCRC's #1376 & #1414  
 LCRC #2111

- Remon. tag N. side Tw. 9" Ash N50°W 80.42'
- Remon. tag N. side 10" Ironwood S90°W 54.72'
- C/L power line - East 20' m/l
- East bank Duke Creek - West 72'
- South bank Duke Creek - North 72'
- West bank Duke Creek - East 80'

The selected location is accepted by me and is generally accepted by professional surveyors as the best available evidence of the position of the original corner.

**C. Description of monument for corner and accessories established to perpetuate locating the position of the corner:**

- B-9 Standard Kent County Monument
- New Nail & KC Remon. tag N. side Tw. 12" Ash N50°W 80.45'
- New Nail & KC Remon. tag N. side 14" Ironwood S90°W 54.85'
- Set Nail & KC Remon. tag S. side 14" Pine (7' high) S60°E 106.98'
- Set Nail & KC Remon. tag SE side 12" ASH S45°W 89.84'
- C/L power line - East 20' m/l
- East bank Duke Creek - West 72'
- South bank Duke Creek - North 72'
- West bank Duke Creek - East 80'

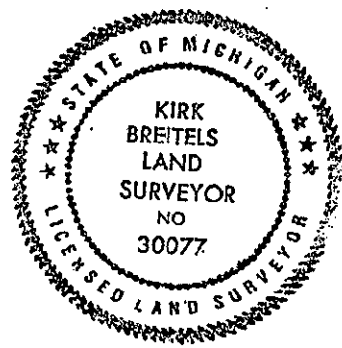

Signed by *Kirk Breitels* Date 4/20/95

Surveyor's Michigan License No. 30077