

**SURVEY &
REMONUMENTATION**

JAY 22 2000

KENT COUNTY REMONUMENTATION

SECTION

**LAND CORNER RECORDATION CERTIFICATE
Filing Requirement of Act 74, Mich. P.A. 1970**

For corners in

KENT COUNTY

(County)

Located In:

Corner Code #

Solon Twp.

B-12

1. Public Land Survey

T 10N R 11W

T R

T R

T R

2. Property Controlling
in Section

S T R

S T R

3. Miscellaneous
Property in Sec.

S T R

S T R

4. Lot No. _____, Recorded Plat _____

5. Private Claims _____

I, Kirk Breitels, in a field survey on Aug. 20, 1999 do hereby state that under requirements of P.A. 74, Michigan P.A. of 1970, the corner points mentioned in lines 1 and 2 above were in conformance with regulations and rules therefore as required in the current manual of survey instructions of the United States Department of the Interior, Bureau of Land Management or by a decree of a Court of Law and /or that the corner points mentioned in lines 3, 4 and 5 above were in conformance with the rules of the Michigan Board of Land Surveyors or by a Decree of a Court of Law; established, re-established, monumented, recovered, found as expressed below:

NOTE: Not more than 2 corners, all in the same town and range, may be recorded on this certificate.

	A	B	C	D	E	F	G	H	I	J	K	L	M
1													
2		6		5		4		3		2		1	
3													
4		7		8		9		10		11		12	
5													
6		13		17		16		15		14		13	
7													
8		19		20		21		22		23		24	
9													
10		30		29		28		27		26		25	
11													
12		31		32		33		34		35		36	
13													

A. Description of original monument and accessories and/or subsequent restoration:

- B-12 1837 GLO Not Set
- 1939 Kent Co. Wits. Concrete Monument
- 8" Elm ENE 25.30' 16" Maple S 26.20' 12" Birch SW 28.60'
- Tw. 8" Oak NW 27.20' SE corner Cottage, WSW 133.5'
- 1941-77 Williams & Works Monument - same witnesses as Kent Co. Wits.
- 1977 LCRC #1051 Merdzinski Concrete Monument
- PK Nail top corner guard post S75°E 54.60' Tw. 10" Oak N35°W 28.10'
- 12" Maple N60°E 39.80' 16" Maple S25°E 3.40'

P.A. 345 1990 KENT COUNTY
PEER APPROVED 8/26/99
CHAIRMAN Harry Huber

B. Description of corner evidence found and/or method applied in restoring or reestablishing corner:

- B-12 Found Concrete Monument per the remaining witnesses:
- C/L Tw. 15" Oak N35°W 29' ± C/L 16" Maple N60°E 40' ± C/L 22" Maple S25°E 3' ±
- PK Nail top of guard post S75°E 54.96'

Said Concrete Monument is 6.9' W. & 0.1' N. from the intersection of 1/4 lines and has been used in surveys by Williams & Works, Hackbardt, and Nederveld.

The Concrete Monument is accepted by me and is generally accepted by professional surveyors as the best available evidence of the position of the corner.

C. Description of monument for corner and accessories established to perpetuate locating the position of the corner:

- B-12 Concrete Monument with yellow "Kent Co. Remon." cap
- PK Nail top of guard post at NW corner parking lot S75°E 54.96'
- Nail & KC Remon. tag W. side Twin 15" Oak N35°W 28.70'
- Nail & KC Remon. tag SE side 16" Maple N60°E 39.88'
- Nail & KC Remon. tag W. side 22" Maple S25°E 3.35'
- Nail & KC Remon. tag S. side 16" Maple S85°W 42.50'

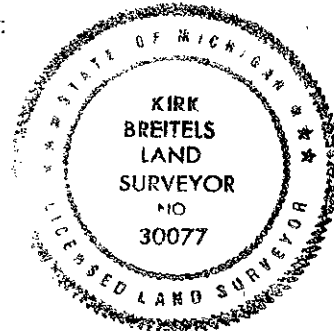

Signed by Kirk Breitels
Surveyor's Michigan License No. 30077

Date 10/28/99