

**SURVEY & REMONUMENTATION**

\$7.00  
\$2.00

MAR 08 1999

KENT COUNTY REMONUMENTATION

STATE OF MICHIGAN  
COUNTY OF KENT  
RECEIVED FOR RECORD

SECTION

LAND CORNER RECORDATION CERTIFICATE  
Filing Requirement of Act 74, Mich. P.A. 1970

98 JUL 14 AM 9:54

For corners in

KENT COUNTY (County)	Located In:	Corner Code #
1. Public Land Survey	T <u>10NR</u> <u>11W</u>	<u>B-13</u>
	T <u>   </u> <u>   </u>	<u>   </u>
	T <u>   </u> <u>   </u>	<u>   </u>
	T <u>   </u> <u>   </u>	<u>   </u>
2. Property Controlling in Section	S <u>   </u> T <u>   </u> R <u>   </u>	<u>   </u>
	S <u>   </u> T <u>   </u> R <u>   </u>	<u>   </u>
3. Miscellaneous Property in Sec.	S <u>   </u> T <u>   </u> R <u>   </u>	<u>   </u>
	S <u>   </u> T <u>   </u> R <u>   </u>	<u>   </u>

*Lucy J. Bond*  
REG. OF DEEDS

10649

Register of Deeds Stamp & File Number

4. Lot No. \_\_\_\_\_, Recorded Plat \_\_\_\_\_  
5. Private Claims \_\_\_\_\_

I, Kirk Breitels, in a field survey on May 12, 19 98 do hereby state that under requirements of P.A. 74, Michigan P.A. of 1970, the corner points mentioned in lines 1 and 2 above were in conformance with regulations and rules therefore as required in the current manual of survey instructions of the United States Department of the Interior, Bureau of Land Management or by a decree of a Court of Law and/or that the corner points mentioned in lines 3, 4 and 5 above were in conformance with the rules of the Michigan Board of Land Surveyors or by a Decree of a Court of Law; established, re-established, monumented, recovered, found as expressed below:

NOTE: Not more than 2 corners, all in the same town and range, may be recorded on this certificate.

1	A	B	C	D	E	F	G	H	I	J	K	L	M
2	6		5		4		3		2		1		
3													
4	7		8		9		10		11		12		
5													
6	18		17		16		15		14		13		
7													
8	19		20		21		22		23		24		
9													
10	30		29		28		27		26		25		
11													
12	31		32		33		34		35		36		
13													

A. Description of original monument and accessories and/or subsequent restoration:

B-13 1837 GLO	Brookfield	Set Post
1939 Kent Co. Wits		Iron
Williams & Works		Iron
1968 Consumers Power		Iron
1996 LCRC #9587	Breitels	Set Kent County Monument

P.A. 345 1990 KENT COUNTY  
PEER APPROVED 6/25/98  
CHAIRMAN *[Signature]*

The position of this corner was previously approved by the Kent County Remonumentation Peer Group, monumented by Kirk Breitels on 12-12-96 and was recorded per LCRC #9587.

B. Description of corner evidence found and/or method applied in restoring or reestablishing corner:

B-13 Found Kent County Monument (Harrison) per witnesses from above LCRC as set by Kirk Breitels in place of the Iron Pipe he found. Said Iron Pipe checks with Kent Co. Wits., Williams & Works and Consumers Power information. LCRC #9587

Nail & Remon. tag N. side 26" Oak	N85°W 38.34'
Nail & Remon. tag E. side 14" Oak	N05°E 24.03'
Nail & Remon. tag N. side 24" Oak	S85°E 43.72'
Nail & Remon. tag NE side 30" Oak	S25°E 11.32'
East edge of lake is West 100' ±	

The selected location is accepted by me and is generally accepted by professional surveyors as the best available evidence of the position of the original corner.

C. Description of monument for corner and accessories established to perpetuate locating the position of the corner:

B-13 Standard Kent County Monument	
Nail & KC Remon. tag N. side 26" Oak	N85°W 38.34'
Nail & KC Remon. tag E. side 14" Oak	N05°E 24.03'
Nail & KC Remon. tag N. side Twin 24" Oak	S85°E 43.76'
Nail & KC Remon. tag NE side 30" Oak	S25°E 11.32'
East edge of lake is West 100' ±	

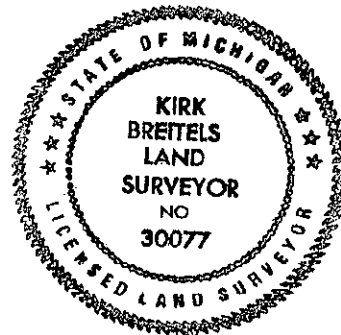

Signed by *[Signature]*  
Surveyor's Michigan License No. 30077

Date 6/25/98