

\$7.00 SEP 18 1995
\$2.00 COMMISSION

KENT COUNTY REMONUMENTATION

STATE OF MICHIGAN
COUNTY OF KENT
RECEIVED FOR RECORD

LAND CORNER RECORDATION CERTIFICATE
Filing Requirement of Act 74, Mich. P.A. 1970

95 MAY 12 AM 10:43

W. J. J. J.
REG. OF DEEDS

For corners in
KENT COUNTY
(County)

	Located In:	Corner Code #
1. Public Land Survey	T <u>10N</u> R <u>11W</u>	<u>C-1</u>
	T _____ R _____	_____
	T _____ R _____	_____
	T _____ R _____	_____
2. Property Controlling in Section	S _____ T _____ R _____	_____
	S _____ T _____ R _____	_____
3. Miscellaneous Property in Sec.	S _____ T _____ R _____	_____
	S _____ T _____ R _____	_____
4. Lot No. _____, Recorded Plat _____		
5. Private Claims _____		

8362

Register of Deeds Stamp & File Number

	A	B	C	D	E	F	G	H	I	J	K	L	M
2	6	5	4	3	2	1							
3													
4	7	8	9	10	11	12							
5													
6	18	17	16	15	14	13							
7													
8	19	20	21	22	23	24							
9													
10	30	29	28	27	26	25							
11													
12	31	32	33	34	35	36							
13													

I, Kirk Breitels, in a field survey on April 19, 1995

do hereby certify that under requirements of P.A. 74, Michigan P.A. of 1970, the corner points mentioned in lines 1 and 2 above were in conformance with regulations and rules therefore as required in the current manual of survey instructions of the United States Department of the Interior, Bureau of Land Management or by a decree of a Court of Law and/or that the corner points mentioned in lines 3, 4 and 5 above were in conformance with the rules of the Michigan Board of Land Surveyors or by a Decree of a Court of Law; established, re-established, monumented, re-monumented, recovered, found as expressed below:

NOTE: Not more than 4 corners, all in the same town and range, may be recorded on this certificate.

A. Description of original monument and accessories and/or subsequent restoration: P.A. 345 1990 KENT COUNTY,

C-1	1837	GLO	Cathcart	Set Post	PEER APPROVED <u>4/27/95</u>
	1935	Kent Co. Wit.		2" Iron	CHAIRMAN <u>F. J. Huber</u>
	1975		Salisbury	Raised 2" Iron w/ 1 1/4" Iron	
	1983	LCRC #3237	Bonnema	Rod with Newaygo Eng. cap	
	1985	LCRC #4381	Ochs	Set Kent County Monument	
	1989		Hackbardt	Set 1/2" Iron per prev. surveys	

The position of this corner was previously approved by the Kent County Remonumentation Peer Group, monumented by Norman L. Ochs on 9/26/85 and was recorded per LCRC #4381

B. Description of corner evidence found and/or method applied in restoring or reestablishing corner:

C-1 Found 1/2" Iron with "GSH" cap per Hackbardt surveys and witnesses (1985-1989) in the same position as the standard Kent Co. Mon. (Harrison) from above LCRC as set in 1985 by Norman L. Ochs in place of the 1 1/4" Iron with 1/2" Iron inside he found. Both Irons checks with Kent Co. Wit. and LCRC #3237. Metal detector indicates another iron approx. 5' below road surface (area has been filled substantially).

LCRC #4381

P. Pole	S55°W	72.20'	PK Nail in N. side
18" B. Oak	N45°E	48.09'	Spk. in E'ly side
8" Tw. Maple	N60°E	43.87'	Spk. N'ly side
S 1/4 cor. 32-11-11 West		43.06'	

Corner is in C/L of E-W grav. rd. and C/L of grav. rd. South Monument is on line with Newaygo County Standard Corners.

The selected location is accepted by me and is generally accepted by professional surveyors as the best available evidence of the position of the original corner.

C. Description of monument for corner and accessories established to perpetuate locating the position of the corner:

C-1 Set Standard Kent County Monument in place of 1/2" iron with "GSH" cap			
PK Nail N. side P. Pole	S55°W	72.26'	
Set Nail & KC Remon. tag S. side 18" Oak	N80°E	108.04'	
Set Nail & KC Remon. tag S. side 10" Beech	N60°E	48.47'	
Set Nail & KC Remon. tag E. side Tw. 18" Beech	N20°E	38.50'	
Set Nail & KC Remon. tag W. side cor. fence post	S25°E	83.85'	
C/L E-W Asph Rd. is South 5' m/l; C/L Grav. Rd. South is West 5' m/l			

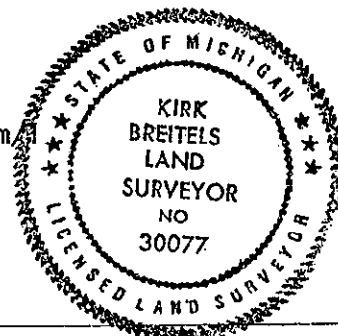

Signed by Kirk Breitels

Date 4/20/95

Surveyor's Michigan License No. 30077