

SURVEY & RECONSTRUCTION

MAY 22 2000

KENT COUNTY REMONUMENTATION

\$7.00
\$2.00

SECTION

LAND CORNER RECORDATION CERTIFICATE
Filing Requirement of Act 74, Mich. P.A. 1970

For corners in

<u>KENT COUNTY</u> (County)	Located in:	Corner Code #
	Solon Twp.	D-8
1. Public Land Survey	T <u>10</u> N R <u>11</u> W	_____
	T _____ R _____	_____
	T _____ R _____	_____
	T _____ R _____	_____
2. Property Controlling in Section	S _____ T _____ R _____	_____
	S _____ T _____ R _____	_____
3. Miscellaneous Property in Sec.	S _____ T _____ R _____	_____
	S _____ T _____ R _____	_____

REG. OF DEEDS

STATE OF MICHIGAN
COUNTY OF KENT
RECEIVED FOR RECORD
1999 DEC 15 AM 8:55

11589

Register of Deeds Stamp & File Number

4. Lot No. _____, Recorded Plat _____
5. Private Claims _____

I, Kirk Breitels, in a field survey on Nov. 10, 19 99 do hereby state that under requirements of P.A. 74, Michigan P.A. of 1970, the corner points mentioned in lines 1 and 2 above were in conformance with regulations and rules therefore as required in the current manual of survey instructions of the United States Department of the Interior, Bureau of Land Management or by a decree of a Court of Law and for that the corner points mentioned in lines 3, 4 and 5 above were in conformance with the rules of the Michigan Board of Land Surveyors or by a Decree of a Court of Law; established, re-established, monumented, recovered, found as expressed below:

NOTE: Not more than 2 corners, all in the same town and range, may be recorded on this certificate.

	A	B	C	D	E	F	G	H	I	J	K	L	M
1													
2	6		5		4		3		2		1		
3													
4	7		8		9		10		11		12		
5													
6	18		17		16		15		14		13		
7													
8	19		20		21		22		23		24		
9													
10	30		29		28		27		26		25		
11													
12	31		32		33		34		35		36		
13													

A. Description of original monument and accessories and/or subsequent restoration:

D-8 1837 GLO Not Set
1895 Williams & Works Found 2 old stakes at Center
Kent Co. Wits Iron
SW cor. hse. NE 96.4' 16" Oak E 31.05' 10" Oak NW 26.6'
1981 LCRC #1418 Hackbardt RR Spike
36" Oak E 30.85' 18" Oak N70°W 26.30' 12" Maple N50°W 44.7'

P.A. 345 1990 KENT COUNTY
PEER APPROVED 10/28/99
CHAIRMAN Harry Huber

B. Description of corner evidence found and/or method applied in restoring or reestablishing corner:

D-8 Found RR Spike over Solid Iron per the remaining witnesses:
SW cor. hse. fnd. NE 96.60' Face of 40" Oak East 30.9'
Face of 20" Oak N70°W 26.1' Cut Nail NE side 18" Maple N50°W 44.63'

Said RR Spike over Solid Iron is less than 0.1' E. and 30.0' S. from intersection of 1/4 lines and has been used in surveys by Hackbardt, Exxel Engineering and Glaza & Assoc. and is on occupation lines East & West ±.

The RR Spike over the Solid Iron is accepted by me and is generally accepted by professional surveyors as the best available evidence of the position of the corner.

C. Description of monument for corner and accessories established to perpetuate locating the position of the corner:

D-8 Set Standard Kent County Monument in Mon .Box in place of the RR Spike and Solid Iron

SW corner house foundation N60°E 96.60'
Nail & KC Remon. tag S. side 40" Oak S85°E 32.37'
Nail & KC Remon. tag W. side 15" Pine S20°E 60.83'
Nail & KC Remon. tag NW side 12" Oak S55°W 34.57'
Nail & KC Remon. tag NE side 20" Oak N70°W 26.68'
Nail & KC Remon. tag NE side 18" Maple N50°W 44.63'

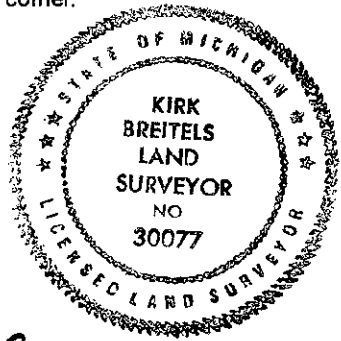

Signed by Kirk Breitels
Surveyor's Michigan License No. 30077

Date 12/6/99