

SEP 18 1995
\$7.00 COMMISSION
\$2.00

KENT COUNTY REMONUMENTATION

STATE OF MICHIGAN
COUNTY OF KENT
RECEIVED FOR RECORD
95 MAY 12 AM 10:45

LAND CORNER RECORDATION CERTIFICATE
Filing Requirement of Act 74, Mich. P.A. 1970

For corners in
KENT COUNTY
(County)

Located In:	Corner Code #
T 10N R 11W	E-12
T _____ R _____	_____
T _____ R _____	_____
T _____ R _____	_____
T _____ R _____	_____
S _____ T _____ R _____	_____
S _____ T _____ R _____	_____
S _____ T _____ R _____	_____
S _____ T _____ R _____	_____

Lucy Bond
REG. OF DEEDS

8392

Register of Deeds Stamp & File Number

- 4. Lot No. _____, Recorded Plat _____
- 5. Private Claims _____

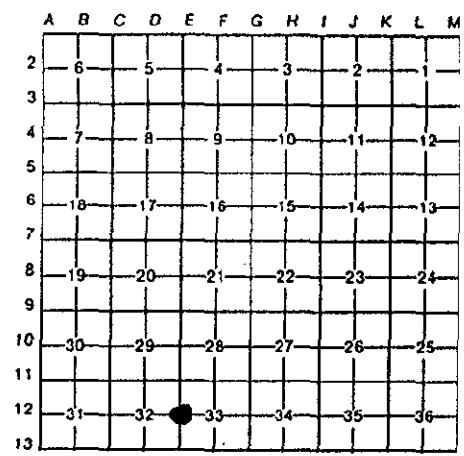

I, Kirk Breitels, in a field survey on Feb. 22, 19 95, do hereby certify that under requirements of P.A. 74, Michigan P.A. of 1970, the corner points mentioned in lines 1 and 2 above were in conformance with regulations and rules therefore as required in the current manual of survey instructions of the United States Department of the Interior, Bureau of Land Management or by a decree of a Court of Law and/or that the corner points mentioned in lines 3, 4 and 5 above were in conformance with the rules of the Michigan Board of Land Surveyors or by a Decree of a Court of Law; established, re-established, monumented, re-monumented, recovered, found as expressed below:

NOTE: Not more than 4 corners, all in the same town and range, may be recorded on this certificate.

A. Description of original monument and accessories and/or subsequent restoration:

E-12	1837	GLO	Cathcart	Set Post
	1973	LCRC #562	VanKooten	Set Capped Iron
	1982	LCRC #2686	Jonker	Set Kent County Monument

The position of this corner was previously approved by the Kent County Remonumentation Peer Group, monumented by Robert J. Jonker on 9/24/81 and was recorded per LCRC #2686.

B. Description of corner evidence found and/or method applied in restoring or reestablishing corner:

E-12 Found standard Kent Co. Mon. (Harrison) per witnesses from above LCRC as set by Robert J. Jonker in place of the Capped Iron he found. Said Capped Iron checks with LCRC #562.

LCRC #2686

Remon. tag S. side	24" dbl. Oak	N90°W	8.46'
Remon. tag E. side	18" Oak	S23°W	28.58'
Remon. tag N. side	10" Oak	S44°E	16.25'
Remon. tag E. side	12" Poplar	N10°W	24.69'
C/L N-S tree & old stump row - West 10' m/l			
E-W wire fence - North 2' m/l			

P.A. 345 1990 KENT COUNTY
PEER APPROVED 4/27/95
CHAIRMAN *Harry Huber*

The selected location is accepted by me and is generally accepted by professional surveyors as the best available evidence of the position of the original corner.

C. Description of monument for corner and accessories established to perpetuate locating the position of the corner:

E-12 Standard Kent County Monument

New Nail & KC Remon. tag S. side	30" dbl. Oak	N90°W	8.52'
New Nail & KC Remon. tag E. side	28" Oak	S23°W	28.53'
New Nail & KC Remon. tag N. side	14" Oak	S44°E	16.23'
Set Nail & KC Remon. tag E. side	18" Poplar	N10°W	30.94'
C/L N-S tree & old stump row - West 10' m/l			
E-W wire fence - North 2' m/l			

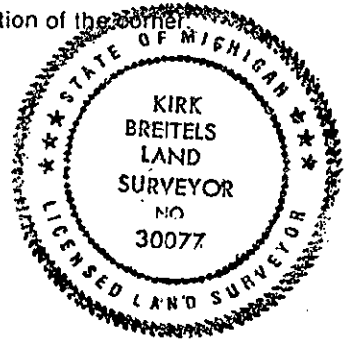

Signed by *Kirk Breitels*
Surveyor's Michigan License No. 30077

Date 4/20/95