

SEP 18 1995
\$7.00
\$2.00 COMMISSION

KENT COUNTY REMONUMENTATION

LAND CORNER RECORDATION CERTIFICATE
Filing Requirement of Act 74, Mich. P.A. 1970

STATE OF MICHIGAN
COUNTY OF KENT
RECEIVED FOR RECORD

95 MAY 12 AM 10:45

Lucy J. Land
REG. OF DEEDS

8393

Register of Deeds Stamp & File Number

For corners in
KENT COUNTY
(County)

	Located In:	Corner Code, #
1. Public Land Survey	T 10N R 11W	E-13
	T _____ R _____	_____
	T _____ R _____	_____
	T _____ R _____	_____
2. Property Controlling in Section	S _____ T _____ R _____	_____
	S _____ T _____ R _____	_____
3. Miscellaneous Property in Sec.	S _____ T _____ R _____	_____
	S _____ T _____ R _____	_____

4. Lot No. _____, Recorded Plat _____
5. Private Claims _____

	A	B	C	D	E	F	G	H	I	J	K	L	M
2	6	5	4	3	2	1							
3													
4	7	8	9	10	11	12							
5													
6	18	17	16	15	14	13							
7													
8	19	20	21	22	23	24							
9													
10	30	29	28	27	26	25							
11													
12	31	32	33	34	35	36							
13													

I, Kirk Breitels, in a field survey on Feb. 22, 19 95, do hereby certify that under requirements of P.A. 74, Michigan P.A. of 1970, the corner points mentioned in lines 1 and 2 above were in conformance with regulations and rules therefore as required in the current manual of survey instructions of the United States Department of the Interior, Bureau of Land Management or by a decree of a Court of Law and/or that the corner points mentioned in lines 3, 4 and 5 above were in conformance with the rules of the Michigan Board of Land Surveyors or by a Decree of a Court of Law; established, re-established, monumented, re-monumented, recovered, found as expressed below:

NOTE: Not more than 4 corners, all in the same town and range, may be recorded on this certificate.

A. Description of original monument and accessories and/or subsequent restoration:

E-13	1837	GLO	Brookfield	Set Post
		Kent Co. Wit.		Stone-Iron
	1973	LCRC #564	VanKooten	1" Iron
	1980	LCRC #1489	Merdzinski	Set Kent County Monument

The position of this corner was previously approved by the Kent County Remonumentation Peer Group, monumented by John A. Merdzinski on 12/1/80 and was recorded per LCRC #1489

B. Description of corner evidence found and/or method applied in restoring or reestablishing corner:

E-13 Found standard Kent Co. Mon. (Harrison) per witnesses from above LCRC as set by John A. Merdzinski in place of the 1" Iron and remains of wood stake he found. Said Iron & stake check with Kent Co. Wit. and LCRC #564.
LCRC #1489

Nail & KC Remon. tag W. side 26" Oak	N08°W	20.88'
Nail & KC Remon. tag W. side 36" Oak	S25°W	27.68'
Nail & KC Remon. tag SW side 8" W. Cherry	S45°E	47.80'
Nail & KC Remon. tag NW side 26" Oak	S75°W	65.40'
Nail & KC Remon. tag S. side 4" Maple	N55°W	56.93'
SW corner conc. porch deck	N60°E	113.08'
C/L Rd. 1.5' South		

P.A. 345 1990 KENT COUNTY
PEER APPROVED 4/27/95
CHAIRMAN *Harry H. ...*

The selected location is accepted by me and is generally accepted by professional surveyors as the best available evidence of the position of the original corner.

C. Description of monument for corner and accessories established to perpetuate locating the position of the corner:

E-13 Standard Kent County Monument		
New Nail & KC Remon. tag W. side 36" Oak	N08°W	20.98'
New Nail & KC Remon. tag W. side 42" Oak	S25°W	27.79'
New Nail & KC Remon. tag SW side 12" W. Cherry clump	S45°E	47.84'
New Nail & KC Remon. tag NW side 36" Oak	S75°W	65.45'
New Nail & KC Remon. tag S. side 14" Maple	N55°W	56.98'
SW corner conc. porch deck	N60°E	113.08'
C/L Rd. 1.5' South		

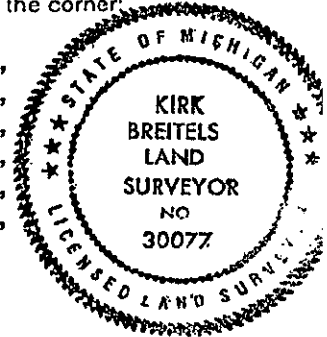

Signed by *Kirk Breitels*

Date 4/20/95

Surveyor's Michigan License No. 30077