

\$7.00
\$2.00

MAY 22 2000

KENT COUNTY REMONUMENTATION

SECTION

LAND CORNER RECORDATION CERTIFICATE
Filing Requirement of Act 74, Mich. P.A. 1970

For corners in

KENT COUNTY
(County)

Located In:

Corner Code #

1. Public Land Survey

T 10N R 11W

Solon Twp.

F-6

T R

T R

T R

2. Property Controlling
in Section

S T R

S T R

3. Miscellaneous
Property in Sec.

S T R

S T R

REG. OF DEEDS

[Signature]

STATE OF MICHIGAN
COUNTY OF KENT
RECEIVED FOR RECORD
1999 NOV -4 AM 8:35

11458

Register of Deeds Stamp & File Number

4. Lot No. _____, Recorded Plat _____

5. Private Claims _____

I, Kirk Breitels, in a field survey on Aug. 10, 1999 do hereby state that under requirements of P.A. 74, Michigan P.A. of 1970, the corner points mentioned in lines 1 and 2 above were in conformance with regulations and rules therefore as required in the current manual of survey instructions of the United States Department of the Interior, Bureau of Land Management or by a decree of a Court of Law and for that the corner points mentioned in lines 3, 4 and 5 above were in conformance with the rules of the Michigan Board of Land Surveyors or by a Decree of a Court of Law; established, re-established, monumented, recovered, found as expressed below:

NOTE: Not more than 2 corners, all in the same town and range, may be recorded on this certificate.

	A	B	C	D	E	F	G	H	I	J	K	L	M
1													
2	6	5	4	3	2	1							
3													
4	7	8	9	10	11	12							
5													
6	19	17	16	15	14	13							
7													
8	19	20	21	22	23	24							
9													
10	30	29	28	27	26	25							
11													
12	31	32	33	34	35	36							
13													

A. Description of original monument and accessories and/or subsequent restoration:

F-6 1837	GLO	Not Set
	Williams & Works	No information
	Kent Co. Wits	No information

P.A. 345 1990 KENT COUNTY
PEER APPROVED 8/26/99
CHAIRMAN *[Signature]*

B. Description of corner evidence found and/or method applied in restoring or reestablishing corner:

F-6 Found Standard Kent County Monument as set in 1995 by Exxel Engineering at the Southwest corner of "VANTAGE POINT" site condominium (set at intersection of 1/4 lines).

Kent County Mon. as found agrees with measurements of Exxel and is 0.1' N. and less than 0.1' W. from intersection of 1/4 lines and is on line with remains of fence to E-W & N.

The Kent County Monument is accepted by me and is generally accepted by professional surveyors as the best available evidence of the position of the corner.

C. Description of monument for corner and accessories established to perpetuate locating the position of the corner:

F-6 Standard Kent County Monument

Nail & KC Remon. tag SE side 14" Elm	N40°E	11.21'
Nail & KC Remon. tag S. side 30" Cherry	N90°W	7.49'
Nail & KC Remon. tag S. side 12" Ash	N90°E	12.25'
Nail & KC Remon. tag E. side 10" Cherry	N00°E	16.26'

On remains of old fence to N & E-W and in line with tree row N.

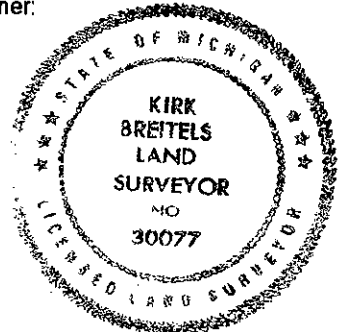

Signed by *[Signature]*
Surveyor's Michigan License No. 30077

Date 10/20/99