

~~\$7.00~~
~~\$2.00~~
 SEP 16 1995
 COMMISSION

KENT COUNTY REMONUMENTATION

STATE OF MICHIGAN
COUNTY OF KENT
RECEIVED FOR RECORD

LAND CORNER RECORDATION CERTIFICATE
Filing Requirement of Act 74, Mich. P.A. 1970

95 MAY 12 AM 10:46

For corners in
KENT COUNTY
(County)

Located In:

Corner Code #

- | | | | | | |
|------------------------------------|---|-----|---|-----|-----|
| 1. Public Land Survey | T | 10N | R | 11W | G-8 |
| | T | | R | | |
| | T | | R | | |
| | T | | R | | |
| 2. Property Controlling in Section | S | | T | | |
| | S | | T | | |
| 3. Miscellaneous Property in Sec. | S | | T | | |
| | S | | T | | |

W. J. Bond
REG. OF DEEDS

8406

Register of Deeds Stamp & File Number

4. Lot No. _____, Recorded Plat _____
5. Private Claims _____

| | | | | | | | | | | | | |
|----|----|----|----|----|----|----|---|---|---|---|---|---|
| A | B | C | D | E | F | G | H | I | J | K | L | M |
| 2 | 6 | 5 | 4 | 3 | 2 | 1 | | | | | | |
| 3 | | | | | | | | | | | | |
| 4 | 7 | 8 | 9 | 10 | 11 | 12 | | | | | | |
| 5 | | | | | | | | | | | | |
| 6 | 18 | 17 | 16 | 15 | 14 | 13 | | | | | | |
| 7 | | | | | | | | | | | | |
| 8 | 19 | 20 | 21 | 22 | 23 | 24 | | | | | | |
| 9 | | | | | | | | | | | | |
| 10 | 30 | 29 | 28 | 27 | 26 | 25 | | | | | | |
| 11 | | | | | | | | | | | | |
| 12 | 31 | 32 | 33 | 34 | 35 | 36 | | | | | | |
| 13 | | | | | | | | | | | | |

I, Kirk Breitels, in a field survey on Feb. 24, 1995, do hereby certify that under requirements of P.A. 74, Michigan P.A. of 1970, the corner points mentioned in lines 1 and 2 above were in conformance with regulations and rules therefore as required in the current manual of survey instructions of the United States Department of the Interior, Bureau of Land Management or by a decree of a Court of Law and/or that the corner points mentioned in lines 3, 4 and 5 above were in conformance with the rules of the Michigan Board of Land Surveyors or by a Decree of a Court of Law; established, re-established, monumented, re-monumented, recovered, found as expressed below:

NOTE: Not more than 4 corners, all in the same town and range, may be recorded on this certificate.

A. Description of original monument and accessories and/or subsequent restoration:

| | | | | |
|-----|------|------------|----------|--------------------------------------|
| G-8 | 1837 | GLO | Cathcart | Set Post |
| | 1973 | LCRC #587 | Spicer | 3/4" Iron in mon. box |
| | 1981 | LCRC #2123 | Jonker | Set Kent County Monument in mon. box |

The position of this corner was previously approved by the Kent County Remonumentation Peer Group, monumented by Robert J. Jonker on 9/15/81 and was recorded per LCRC #2123.

B. Description of corner evidence found and/or method applied in restoring or reestablishing corner:

G-8 Found standard Kent Co. Mon. (Harrison) per witnesses from above LCRC as set by Robert J. Jonker in place of the 3/4" Iron he found inside a mon. box. Said Iron checks with LCRC #587.

LCRC #2123

| | | |
|----------------------------------|-------|---------|
| Remon. tag NW side T. Pole | N65°E | 61.24' |
| Remon. tag NE side P. Pole | S40°E | 127.14' |
| Remon. tag W. side T. Pole | N18°W | 76.22' |
| Remon. tag top corner fence post | N90°W | 33.19' |

On C/L "X"

P.A. 345 1990 KENT COUNTY

PEER APPROVED 4/27/95

CHAIRMAN *[Signature]*

The selected location is accepted by me and is generally accepted by professional surveyors as the best available evidence of the position of the original corner.

C. Description of monument for corner and accessories established to perpetuate locating the position of the corner:

G-8 Standard Kent County Monument

| | | |
|--|-------|---------|
| Nail & KC Remon. tag NE side P. Pole | S40°E | 127.14' |
| Nail & KC Remon. tag W. side T. Pole | N18°W | 76.26' |
| Set Nail & KC Remon. tag N. side 18" Elm | S75°E | 98.28' |

On C/L "X"

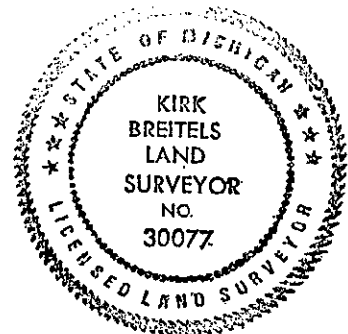

Signed by

Kirk Breitels

Date

4/20/95

Surveyor's Michigan License No. 30077