

\$7.00
\$2.00

MAY 22 2000

KENT COUNTY REMONUMENTATION

SECTION LAND CORNER RECORDATION CERTIFICATE Filing Requirement of Act 74, Mich. P.A. 1970

For corners in
KENT COUNTY
(County)

Located In:	Corner Code #
Solon Twp.	H-5
T 10N R 11W	
T R	
T R	
T R	
S T R	
S T R	
S T R	
S T R	

- 1. Public Land Survey
- 2. Property Controlling in Section
- 3. Miscellaneous Property in Sec.

STATE OF MICHIGAN
COUNTY OF KENT
RECEIVED FOR RECORD

1999 MAR 24 AM 8:00

REG. OF DEEDS

11087

Register of Deeds Stamp & File Number

4. Lot No. _____, Recorded Plat _____
5. Private Claims _____

I, Kirk Breitels, in a field survey on Jan. 21, 1999 do hereby state that under requirements of P.A. 74, Michigan P.A. of 1970, the corner points mentioned in lines 1 and 2 above were in conformance with regulations and rules therefore as required in the current manual of survey instructions of the United States Department of the Interior, Bureau of Land Management or by a decree of a Court of Law and/or that the corner points mentioned in lines 3, 4 and 5 above were in conformance with the rules of the Michigan Board of Land Surveyors or by a Decree of a Court of Law; established, re-established, monumented, recovered, found as expressed below:

A	B	C	D	E	F	G	H	I	J	K	L	M
1												
2	6	5	4	3	2	1						
3												
4	7	8	9	10	11	12						
5												
6	18	17	16	15	14	13						
7												
8	19	20	21	22	23	24						
9												
10	30	29	28	27	26	25						
11												
12	31	32	33	34	35	36						
13												

NOTE: Not more than 2 corners, all in the same town and range, may be recorded on this certificate.

A. Description of original monument and accessories and/or subsequent restoration:

H-5 1837	GLO	Cathcart	Set Post
1901-31	Williams & Works		Gas Pipe
1956	Kent Co. Wits		Iron
1983	LCRC #3683	Bueche	Set Kent County Monument
1990	LCRC #5605	Marschall	Kent County Monument

P.A. 345 1990 KENT COUNTY
PEER APPROVED 2/25/99
CHAIRMAN Harry J. Futera

The position of this corner was previously approved by the Kent County Remonumentation Peer Group, monumented by John C. Bueche on 12-19-83 and was recorded per LCRC #3683.

B. Description of corner evidence found and/or method applied in restoring or reestablishing corner:

H-5 Found Kent County Monument (Harrison) per witnesses from above LCRC as set by John C. Bueche in place of the 1/2" Iron he found. Said Iron checks with Williams & Works information. No Kent Co. Wits remain.	
LCRC #3683	LCRC #5605
Nail & Remon. tag 24" Oak N50°W 37.55'	Nail & Remon. tag 10" Cherry S30°E 16.51'
Nail & Remon. tag 12" Elm N65°E 37.60'	Nail & Remon. tag 8" Oak S20°E 23.56'
Nail & Remon. tag 24" Oak S10°E 28.12'	Nail & Remon. tag 10" Oak S75°W 42.15'
Nail & Remon. tag 8" Cherry S30°E 16.57'	Nail & Remon. tag 6" Oak N60°W 39.72'
Nail & Remon. tag 3-18" Sass. S50°W 32.72'	Top of Bank 10' above lake

The selected location is accepted by me and is generally accepted by professional surveyors as the best available evidence of the position of the original corner.

C. Description of monument for corner and accessories established to perpetuate locating the position of the corner:

H-5 Standard Kent County Monument	
Nail & KC Remon. tag SW side 12" Cherry	S30°E 16.49'
Nail & KC Remon. tag SW side 14" Oak	S20°E 23.56'
Nail & KC Remon. tag S. side 12" Oak	S75°W 42.05'
Nail & KC Remon. tag S. side 12" Oak	N60°W 39.76'
Nail & KC Remon. tag N. side 3-20" Sassafras	S50°W 32.70'
Monument is at E. edge of top of bank ±	
West edge of lake is East 100' ±	

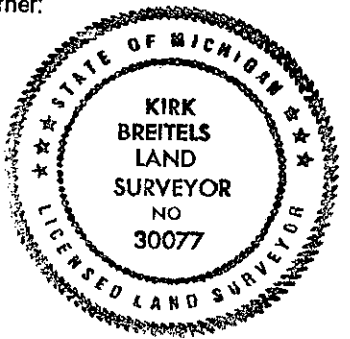

Signed by Kirk Breitels
Surveyor's Michigan License No. 30077

Date 2/25/99