

MAY 22 2000

\$7.00
\$2.00

KENT COUNTY REMONUMENTATION

SECTION

LAND CORNER RECORDATION CERTIFICATE
Filing Requirement of Act 74, Mich. P.A. 1970

For corners in

KENT COUNTY

(County)

Located In:

Corner Code #

Solon Twp.

1. Public Land Survey

T 10NR 11W

H-6

T R

T R

T R

T R

2. Property Controlling in Section

S

T R

S

T R

3. Miscellaneous Property in Sec.

S

T R

S

T R

4. Lot No. _____, Recorded Plat _____

5. Private Claims _____

I, Kirk Breitels, in a field survey on Aug. 30, 1999 do hereby state that under requirements of P.A. 74, Michigan P.A. of 1970, the corner points mentioned in lines 1 and 2 above were in conformance with regulations and rules therefore as required in the current manual of survey instructions of the United States Department of the Interior, Bureau of Land Management or by a decree of a Court of Law and /or that the corner points mentioned in lines 3, 4 and 5 above were in conformance with the rules of the Michigan Board of Land Surveyors or by a Decree of a Court of Law, established, re-established, monumented, recovered, found as expressed below:

NOTE: Not more than 2 corners, all in the same town and range, may be recorded on this certificate.

A. Description of original monument and accessories and/or subsequent restoration:

H-6 1837 GLO Not Set
Williams & Works No information
Kent Co. Wits No information

P.A. 345 1999 KENT COUNTY
PEER APPROVED 9/23/99
CHAIRMAN Harry Huber

B. Description of corner evidence found and/or method applied in restoring or reestablishing corner:

H-6 Found Capped Rerod (Hackbardt) that is 0.3' South and 0.3' West of Intersection of 1/4 lines.

The Capped Rerod (Hackbardt) is accepted by me and is generally accepted by professional surveyors as the best available evidence of the position of the corner.

C. Description of monument for corner and accessories established to perpetuate locating the position of the corner:

H-6 Set Standard Kent County Monument in place of the Capped Rerod (Hackbardt)
Nail & KC Remon. tag N. side 12" Poplar S80°W 27.99'
Nail & KC Remon. tag NE side 27" Oak N55°W 50.92'
Nail & KC Remon. tag W. side 40" Oak N00°E 51.67'
Nail & KC Remon. tag N. side 9" Poplar N65°E 17.42'
Fence corner for fences North and East is 8' North

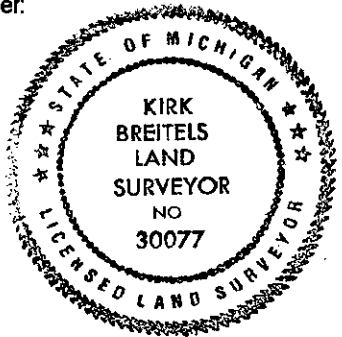

Signed by Kirk Breitels
Surveyor's Michigan License No. 30077

Date 12/15/99

	A	B	C	D	E	F	G	H	I	J	K	L	M
1													
2	6		5		4		3		2		1		
3													
4	7		8		9		10		11		12		
5													
6	18		17		16		15		14		13		
7													
8	19		20		21		22		23		24		
9													
10	30		29		28		27		26		25		
11													
12	31		32		33		34		35		36		
13													