

*SLON
\$200*

MAY 22 2000

KENT COUNTY REMONUMENTATION

SECTION LAND CORNER RECORDATION CERTIFICATE
Filing Requirement of Act 74, Mich. P.A. 1970

For corners in
KENT COUNTY

(County)

Located In:

Corner Code #

Solon Twp.

1. Public Land Survey

T 10 N R 11 W

H-10

T R

T R

T R

T R

2. Property Controlling
in Section

S T R

S T R

3. Miscellaneous
Property in Sec.

S T R

S T R

4. Lot No. _____, Recorded Plat _____

5. Private Claims _____

I, Kirk Breitels, in a field survey on Aug. 20, 1999 do hereby state that under requirements of P.A. 74, Michigan P.A. of 1970, the corner points mentioned in lines 1 and 2 above were in conformance with regulations and rules therefore as required in the current manual of survey instructions of the United States Department of the Interior, Bureau of Land Management or by a decree of a Court of Law and /or that the corner points mentioned in lines 3, 4 and 5 above were in conformance with the rules of the Michigan Board of Land Surveyors or by a Decree of a Court of Law; established, re-established, monumented, recovered, found as expressed below:

NOTE: Not more than 2 corners, all in the same town and range, may be recorded on this certificate.

	A	B	C	D	E	F	G	H	I	J	K	L	M
1													
2	6		5		4		3		2		1		
3													
4	7		8		9		10		11		12		
5													
6	18		17		16		15		14		13		
7													
8	19		20		21		22		23		24		
9													
10	30		29		28		27		26		25		
11													
12	31		32		33		34		35		36		
13													

A. Description of original monument and accessories and/or subsequent restoration:

- H-10 1837 GLO Not Set
- 1898 Williams & Works Set Point at Center - No information on how it was set
- 1973 LCRC #374 Bonnema Found "T" Iron
- 8" Cherry NNE 125.8' 24" Oak SW 168.07' 7" Oak S 39.46' 26" Ash ESE 246.44'
- 1975 LCRC #890 Nederveld Found "T" Iron
- 24" Ash ESE 246.40' 36" Oak SW 168.01' "T" Iron S 32.90'

P.A. 345 1990 KENT COUNTY
PEER APPROVED 8/26/99
CHAIRMAN [Signature]

B. Description of corner evidence found and/or method applied in restoring or reestablishing corner:

- H-10 Found "T" Iron per the following remaining witnesses:
- C/L 42" Ash S80°E 246.0' C/L 60" Oak S50°W 168.0'

Said "T" Iron is 0.1' N. & 0.1' W. of the intersection of 1/4 lines and has also been used in surveys by Williams & Works, Medema & VanKooten, Hackbardt, and Roosien.

The "T" Iron is accepted by me and is generally accepted by professional surveyors as the best available evidence of the position of the corner.

C. Description of monument for corner and accessories established to perpetuate locating the position of the corner:

- H-10 Set Standard Kent County Monument in Mon. Box in place of the "T" Iron
- Nail & KC Remon. tag N. side 42" Ash S80°E 246.02'
- Nail & KC Remon. tag W. side P. Pole S10°E 38.30'
- Nail & KC Remon. tag NW side 60" Oak S50°W 167.90'
- Nail & KC Remon. tag N. side 15" Oak S70°W 111.26'
- Nail & KC Remon. tag E. side Tw. 12" Cherry N15°W 61.60'
- Nail & KC Remon. tag E. side P. Pole N15°E 111.69'

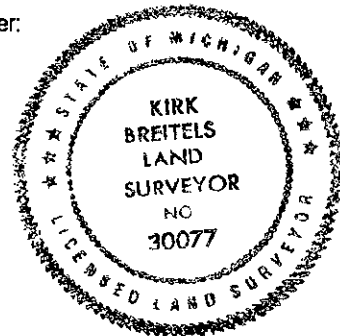

Signed by [Signature]
Surveyor's Michigan License No. 30077

Date 10/28/99