

\$7.00
\$2.00

MAY 22 2000

KENT COUNTY REMONUMENTATION

SECTION LAND CORNER RECORDATION CERTIFICATE Filing Requirement of Act 74, Mich. P.A. 1970

For corners in

KENT COUNTY
(County)

Located In:

Corner Code #

Solon Twp.

- | | | |
|------------------------------------|-----------------------------|------------|
| 1. Public Land Survey | T <u>10</u> N R <u>11</u> W | <u>I-6</u> |
| | T ___ R ___ | _____ |
| | T ___ R ___ | _____ |
| | T ___ R ___ | _____ |
| 2. Property Controlling in Section | S ___ T ___ R ___ | _____ |
| | S ___ T ___ R ___ | _____ |
| 3. Miscellaneous Property in Sec. | S ___ T ___ R ___ | _____ |
| | S ___ T ___ R ___ | _____ |

REG. OF DEEDS

STATE OF MICHIGAN
COUNTY OF KENT
RECEIVED FOR RECORD

1999 JUL -9 AM 11:19

11233

Register of Deeds Stamp & File Number

4. Lot No. _____, Recorded Plat _____
5. Private Claims _____

I, Kirk Breitels, in a field survey on May 10, 19 99 do hereby state that under requirements of P.A. 74, Michigan P.A. of 1970, the corner points mentioned in lines 1 and 2 above were in conformance with regulations and rules therefore as required in the current manual of survey instructions of the United States Department of the Interior, Bureau of Land Management or by a decree of a Court of Law and/or that the corner points mentioned in lines 3, 4 and 5 above were in conformance with the rules of the Michigan Board of Land Surveyors or by a Decree of a Court of Law; established, re-established, monumented, recovered, found as expressed below.

NOTE: Not more than 2 corners, all in the same town and range, may be recorded on this certificate.

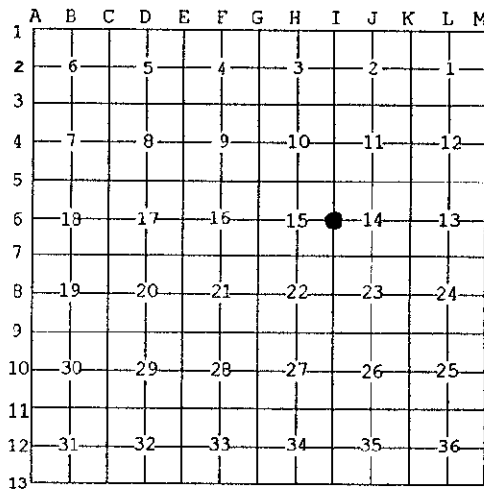

A. Description of original monument and accessories and/or subsequent restoration:

I-6	1837	GLO	Cathcart	Set Post
	1965	Kent Co. Wits		Iron
	1978	LCRC #1154	Reda	1" Solid Iron
	1981	LCRC #2127	Jonker	Set Kent County Monument
	1990	LCRC #5611	Marschall	Kent County Monument

P.A. 345 1990 KENT COUNTY
PEER APPROVED 6/24/97
CHAIRMAN [Signature]

The position of this corner was previously approved by the Kent County Remonumentation Peer Group, monumented by Robert J. Jonker on 9-25-81 and was recorded per LCRC #2127.

B. Description of corner evidence found and/or method applied in restoring or reestablishing corner:

- I-6 Found BROKEN Kent County Monument (Harrison) per witnesses from above LCRC as set by Robert J. Jonker in place of the 1" Solid Iron he found. Said Solid Iron checks with Kent Co. Wits. and LCRC #1154.
- | | | | |
|------------|--|------------|--|
| LCRC #2127 | Nail & Remon. tag 12" Cedar S60°E 25.70' | LCRC #5611 | Nail & Remon. tag 10" Cedar N80°W 41.22' |
| | Nail & Remon. tag 8" Poplar S75°W 30.30' | | Nail & Remon. tag 8" Cedar S25°E 50.19' |
| | Nail & Remon. tag 8" Cedar S22°E 50.22' | | "X" conc. culv. 18" N35°E 29.15' |
| | "X" on W. end road culv. N30°W 29.35' | | "X" conc. culv. 18" N30°W 29.34' |
| | "X" on E. end road culv. N34°E 29.08' | | |
- C/L N-S gravel is East 1'

The selected location is accepted by me and is generally accepted by professional surveyors as the best available evidence of the position of the original corner.

C. Description of monument for corner and accessories established to perpetuate locating the position of the corner:

- I-6 Removed and Reset Standard Kent County Monument
- | | |
|--|--------------|
| Nail & KC Remon. tag S. side 12" Cedar | N80°W 41.19' |
| Nail & KC Remon. tag W. side 10" Cedar | S25°E 50.21' |
| "X" on top 18" conc. culvert | N35°E 29.18' |
| "X" on top 18" conc. culvert | N30°W 29.36' |
- On C/L N-S gravel road ±

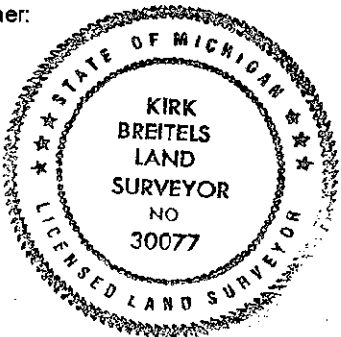

Signed by [Signature]
Surveyor's Michigan License No. 30077

Date 6/24/99