

MAY 22 2000

\$7.00
\$2.00

KENT COUNTY REMONUMENTATION

SECTION

LAND CORNER RECORDATION CERTIFICATE
Filing Requirement of Act 74, Mich. P.A. 1970

For corners in

<u>KENT COUNTY</u> (County)	Located In:	Corner Code #
1. Public Land Survey	T <u>10N</u> R <u>11W</u>	<u>L-11</u> Solon Twp.
	T ___ R ___	_____
	T ___ R ___	_____
	T ___ R ___	_____
2. Property Controlling in Section	S ___ T ___ R ___	_____
	S ___ T ___ R ___	_____
3. Miscellaneous Property in Sec.	S ___ T ___ R ___	_____
	S ___ T ___ R ___	_____

STATE OF MICHIGAN
COUNTY OF KENT
RECEIVED FOR RECORD

1999 NOV -4 AM 8:35

REG. OF DEEDS

[Signature]

11467
Register of Deeds Stamp & File Number

4. Lot No. _____, Recorded Plat _____
5. Private Claims _____

I, Kirk Breitels, in a field survey on Sept. 3, 1999 do hereby state that under requirements of P.A. 74, Michigan P.A. of 1970, the corner points mentioned in lines 1 and 2 above were in conformance with regulations and rules therefore as required in the current manual of survey instructions of the United States Department of the Interior, Bureau of Land Management or by a decree of a Court of Law and /or that the corner points mentioned in lines 3, 4 and 5 above were in conformance with the rules of the Michigan Board of Land Surveyors or by a Decree of a Court of Law; established, re-established, monumented, recovered, found as expressed below:

NOTE: Not more than 2 corners, all in the same town and range, may be recorded on this certificate.

	A	B	C	D	E	F	G	H	I	J	K	L	M
1													
2	6		5		4		3		2		1		
3													
4	7		8		9		10		11		12		
5													
6	18		17		16		15		14		13		
7													
8	19		20		21		22		23		24		
9													
10	30		29		28		27		26		25		
11													
12	31		32		33		34		35		36		
13													

A. Description of original monument and accessories and/or subsequent restoration:

I-11 1837	GLO	Cathcart	Set Post
1966	Kent Co. Wits		1" Iron Pipe
1982	LCRC #3077	Merdzinski	1" Iron in Mon. Box
1983	LCRC #3370	Bueche	Set Kent County Monument in Mon. Box
1990	LCRC #5613	Marschall	Kent County Monument

P.A. 345 1090 KENT COUNTY
PEER APPROVED 9/23/99
CHAIRMAN [Signature]

The position of this corner was previously approved by the Kent County Remonumentation Peer Group, monumented by John C. Bueche on 4-1-83 and was recorded per LCRC #3370.

B. Description of corner evidence found and/or method applied in restoring or reestablishing corner:

I-11 Found Kent County Monument (Harrison) per witnesses from above LCRC as set by John C. Bueche in place of the 1" Iron he found inside a Mon. Box. Said Iron checks with Kent Co. Wits. and LCRC #3077.	
LCRC #3370	LCRC #5613
Nail & Remon. tag Fc. Post N65°E 104.50'	Nail & Remon. tag P. Pole S20°W 47.13'
Nail & MDSH tag P. Pole S20°W 46.90'	Nail & Remon. tag Fence Post S05°E 40.26'
PK Nail Fence Post S05°E 40.18'	SE cor. conc. headwall S25°E 36.15'
SE cor. conc. headwall S25°E 36.42'	NE cor. conc. headwall N35°E 33.40'
NE cor. conc. headwall N35°E 33.39'	Nail & Remon. tag 8" Elm N15°E 51.90'

The selected location is accepted by me and is generally accepted by professional surveyors as the best available evidence of the position of the original corner.

C. Description of monument for corner and accessories established to perpetuate locating the position of the corner:

I-11 Standard Kent County Monument in Mon. Box	
Nail & KC Remon. tag E. side P. Pole	S20°W 47.16'
SE cor. concrete headwall (upper corner)	S25°E 36.38'
NE cor. concrete headwall (upper corner)	N35°E 33.39'
Nail & KC Remon. tag W. side 8" Elm	N15°E 51.92'
Nail & KC Remon. tag E. side 12" Poplar	N00°E 41.69'
Nail & KC Remon. tag SW side clust. Poplars	N50°W 78.78'
In C/L E-W asphalt road ±	

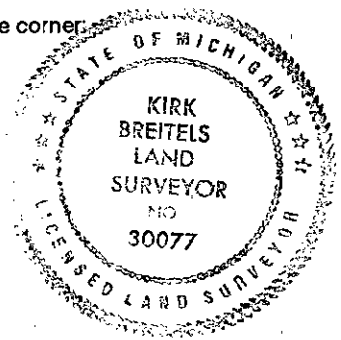

Signed by [Signature]
Surveyor's Michigan License No. 30077

Date 10/28/99