

MAY 22 2000

\$7.00
\$2.00

SECTION

KENT COUNTY REMONUMENTATION

LAND CORNER RECORDATION CERTIFICATE
Filing Requirement of Act 74, Mich. P.A. 1970

STATE OF MICHIGAN
COUNTY OF KENT
RECEIVED FOR RECORD
1999 NOV -4 AM 8:35

REG. OF DEEDS

11469

Register of Deeds Stamp & File Number

For corners in

KENT COUNTY

(County)

Located In:

Corner Code #

1. Public Land Survey

T 10N R 11W

Solon Twp.

T R

J-6

T R

T R

2. Property Controlling in Section

S T R

S T R

3. Miscellaneous Property in Sec.

S T R

S T R

4. Lot No. _____, Recorded Plat _____

5. Private Claims _____

I, Kirk Breitels, in a field survey on Sept. 2, 1999 do hereby state that under requirements of P.A. 74, Michigan P.A. of 1970, the corner points mentioned in lines 1 and 2 above were in conformance with regulations and rules therefore as required in the current manual of survey instructions of the United States Department of the Interior, Bureau of Land Management or by a decree of a Court of Law and/or that the corner points mentioned in lines 3, 4 and 5 above were in conformance with the rules of the Michigan Board of Land Surveyors or by a Decree of a Court of Law; established, re-established, monumented, recovered, found as expressed below:

NOTE: Not more than 2 corners, all in the same town and range, may be recorded on this certificate.

	A	B	C	D	E	F	G	H	I	J	K	L	M
1													
2	6		5		4		3		2		1		
3													
4	7		8		9		10		11		12		
5													
6	18		17		16		15		14		13		
7													
8	19		20		21		22		23		24		
9													
10	30		29		28		27		26		25		
11													
12	31		32		33		34		35		36		
13													

P.A. 345 1990 KENT COUNTY

PEER APPROVED 9/23/99

CHAIRMAN

[Signature]

A. Description of original monument and accessories and/or subsequent restoration:

- J-6 1837 GLO Not Set
- 1964 Williams & Works Set Iron at intersection of 1/4 lines
- 24" Oak ESE 131.25' 20" Maple ENE 128.77' T. Pole South 16.08'
- 1965 Kent Co. Wits. Same as 1964 Williams & Works
- 1974 LCRC #658 Spicer 1 1/2" Iron in Mon. Box
- CP Pole S30°W 110.40' CP Pole N10°E 27.95' 20" Maple N70°W 135.75'

B. Description of corner evidence found and/or method applied in restoring or reestablishing corner:

- J-6 Found 1 1/2" Iron Pipe over top of "T" Iron in Mon. Box per the remaining witnesses:
- PK Nail W. side P. Pole S30°W 110.36' C/L 30" Maple N70°W 136'
- PK Nail E. side P. Pole N10°E 28.02'

Said 1 1/2" Iron Pipe & "T" Iron in Mon. Box is 0.2' S. and 1.0' W. of intersection of 1/4 line and was used in surveys by Williams & Works and Nederveld & Jonker.

The 1 1/2" Iron Pipe over "T" Iron in Mon. Box is accepted by me and is generally accepted by professional surveyors as the best available evidence of the position of the corner.

C. Description of monument for corner and accessories established to perpetuate locating the position of the corner:

- J-6 Set Standard Kent County Monument in Mon. Box in place of the 1 1/2" Iron Pipe and "T" Iron.
- Nail & KC Remon. tag W. side P. Pole S30°W 110.34'
- Nail & KC Remon. tag S. side 30" Maple N70°W 135.58'
- SE corner conc. floor cap of porch N45°W 110.36'
- Nail & KC Remon. tag E. side P. Pole N10°E 28.02'
- Nail & KC Remon. tag NE side 12" Pine S45°E 43.76'

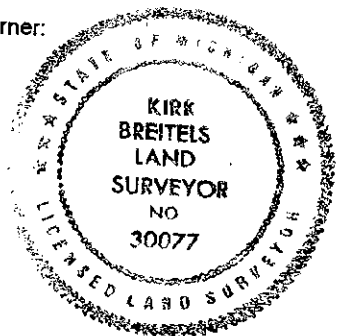

Signed by

[Signature]

Surveyor's Michigan License No. 30077

Date 10/28/99