

\$7.00  
\$2.00

MAY 22 2000

# KENT COUNTY REMONUMENTATION

## SECTION

### LAND CORNER RECORDATION CERTIFICATE Filing Requirement of Act 74, Mich. P.A. 1970

For corners in  
KENT COUNTY

(County)

Located In:

Corner Code #

Solon Twp.

1. Public Land Survey

T 10N R 11W

K-2

T \_\_\_\_\_ R \_\_\_\_\_

T \_\_\_\_\_ R \_\_\_\_\_

T \_\_\_\_\_ R \_\_\_\_\_

T \_\_\_\_\_ R \_\_\_\_\_

2. Property Controlling  
in Section

S \_\_\_\_\_ T \_\_\_\_\_ R \_\_\_\_\_

S \_\_\_\_\_ T \_\_\_\_\_ R \_\_\_\_\_

3. Miscellaneous  
Property in Sec.

S \_\_\_\_\_ T \_\_\_\_\_ R \_\_\_\_\_

S \_\_\_\_\_ T \_\_\_\_\_ R \_\_\_\_\_

REG. OF DEEDS

STATE OF MICHIGAN  
COUNTY OF KENT  
RECEIVED FOR RECORD  
1999 MAR 24 AM 8:08

11102

Register of Deeds Stamp & File Number

4. Lot No. \_\_\_\_\_, Recorded Plat \_\_\_\_\_

5. Private Claims \_\_\_\_\_

I, Kirk Breitel, in a field survey on Jan. 14, 1999 do hereby state that under requirements of P.A. 74, Michigan P.A. of 1970, the corner points mentioned in lines 1 and 2 above were in conformance with regulations and rules therefore as required in the current manual of survey instructions of the United States Department of the Interior, Bureau of Land Management or by a decree of a Court of Law and/or that the corner points mentioned in lines 3, 4 and 5 above were in conformance with the rules of the Michigan Board of Land Surveyors or by a Decree of a Court of Law; established, re-established, monumented, recovered, found as expressed below:

NOTE: Not more than 2 corners, all in the same town and range, may be recorded on this certificate.

A	B	C	D	E	F	G	H	I	J	K	L	M
1												
2	6		5		4		3		2	●	1	
3												
4	7		8		9		10		11		12	
5												
6	18		17		16		15		14		13	
7												
8	19		20		21		22		23		24	
9												
10	30		29		28		27		26		25	
11												
12	31		32		33		34		35		36	
13												

A. Description of original monument and accessories and/or subsequent restoration:

K-2	1837	GLO	Cathcart	Set Post
	1964	Kent Co. Wits		Mon. Box
	1981	LCRC #3564	VanKooten	1" Iron in Mon. Box
	1992	LCRC #6593	Bueche	Set Kent County Monument in Mon. Box

P.A. 345 1990 KENT COUNTY  
PEER APPROVED 2/25/99  
CHAIRMAN [Signature]

The position of this corner was previously approved by the Kent County Remonumentation Peer Group, monumented by John C. Bueche on 10-12-92 and was recorded per LCRC #6593.

B. Description of corner evidence found and/or method applied in restoring or reestablishing corner:

✓ K-2 Found Kent County Monument (Harrison) per witnesses from above LCRC as set by John C. Bueche in place of the 1" Iron he found inside a Mon. Box. Said Iron checks with Kent Co. Wits. & LCRC #3564  
LCRC #6593

Nail & Remon. tag N. side 6" Box Elder	N80°E	27.56'
Nail & Remon. tag W. side 12" Elm	N30°E	37.83'
Nail & Remon. tag S. side 24" Cherry	S85°W	39.46'
Nail & Remon. tag W. side 6" Box Elder	S15°E	89.14'

C/L bit. N-S, West 3' ±

The selected location is accepted by me and is generally accepted by professional surveyors as the best available evidence of the position of the original corner.

C. Description of monument for corner and accessories established to perpetuate locating the position of the corner:

K-2 Standard Kent County Monument

Nail & KC Remon. tag N. side 6" Box Elder	N80°E	27.56'
Nail & KC Remon. tag W. side 15" Elm	N30°E	37.65'
Nail & KC Remon. tag S. side 27" Cherry	S85°W	39.50'
Nail & KC Remon. tag W. side 8" Box Elder	S15°E	89.14'

C/L N-S asphalt road is West 3' ±

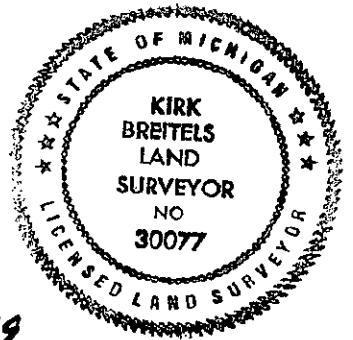

Signed by [Signature]  
Surveyor's Michigan License No. 30077

Date 2/25/99