

\$7.00
\$2.00

MAY 22 2000

KENT COUNTY REMONUMENTATION

SECTION LAND CORNER RECORDATION CERTIFICATE
Filing Requirement of Act 74, Mich. P.A. 1970

REC. OF DEEDS

[Handwritten Signature]

STATE OF MICHIGAN
COUNTY OF KENT
RECEIVED FOR RECORD
1999 MAR 24 AM 8:00

For corners in
KENT COUNTY
(County)

Located In:	Corner Code #
Solon Twp.	K-5
T10N R 11W	
T___ R___	
T___ R___	
T___ R___	
T___ R___	
S___ T___ R___	
S___ T___ R___	
S___ T___ R___	
S___ T___ R___	

- 1. Public Land Survey
- 2. Property Controlling in Section
- 3. Miscellaneous Property in Sec.

11104
Register of Deeds Stamp & File Number

- 4. Lot No. _____, Recorded Plat _____
- 5. Private Claims _____

I, Kirk Breitels, in a field survey on Jan. 12, 1999 do hereby state that under requirements of P.A. 74, Michigan P.A. of 1970, the corner points mentioned in lines 1 and 2 above were in conformance with regulations and rules therefore as required in the current manual of survey instructions of the United States Department of the Interior, Bureau of Land Management or by a decree of a Court of Law and/or that the corner points mentioned in lines 3, 4 and 5 above were in conformance with the rules of the Michigan Board of Land Surveyors or by a Decree of a Court of Law; established, re-established, monumented, recovered, found as expressed below:

NOTE: Not more than 2 corners, all in the same town and range, may be recorded on this certificate.

	A	B	C	D	E	F	G	H	I	J	K	L	M
1													
2	6		5		4		3		2		1		
3													
4	7		8		9		10		11		12		
5													
6	18		17		16		15		14		13		
7													
8	19		20		21		22		23		24		
9													
10	30		29		28		27		26		25		
11													
12	31		32		33		34		35		36		
13													

A. Description of original monument and accessories and/or subsequent restoration:

K-5 1837	GLO	Cathcart	Set Post
1964	Kent Co. Wits		1" Iron & Stone
1977	LCRC #1119	Nederveld	Iron in Mon. Box
1981	LCRC #2177	Jonker	Set Kent County Monument in Mon. Box
1990	LCRC #5586	Marschall	Kent County Monument

P.A. 345 1990 KENT COUNTY
PEER APPROVED 2/25/99
CHAIRMAN [Signature]

The position of this corner was previously approved by the Kent County Remonumentation Peer Group, monumented by Robert J. Jonker on 10-6-81 and was recorded per LCRC #2177.

B. Description of corner evidence found and/or method applied in restoring or reestablishing corner:

- K-5 Found Kent County Monument (Harrison) per witnesses from above LCRC as set by Robert J. Jonker in place of the 3/4" Iron over a 3/4" Iron he found inside a Mon. Box. Both Irons check with LCRC #1119 & Kent Co. Wits.
- LCRC #2177
- LCRC #5586
- Nail & Remon. tag P. & T. Pole S51°W 49.04'
- Nail & Remon. tag T. Pole N23°W 77.34'
- Nail & Remon. tag T. Pole S44°E 46.65'
- Nail & Remon. tag T. Pole N20°E 96.57'
- C/L "X" of B.T. is 1' N & 1 1/2' E. ±
- Nail & Remon. tag Guy Pole S50°E 46.62'
- Nail & Remon. tag P. P. S50°W 49.07'
- Nail & Remon. tag T. P. N25°W 77.32'
- "X" cut S. end 12" culv. S60°W 67.66'

The selected location is accepted by me and is generally accepted by professional surveyors as the best available evidence of the position of the original corner.

C. Description of monument for corner and accessories established to perpetuate locating the position of the corner:

- K-5 Standard Kent County Monument
- Nail & KC Remon. tag NE side Guy Pole S50°E 46.62'
- Nail & KC Remon. tag NW side P. Pole S50°W 49.12'
- Nail & KC Remon. tag SW side Tel. Pole N25°W 77.35'
- "X" cut S. end 12" culvert S60°W 67.72'

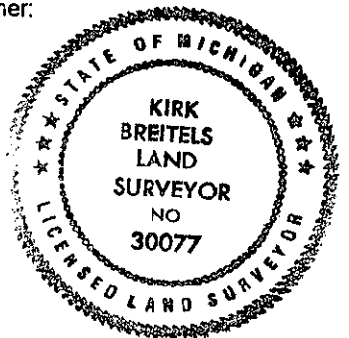

Signed by [Signature]
Surveyor's Michigan License No. 30077

Date 2/25/99