

City of
 MAY 22 2009

\$7.00
 \$2.00

SECTION KENT COUNTY REMONUMENTATION
 LAND CORNER RECORDATION CERTIFICATE
 Filing Requirement of Act 74, Mich. P.A. 1970

STATE OF MICHIGAN
 COUNTY OF KENT
 RECEIVED FOR RECORD
 1999 JUL -9 AM 11:19
 REG. RECORDS

For corners in
 KENT COUNTY
 (County)

Located In: Corner Code #
 Solon Twp.
 K-7

1. Public Land Survey
 T10N R11W
 T___ R___
 T___ R___
 T___ R___
 T___ R___

2. Property Controlling in Section
 S___ T___ R___
 S___ T___ R___
 S___ T___ R___

3. Miscellaneous Property in Sec.
 S___ T___ R___
 S___ T___ R___

4. Lot No. _____, Recorded Plat _____
 5. Private Claims _____

11243
 Register of Deeds Stamp & File Number

I, Kirk Breitels, in a field survey on May 10, 19 99 do hereby state that under requirements of P.A. 74, Michigan P.A. of 1970, the corner points mentioned in lines 1 and 2 above were in conformance with regulations and rules therefore as required in the current manual of survey instructions of the United States Department of the Interior, Bureau of Land Management or by a decree of a Court of Law and /or that the corner points mentioned in lines 3, 4 and 5 above were in conformance with the rules of the Michigan Board of Land Surveyors or by a Decree of a Court of Law, established, re-established, monumented, recovered, found as expressed below:

NOTE: Not more than 2 corners, all in the same town and range, may be recorded on this certificate.

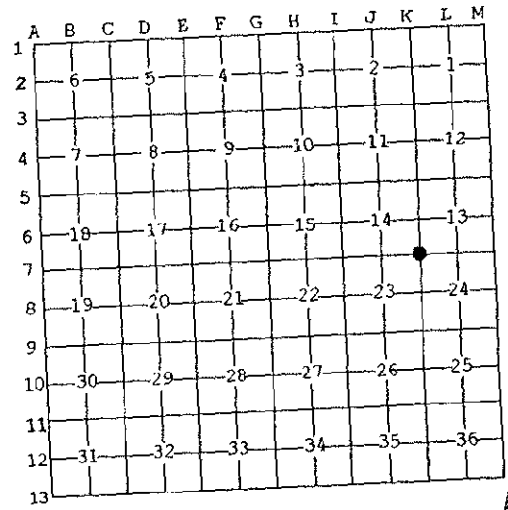

A. Description of original monument and accessories and/or subsequent restoration:

K-7 1837	GLO	Cathcart	Set Post
	Kent Co. Wits		Iron & Stone
1976	LCRC #953	Bonnema	1/2" Iron
1981	LCRC #2178	Jonker	Set Kent County Monument
1990	LCRC #5588	Marschall	Kent County Monument

P.A. 345 1990 KENT COUNTY
 PEER APPROVED 6/24/99
 CHAIRMAN *[Signature]*

The position of this corner was previously approved by the Kent County Remonumentation Peer Group, monumented by Robert J. Jonker on 10-6-81 and was recorded per LCRC #2178.

B. Description of corner evidence found and/or method applied in restoring or reestablishing corner:

K-7 Found Kent County Monument (Harrison) per witnesses from above LCRC as set by Robert J. Jonker in place of the 1/2" Iron he found. Said Iron checks with LCRC #953.

LCRC #2178	Nail & Remon. tag P. Pole	N51°W 56.00'	LCRC #5588	Nail & Remon. tag 22" Maple	N70°W 63.44'
	Nail & Remon. tag T. Pole	S22°W 87.42'		Nail & Remon. tag P. Pole	N45°W 56.03'
	Nail & Remon. tag T. Pole	N47°E 45.28'		Nail & Remon. tag T. Pole	N42°E 45.28'
	Nail & Remon. tag 30" Beech	N77°E 48.12'		Nail & Remon. tag 32" Pine	N25°E 50.72'
	On fence line to East			Nail & Remon. tag Beech	N75°E 48.05'
				Nail & Remon. tag T. Pole	S25°W 87.34'

The selected location is accepted by me and is generally accepted by professional surveyors as the best available evidence of the position of the original corner.

C. Description of monument for corner and accessories established to perpetuate locating the position of the corner:

K-7 Standard Kent County Monument		
Nail & KC Remon. tag N. side 24" Oak	N70°W	63.50'
Nail & KC Remon. tag S. side P. Pole	N45°W	56.05'
Nail & KC Remon. tag E. side 34" Pine	N25°E	50.75'
Nail & KC Remon. tag S. side 24" Beech	N75°E	48.07'
C/L N-S road is West 8' ±		

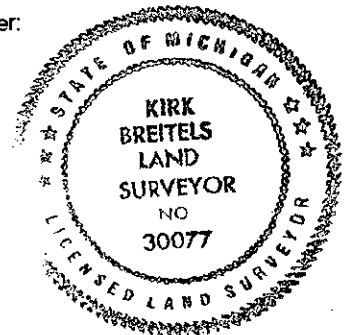

Signed by *[Signature]*
 Surveyor's Michigan License No. 30077

Date 6/24/99