

JUL 22 2000

KENT COUNTY REMONUMENTATION

LAND CORNER RECORDATION CERTIFICATE  
Filing Requirement of Act 74, Mich. P.A. 1970

SECTION

\$7.00  
\$2.00

For corners in  
KENT COUNTY

Located In:	Corner Code #
Solon Twp.	
T 10N R 11W	K-9
T R	
T R	
T R	
T R	
S T R	
S T R	
S T R	
S T R	

1. Public Land Survey

2. Property Controlling  
in Section

3. Miscellaneous  
Property in Sec.

4. Lot No. \_\_\_\_\_, Recorded Plat \_\_\_\_\_  
5. Private Claims \_\_\_\_\_

STATE OF MICHIGAN  
COUNTY OF KENT  
RECEIVED FOR RECORD

1999 JUL -9 AM 11:19

11245

Register of Deeds Stamp & File Number

1	A	B	C	D	E	F	G	H	I	J	K	L	M
2	6		5		4		3		2		1		
3													
4	7		8		9		10		11		12		
5													
6	10		17		16		15		14		13		
7													
8	19		20		21		22		23		24		
9													
10	30		29		28		27		26		25		
11													
12	31		32		33		34		35		36		
13													

I, Kirk Breitels, in a field survey on May 10, 19 99 do hereby state that under requirements of P.A. 74, Michigan P.A. of 1970, the corner points mentioned in lines 1 and 2 above were in conformance with regulations and rules therefore as required in the current manual of survey instructions of the United States Department of the Interior, Bureau of Land Management or by a decree of a Court of Law and /or that the corner points mentioned in lines 3, 4 and 5 above were in conformance with the rules of the Michigan Board of Land Surveyors or by a Decree of a Court of Law; established, re-established, monumented, recovered, found as expressed below:

NOTE: Not more than 2 corners, all in the same town and range, may be recorded on this certificate.

A. Description of original monument and accessories and/or subsequent restoration:

K-9 1837	GLO	Cathcart	Set Post
1966	Kent Co. Wits		1/2" Iron
1976	LCRC #953	Bonnema	1/2" Iron in Mon. Box
1981	LCRC #2171	Jonker	Set Kent County Monument in Mon. Box
1990	LCRC #5617	Marschall	Kent County Monument

P.A. 345 1990 KENT COUNTY  
PEER APPROVED 6/24/99  
CHAIRMAN [Signature]

The position of this corner was previously approved by the Kent County Remonumentation Peer Group, monumented by Robert J. Jonker on 10-1-81 and was recorded per LCRC #2171.

B. Description of corner evidence found and/or method applied in restoring or reestablishing corner:

K-9 Found Kent County Monument (Harrison) per witnesses from above LCRC as set by Robert J. Jonker in place of the 1/2" Iron found inside a Mon. Box. Said Iron checks with Kent Co. Wit. and LCRC #2171.  
LCRC #2171  
Nail & Remon. tag Maple clump S26°E 29.54'  
Nail & Remon. tag P. Pole N42°W 84.15'  
Nail & Remon. tag 9" Twin Elm S28°W 81.90'  
Nail & MSIH tag 36" Pine S70°E 15.36'  
C/L B.T. 7.7' W. & 7' N.  
LCRC #5617  
Nail & Remon. tag 36" Pine S80°E 15.32'  
Nail & Remon. tag 10" Cherry N75°E 34.47'  
Nail & Remon. tag P. Pole N58°E 43.73'  
Nail & Remon. tag P. Pole N45°W 84.17'

The selected location is accepted by me and is generally accepted by professional surveyors as the best available evidence of the position of the original corner.

C. Description of monument for corner and accessories established to perpetuate locating the position of the corner:

K-9 Standard Kent County Monument	
Nail & KC Remon. tag N. side 12" Cherry	N75°E 34.64'
Nail & KC Remon. tag S. side P. Pole	N58°E 43.73'
Nail & KC Remon. tag S. side P. Pole	N45°W 84.22'
Nail & KC Remon. tag NE side Maple clump	S25°E 28.32'
N-S road is 8' West - C/L road West is 7' North	

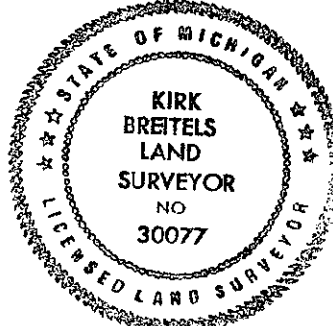

Signed by [Signature]  
Surveyor's Michigan License No. 30077

Date 6/24/99