

SURVEY & REMONUMENTATION

\$7.00
\$2.00

MAR 08 1999

KENT COUNTY REMONUMENTATION

SECTION

LAND CORNER RECORDATION CERTIFICATE
Filing Requirement of Act 74, Mich. P.A. 1970

For corners in

KENT COUNTY

(County)

Located In:

Corner Code #

1. Public Land Survey

T10N R11W

L-13

T R

T R

T R

T R

T R

T R

T R

2. Property Controlling in Section

S

3. Miscellaneous Property in Sec.

S

S

S

S

4. Lot No. _____, Recorded Plat _____

5. Private Claims _____

STATE OF MICHIGAN
COUNTY OF KENT
RECEIVED FOR RECORD

98 MAR -5 AM 8:35

REG. OF DEEDS

David J. Stuber

10590

Register of Deeds Stamp & File Number

I, Kirk Breitels, in a field survey on Jan. 2, 1998 do hereby state that under requirements of P.A. 74, Michigan P.A. of 1970, the corner points mentioned in lines 1 and 2 above were in conformance with regulations and rules therefore as required in the current manual of survey instructions of the United States Department of the Interior, Bureau of Land Management or by a decree of a Court of Law and/or that the corner points mentioned in lines 3, 4 and 5 above were in conformance with the rules of the Michigan Board of Land Surveyors or by a Decree of a Court of Law; established, re-established, monumented, recovered, found as expressed below.

NOTE: Not more than 2 corners, all in the same town and range, may be recorded on this certificate.

A	B	C	D	E	F	G	H	I	J	K	L	M
1												
2	6		5		4		3		2		1	
3												
4	7		8		9		10		11		12	
5												
6	19		17		15		14		13			
7												
8	19		20		21		22		23		24	
9												
10	30		29		28		27		26		25	
11												
12	31		32		33		34		35		36	
13												

A. Description of original monument and accessories and/or subsequent restoration:

L-13 1837 GLO Brookfield Set Post
1949 Williams & Works Set Iron on line between SW & SE cor. of Sec. 36,
17.2' West of L-1, T9N, R11W.
1966 MDSH Spencer 1/2" Iron 16.93' West of L-1, T9N, R11W
1995 LCRC #8543 Breitels Set Kent County Monument

The position of this corner was previously approved by the Kent County Remonumentation Peer Group, monumented by Kirk Breitels on 8-7-95 and was recorded per LCRC #8543.

B. Description of corner evidence found and/or method applied in restoring or reestablishing corner:

L-13 Found Kent County Monument (Harrison) per witnesses from above LCRC as set by Kirk Breitels in place of the PK Nail he found. Said PK Nail checks with Williams & Works and MDSH information.
LCRC #8543

Nail & KC Remon. tag W. side wood fence post S05°E 38.97'
Nail & KC Remon. tag S. side wood fence post N65°E 69.03'
Nail & KC Remon. tag E. side 24" Oak N00°W 62.04'
Nail & KC Remon. tag S. side 30" Oak N65°W 81.06'
Kent Co. Mon. (L-1, T9N, R11W) East 16.92'

P.A. 345 1990 KENT COUNTY
PEER APPROVED 2/19/98
CHAIRMAN *Harry Stuber*

The selected location is accepted by me and is generally accepted by professional surveyors as the best available evidence of the position of the original corner.

C. Description of monument for corner and accessories established to perpetuate locating the position of the corner:

L-13 Standard Kent County Monument
Nail & KC Remon. tag W. side wood fence post S05°E 38.97'
Nail & KC Remon. tag S. side wood fence post N65°E 69.03'
Nail & KC Remon. tag E. side 24" Oak N00°W 62.04'
Nail & KC Remon. tag S. side 30" Oak N65°W 81.06'
Kent Co. Mon. (L-1, T9N, R11W) East 16.92'

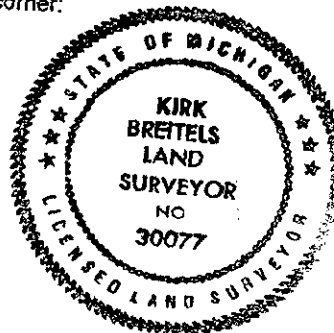

Signed by *Kirk Breitels*
Surveyor's Michigan License No. 30077

Date 2/19/98