

\$7.00  
\$2.00

JUN 22 2000

KENT COUNTY REMONUMENTATION

LAND CORNER RECORDATION CERTIFICATE  
Filing Requirement of Act 74, Mich. P.A. 1970

STATE OF MICHIGAN  
COUNTY OF KENT  
RECEIVED FOR RECORD  
1999 JUL -9 AM 11:19

For corners in

SECTION

<u>KENT COUNTY</u> (County)	Located In:	Corner Code #
1. Public Land Survey	T <u>10N</u> R <u>11W</u>	<u>M-8 Solon</u>
	T <u>   </u> R <u>   </u>	<u>Common</u>
	T <u>10N</u> R <u>10W</u>	<u>A-8 Nelson</u>
	T <u>   </u> R <u>   </u>	<u>   </u>
2. Property Controlling in Section	S <u>   </u> T <u>   </u> R <u>   </u>	<u>   </u>
	S <u>   </u> T <u>   </u> R <u>   </u>	<u>   </u>
3. Miscellaneous Property in Sec.	S <u>   </u> T <u>   </u> R <u>   </u>	<u>   </u>
	S <u>   </u> T <u>   </u> R <u>   </u>	<u>   </u>

REC'D

11247

Register of Deeds Stamp & File Number

4. Lot No. \_\_\_\_\_, Recorded Plat \_\_\_\_\_  
5. Private Claims \_\_\_\_\_

I, Kirk Breitels, in a field survey on May 17, 19 99 do hereby state that under requirements of P.A. 74, Michigan P.A. of 1970, the corner points mentioned in lines 1 and 2 above were in conformance with regulations and rules therefore as required in the current manual of survey instructions of the United States Department of the Interior, Bureau of Land Management or by a decree of a Court of Law and /or that the corner points mentioned in lines 3, 4 and 5 above were in conformance with the rules of the Michigan Board of Land Surveyors or by a Decree of a Court of Law; established, re-established, monumented, recovered, found as expressed below:

NOTE: Not more than 2 corners, all in the same town and range, may be recorded on this certificate.

1	A	B	C	D	E	F	G	H	I	J	K	L	M
2	6		5		4		3		2		1		
3													
4	7		8		9		10		11		12		
5													
6	18		17		16		15		14		13		
7													
8	19		20		21		22		23		24		
9													
10	30		29		28		27		26		25		
11													
12	31		32		33		34		35		36		
13													

A. Description of original monument and accessories and/or subsequent restoration:

M-8 1837	GLO	Brookfield	Set Post
1966	Kent Co. Wits		1" Iron
1973	LCRC #489	Spicer	Boat Spike
1982	LCRC #3123	Merdzinski	Set Kent County Monument
1990	LCRC #5596	Marschall	Kent County Monument

P.A. 345 1990 KENT COUNTY  
PEER APPROVED 6/24/99  
CHAIRMAN Henry Huber

The position of this corner was previously approved by the Kent County Remonumentation Peer Group, monumented by John A. Merdzinski on 10-18-82 and was recorded per LCRC #3123.

B. Description of corner evidence found and/or method applied in restoring or reestablishing corner:

M-8 Found Kent County Monument (Harrison) per witnesses from above LCRC as set by John A. Merdzinski in place of the Boat Spike over a 60d Nail over a 1" Square Iron he found. All check with Kent Co. Wit. and LCRC #489.	
LCRC #3123	LCRC #5596
Nail & Remon. tag P. Pole N60°W 97.33'	Nail & Remon. tag P. Pole N60°W 97.37'
Nail & Remon. tag Elec. Pole N90°W 76.90'	Nail & Remon. tag Elec. Pole N90°W 76.80'
Face of 3" Steel Mail Box Post S80°E 15.45'	Top C/L 4" De-watering pump S73°W 66.17'
C/L blacktop road is 2' West of corner	2" Steel gate post, C/L base N85°W 45.50'
C/L driveway running West is 15' North	

The selected location is accepted by me and is generally accepted by professional surveyors as the best available evidence of the position of the original corner.

C. Description of monument for corner and accessories established to perpetuate locating the position of the corner:

M-8 Standard Kent County Monument	
Nail & KC Remon. tag NE side P. Pole	S60°W 97.42'
Nail & KC Remon. tag N. side Elec. Scr. Pole	N90°W 76.80'
Top C/L 4" De-watering pump	S73°W 66.17'
Face Steel Mail Box Post - at grade	S75°E 16.65'
C/L blacktop road is 2' West of corner	
C/L driveway to West is 15' North	

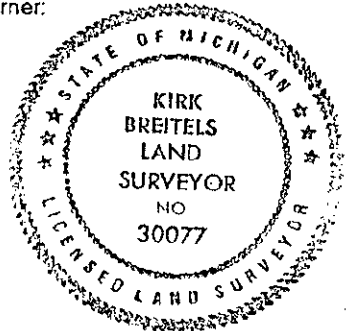

Signed by Kirk Breitels  
Surveyor's Michigan License No. 30077

Date 6/24/99