

\$7.00
\$2.00

MAY 22 2000

KENT COUNTY REMONUMENTATION

LAND CORNER RECORDATION CERTIFICATE
Filing Requirement of Act 74, Mich. P.A. 1970

"other" code # 10

For corners in
KENT COUNTY
(County)

Located In: Corner Code #

- 1. Public Land Survey T ___ R ___
T ___ R ___
T ___ R ___
T ___ R ___
- 2. Property Controlling S 32 T 10NR 11W Wit. Mon. on
in Section S ___ T ___ R ___ E-W 1/4 Line
- 3. Miscellaneous S ___ T ___ R ___ (Solon Twp.)
Property in Sec. S ___ T ___ R ___

STATE OF MICHIGAN
COUNTY OF KENT
RECEIVED FOR RECORD

1999 DEC 17 AM 8:01

REG. OF DEEDS

11619

Register of Deeds Stamp & File Number

- 4. Lot No. _____, Recorded Plat _____
- 5. Private Claims _____

I, Kirk Breitels, in a field survey on Oct. 20, 19 99 do hereby state that under requirements of P.A. 74, Michigan P.A. of 1970, the corner points mentioned in lines 1 and 2 above were in conformance with regulations and rules therefore as required in the current manual of survey instructions of the United States Department of the Interior, Bureau of Land Management or by a decree of a Court of Law and/or that the corner points mentioned in lines 3, 4 and 5 above were in conformance with the rules of the Michigan Board of Land Surveyors or by a Decree of a Court of Law; established, re-established, monumented, recovered, found as expressed below:

NOTE: Not more than 2 corners, all in the same town and range, may be recorded on this certificate.

	A	B	C	D	E	F	G	H	I	J	K	L	M
1													
2	6		5		4		3		2		1		
3													
4	7		8		9		10		11		12		
5													
6	18		17		16		15		14		13		
7													
8	19		20		21		22		23		24		
9													
10	30		29		28		27		26		25		
11													
12	31		32		33		34		35		36		
13													

A. Description of original monument and accessories and/or subsequent restoration:

- 1973 VanKooten Shows SE corner SW 1/4 NE 1/4 Sec. 32 - 1316.94' West of E 1/4 corner
- 1995 Roosien Iron at "Historical Corner" - SE corner SW 1/4 NE 1/4 - 1316.62' West of E 1/4 and 1317.81' East of computed C 1/4 corner.

P.A. 345 1990 KENT COUNTY
PEER APPROVED 10/25/99
CHAIRMAN [Signature]

B. Description of corner evidence found and/or method applied in restoring or reestablishing corner:

Found Iron at "Historical Corner" per Roosien surveys that also fits other survey Irons by others. Iron is also on E-W 1/4 line as computed $\pm 0.1'$.

- 1316.76' to E 1/4 corner (1316.62' Roosien - 1316.94' VanKooten)
- 1317.63' to C 1/4 corner - computed (1317.81' Roosien)

The Iron as found is accepted by me and is generally accepted by professional surveyors as the best available evidence of the position of the Witness Corner.

C. Description of monument for corner and accessories established to perpetuate locating the position of the corner:

- Set Kent County Witness Monument in Mon. Box on computed E-W 1/4 line in place of the Iron found
- Nail & KC Remon. tag W. side P. Pole S10°E 183.58'
- Nail & KC Remon. tag E. side P. Pole S25°W 194.16'
- Nail & KC Remon. tag NE side P. Pole N55°W 96.38'
- Nail & KC Remon. tag E. side P. Pole N25°W 174.51'
- Capped Rerod (Feenstra) S45°E 44.65'
- On C/L N-S asphalt road \pm

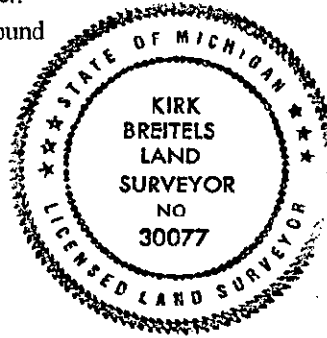

Signed by [Signature]
Surveyor's Michigan License No. 30077

Date 12/15/99