

SURVEY & REMONUMENTATION

\$7.00
\$2.00

MAY 22 2000

KENT COUNTY REMONUMENTATION

SECTION

LAND CORNER RECORDATION CERTIFICATE
Filing Requirement of Act 74, Mich. P.A. 1970

For corners in

KENT COUNTY
(County)

Located In:

Corner Code #

Tyrone Twp.

1. Public Land Survey

T 10 N R 12 W

A-5

T _____ R _____

T _____ R _____

T _____ R _____

2. Property Controlling in Section

S _____

T _____ R _____

S _____

T _____ R _____

3. Miscellaneous Property in Sec.

S _____

T _____ R _____

S _____

T _____ R _____

4. Lot No. _____, Recorded Plat _____

5. Private Claims _____

I, Kirk Breitels, in a field survey on Sept. 20, 19 99 do hereby state that under requirements of P.A. 74, Michigan P.A. of 1970, the corner points mentioned in lines 1 and 2 above were in conformance with regulations and rules therefore as required in the current manual of survey instructions of the United States Department of the Interior, Bureau of Land Management or by a decree of a Court of Law and /or that the corner points mentioned in lines 3, 4 and 5 above were in conformance with the rules of the Michigan Board of Land Surveyors or by a Decree of a Court of Law; established, re-established, monumented, recovered, found as expressed below:

NOTE: Not more than 2 corners, all in the same town and range, may be recorded on this certificate.

A. Description of original monument and accessories and/or subsequent restoration:

A-5 1837	GLO	Brookfield	Set Post
	Kent Co. Wits		No information
1981	LCRC #2067	Nederveld	3/4" Iron in Mon. Box
1983	LCRC #3240	Byl	Set Kent County Monument in Mon. Box
1994	LCRC #7514	J. Glaza	Kent County Monument

P.A. 345 1990 KENT COUNTY
PEER APPROVED 9/23/99
CHAIRMAN [Signature]

The position of this corner was previously approved by the Kent County Remonumentation Peer Group, monumented by William R. Byl on 3-21-83 and was recorded per LCRC #3240.

B. Description of corner evidence found and/or method applied in restoring or reestablishing corner:

A-5 Found Kent County Monument (Harrison) per witnesses from above LCRC as set by William R. Byl in place of the 3/4" Iron Pipe he found inside a Mon. Box. Said Iron Pipe checks with Kent Co. Wits, and LCRC #2067.

LCRC #3240	Nail & Remon. tag P. Pole	N60°W 67.30'	LCRC #7514	Nail & Remon. tag P. Pole	N60°W 67.30'
	Nail & Remon. tag 24" Maple	N50°E 69.20'		Nail & Remon. tag 24" Maple	N50°E 69.20'
	NW cor. brick. veneer House	S45°E 106.52'		NW corner brick veneer house	S45°E 106.55'
	NE corner barn foundation	S40°W 135.4'		NE corner barn foundation	S40°W 135.49'

The selected location is accepted by me and is generally accepted by professional surveyors as the best available evidence of the position of the original corner.

C. Description of monument for corner and accessories established to perpetuate locating the position of the corner:

A-5 Standard Kent County Monument			
Nail & KC Remon. tag S. side P. Pole	N60°W	67.35'	
Nail & KC Remon. tag S. side 27" Maple	N50°E	69.17'	
NW corner brick veneer house 16392	S45°E	106.51'	
NE corner barn foundation	S40°W	135.44'	

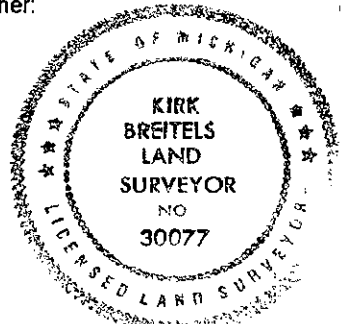

Signed by [Signature]
Surveyor's Michigan License No. 30077

Date 10/20/99

1999 NOV -4 AM 8:37
STATE OF MICHIGAN
COUNTY OF KENT
RECEIVED FOR RECORD
REG. OF DEEDS
[Signature]
11484
Register of Deeds Stamp & File Number

	A	B	C	D	E	F	G	H	I	J	K	L	M
1													
2	6		5		4		3		2		1		
3													
4	7		8		9		10		11		12		
5													
6	18		17		16		15		14		13		
7													
8	19		20		21		22		23		24		
9													
10	30		29		28		27		26		25		
11													
12	31		32		33		34		35		36		
13													