

MAY 22 2000 KENT COUNTY REMONUMENTATION

SECTION LAND CORNER RECORDATION CERTIFICATE
Filing Requirement of Act 74, Mich. P.A. 1970

STATE OF MICHIGAN
COUNTY OF KENT
RECEIVED FOR RECORD
1999 MAR 24 AM 9:00

REG. OF DEEDS

[Signature]

11124

Register of Deeds Stamp & File Number

For corners in

KENT COUNTY

(County)

Located In:

Corner Code #

Tyrone Twp.

1. Public Land Survey

T 10N R 12W

A-11

T R

T R

T R

T R

2. Property Controlling
in Section

S T R

S T R

3. Miscellaneous
Property in Sec.

S T R

S T R

4. Lot No. _____, Recorded Plat _____

5. Private Claims _____

	A	B	C	D	E	F	G	H	I	J	K	L	M
1													
2	6		5		4		3		2		1		
3													
4	7		8		9		10		11		12		
5													
6	13		17		16		15		14		13		
7													
8	19		20		21		22		23		24		
9													
10	30		29		28		27		26		25		
11													
12	31		32		33		34		35		36		
13													

I, Kirk Breitels, in a field survey on Feb. 9, 19 99 do hereby state that under requirements of P.A. 74, Michigan P.A. of 1970, the corner points mentioned in lines 1 and 2 above were in conformance with regulations and rules therefore as required in the current manual of survey instructions of the United States Department of the Interior, Bureau of Land Management or by a decree of a Court of Law and /or that the corner points mentioned in lines 3, 4 and 5 above were in conformance with the rules of the Michigan Board of Land Surveyors or by a Decree of a Court of Law; established, re-established, monumented, recovered, found as expressed below:

NOTE: Not more than 2 corners, all in the same town and range, may be recorded on this certificate.

A. Description of original monument and accessories and/or subsequent restoration:

A-11 1837	GLO	Brookfield	Set Post
1918-64	Williams & Works		Iron
	Kent Co. Wits		Iron and Stone
1984	LCRC #3880	Kolehouse	Found Muskegon County Monument (common - M-11, T10N, R13W)
1994	LCRC #7519	J. Glaza	Kent County Monument

P.A. 345 1999 KENT COUNTY,

PEER APPROVED 2/25/99
CHAIRMAN [Signature]

The position of this corner was previously approved by the Kent County Remonumentation Peer Group, as found and verified by Randy J. Kolehouse on 8-11-84 and was recorded per LCRC #3880.

B. Description of corner evidence found and/or method applied in restoring or reestablishing corner:

A-11 Found Muskegon County Monument per witnesses from above LCRC as found and verified by Randy J. Said Muskegon County Monument checks with Williams & Works information and Kent Co. Wits.

LCRC #3880		LCRC #7519	
Nail & Remon. tag 36" Oak	N80°E 110.92'	Nail & Remon. tag 48" Oak	N80°E 110.31'
Nail & Remon. tag P. Pole	S75°E 79.97'	Nail & Remon. tag P. Pole	S75°E 79.97'
Nail & Remon. tag top wood post	S45°W 42.45'	SW corner concrete well house	N28°W 120.45'
SE corner concrete well house	N30°W 118.00'	"X" S. end concrete culvert	S55°E 37.93'
"X" on S. end conc. culvert	S55°E 37.93'	Nail & Remon. tag top wood post	S35°W 55.67'

The selected location is accepted by me and is generally accepted by professional surveyors as the best available evidence of the position of the original corner.

C. Description of monument for corner and accessories established to perpetuate locating the position of the corner:

A-11 Muskegon County Monument	
Nail & KC Remon. tag S. side 48" Oak	N80°E 110.26'
Nail & KC Remon. tag N. side P. Pole	S75°E 79.91'
SW corner concrete well house	N28°W 120.36'
Nail & KC Remon. tag top of 8" wood post	S35°W 55.69'
Nail & KC Remon. tag S. side P. Pole	N65°E 81.73'

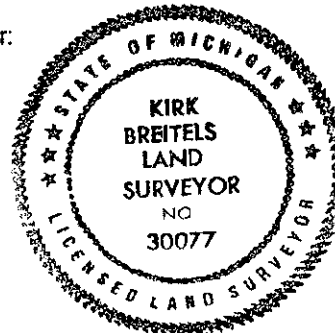

Signed by [Signature]
Surveyor's Michigan License No. 30077

Date 2/25/99