

MAY 22 2000

KENT COUNTY REMONUMENTATION

LAND CORNER RECORDATION CERTIFICATE
Filing Requirement of Act 74, Mich. P.A. 1970

REG. OF DEEDS

[Signature]

STATE OF MICHIGAN
COUNTY OF KENT
RECEIVED FOR RECORD
1999 MAR 24 AM 9:00

\$7.00
\$2.00

SECTION

For corners in

KENT COUNTY
(County)

Located in:

Corner Code #

Tyrone Twp.

A-12

1. Public Land Survey

T 10N R 12W

T R

T R

T R

T R

2. Property Controlling in Section

S T R

S T R

3. Miscellaneous Property in Sec.

S T R

S T R

11125

Register of Deeds Stamp & File Number

4. Lot No. _____, Recorded Plat _____
5. Private Claims _____

I, Kirk Breitels, in a field survey on Jan. 15, 19 99 do hereby state that under requirements of P.A. 74, Michigan P.A. of 1970, the corner points mentioned in lines 1 and 2 above were in conformance with regulations and rules therefore as required in the current manual of survey instructions of the United States Department of the Interior, Bureau of Land Management or by a decree of a Court of Law and/or that the corner points mentioned in lines 3, 4 and 5 above were in conformance with the rules of the Michigan Board of Land Surveyors or by a Decree of a Court of Law; established, re-established, monumented, recovered, found as expressed below:

NOTE: Not more than 2 corners, all in the same town and range, may be recorded on this certificate.

	A	B	C	D	E	F	G	H	I	J	K	L	M
1													
2	6		5		4		3		2		1		
3													
4	7		8		9		10		11		12		
5													
6	18		17		16		15		14		13		
7													
8	19		20		21		22		23		24		
9													
10	30		29		28		27		26		25		
11													
12	31		32		33		34		35		36		
13													

P.A. 345 1990 KENT COUNTY

PEER APPROVED 2/25/99

CHAIRMAN [Signature]

A. Description of original monument and accessories and/or subsequent restoration:

- A-12 1837 GLO Brookfield
- Kent Co. Wits Nederveld
- 1977 LCRC #1115 C. F. Lewandowski
- 1982 Liber 1242, Page 313 (Muskegon Co.) Byl
- 1983 LCRC #3243 J. Glaza
- 1994 LCRC #7515

Set Post Iron
"T" Iron
Set Harrison "County Surveyor" Mon.
Found "County Surveyor" Monument
Kent County Monument

The position of this corner was previously approved by the Kent County Remonumentation Peer Group, as found ("County Surveyor" Mon.) by William R. Byl on 1-21-83 and was recorded per LCRC #3243.

B. Description of corner evidence found and/or method applied in restoring or reestablishing corner:

A-12 Found Harrison "County Surveyor" Monument per witnesses from above LCRC as found by William R. Said Muskegon County Monument checks Muskegon Co. LCRC #1242, Pg. 313 and Kent Co. Wit. and LCRC #1115. LCRC #7515

- Nail & Remon. tag 28" Pine N55°W 51.36'
- Nail & Remon. tag 24" Cedar S70°W 95.79'
- Nail & Remon. tag 18" Pine S30°W 105.07'
- Nail & Remon. tag 48" Maple N90°E 24.64'
- Nail & Remon. tag 36" Maple N20°E 73.58'

The selected location is accepted by me and is generally accepted by professional surveyors as the best available evidence of the position of the original corner.

C. Description of monument for corner and accessories established to perpetuate locating the position of the corner:

- A-12 Harrison "County Surveyor" Monument N55°W 51.41'
- Nail & KC Remon. tag NE side 28" Pine S70°W 95.79'
- Nail & KC Remon. tag N. side 24" Twin Cedar S30°W 105.07'
- Nail & KC Remon. tag E. side 18" Pine N90°E 24.64'
- Nail & KC Remon. tag N. side 48" Maple N20°E 73.58'
- Nail & KC Remon. tag W. side 36" Maple
- C/L N-S asphalt road is 6' ± West

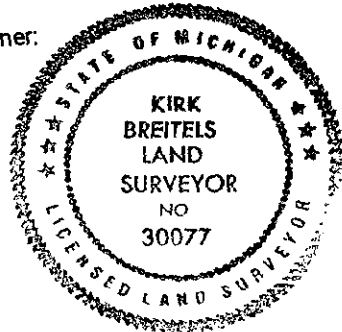

Signed by [Signature]
Surveyor's Michigan License No. 30077

Date 2/25/99