

SURVEY & REMONUMENTATION

37.00
32.00

MAY 22 2000

KENT COUNTY REMONUMENTATION

SECTION

LAND CORNER RECORDATION CERTIFICATE
Filing Requirement of Act 74, Mich. P.A. 1970

REG. OF DEEDS

[Signature]

STATE OF MICHIGAN
COUNTY OF KENT
RECEIVED FOR RECORD
1999 NOV - 4 AM 8:37

For corners in

KENT COUNTY

(County)

Located In:

Corner Code #

Tyrone Twp.

1. Public Land Survey	T	10N	R	12W	B-1
	T		R		
	T		R		
	T		R		
2. Property Controlling in Section	S		T	R	
	S		T	R	
3. Miscellaneous Property in Sec.	S		T	R	
	S		T	R	

11488

Register of Deeds Stamp & File Number

4. Lot No. _____, Recorded Plat _____
5. Private Claims _____

I, Kirk Breitels, in a field survey on Sept. 20, 19 99 do hereby state that under requirements of P.A. 74, Michigan P.A. of 1970, the corner points mentioned in lines 1 and 2 above were in conformance with regulations and rules therefore as required in the current manual of survey instructions of the United States Department of the Interior, Bureau of Land Management or by a decree of a Court of Law and/or that the corner points mentioned in lines 3, 4 and 5 above were in conformance with the rules of the Michigan Board of Land Surveyors or by a Decree of a Court of Law; established, re-established, monumented, recovered, found as expressed below:

NOTE: Not more than 2 corners, all in the same town and range, may be recorded on this certificate.

	A	B	C	D	E	F	G	H	I	J	K	L	M
1		●											
2	6		5		4		3		2		1		
3													
4	7		8		9		10		11		12		
5													
6	18		17		16		15		14		13		
7													
8	19		20		21		22		23		24		
9													
10	30		29		28		27		26		25		
11													
12	31		32		33		34		35		36		
13													

A. Description of original monument and accessories and/or subsequent restoration:

B-1 1837	GLO	Brookfield	Not Set
1977	LCRC #1061	Campbell	"T" Iron
1985	LCRC #4369	Ochs	Set Kent County Monument on Twp. Line
1994	LCRC #7535	J. Glaza	Kent County Monument

P.A. 345 1990 KENT COUNTY

PEER APPROVED 9/23/99
CHAIRMAN [Signature]

The position of this corner was previously approved by the Kent County Remonumentation Peer Group, monumented by Norman L. Ochs on 10-21-85 and was recorded per LCRC #4369.

B. Description of corner evidence found and/or method applied in restoring or reestablishing corner:

B-1 Found Kent County Monument (Harrison) per witnesses from above LCRC as set on Twp. Line by Norman L. Ochs. "T" per LCRC #4369 was 3.11' South of Twp. Line.

LCRC #4369	Nail & Remon. tag 24" Oak	N65°W 59.62'	LCRC #7535	Nail & Remon. tag 36" Oak	N00°E 45.05'
	Nail & Remon. tag 18" stump	N60°W 54.08'		Nail & Remon. tag P. Pole	N55°E 61.69'
	Nail & Remon. tag 28" Oak	North 42.25'		SW corner house	N30°E 66.28'
	Nail & Remon. tag P. Pole	N55°E 61.69'		Nail & Remon. tag 4" Tree	S25°W 60.00'
	SW corner house	N30°E 66.28'		SW cor. Sec. 32 Grant Twp. East	296.97'
	SW cor. Sec. 32 Grant Twp. East	296.97'			

The selected location is accepted by me and is generally accepted by professional surveyors as the best available evidence of the position of the corner.

C. Description of monument for corner and accessories established to perpetuate locating the position of the corner:

B-1 Standard Kent County Monument	Nail & KC Remon. tag E. side 36" Oak	N00°E	45.02'
	Nail & KC Remon. tag SE side P. Pole	N55°E	61.66'
	SW corner brick house	N30°E	66.28'
	Nail & KC Remon. tag NW side 10" Poplar	S25°W	59.90'
	SW cor., Sec. 32, Grant Twp. (Newaygo Co. Mon.)	East	296.80'

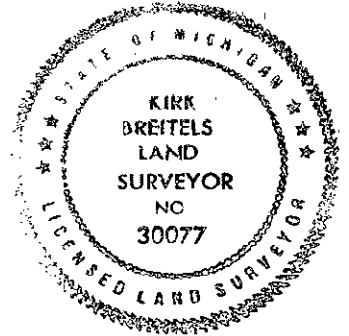

Signed by [Signature]
Surveyor's Michigan License No. 30077

Date 10/28/99