

\$7.00  
\$2.00

SURVEY &  
RECORDATION

MAY 22 2000 KENT COUNTY REMONUMENTATION

LAND CORNER RECORDATION CERTIFICATE  
SECTION Filing Requirement of Act 74, Mich. P.A. 1970

STATE OF MICHIGAN  
COUNTY OF KENT  
RECEIVED FOR RECORD  
1999 MAR 24 AM 8:00

REG. OF DEEDS

11127

Register of Deeds Stamp & File Number

For corners in  
KENT COUNTY  
(County)

Located In:	Corner Code #
T 10N R 12W T ___ R ___ T ___ R ___ T ___ R ___ T ___ R ___	Tyrone Twp. B-5 _____ _____ _____ _____
S ___ T ___ R ___ S ___ T ___ R ___ S ___ T ___ R ___ S ___ T ___ R ___	_____ _____ _____ _____

1. Public Land Survey

2. Property Controlling  
in Section

3. Miscellaneous  
Property in Sec.

4. Lot No. \_\_\_\_\_, Recorded Plat \_\_\_\_\_  
5. Private Claims \_\_\_\_\_

Kirk Breitels, in a field survey on Jan. 25, 1999 do hereby state that under requirements of P.A. 74, Michigan P.A. of 1970, the corner points mentioned in lines 1 and 2 above were in conformance with regulations and rules therefore as required in the current manual of survey instructions of the United States Department of the Interior, Bureau of Land Management or by a decree of a Court of Law and/or that the corner points mentioned in lines 3, 4 and 5 above were in conformance with the rules of the Michigan Board of Land Surveyors or by a Decree of a Court of Law; established, re-established, monumented, recovered, found as expressed below:

NOTE: Not more than 2 corners, all in the same town and range, may be recorded on this certificate.

1	A	B	C	D	E	F	G	H	I	J	K	L	M
2	6		5		4		3		2		1		
3													
4	7		8		9		10		11		12		
5													
6	18		17		16		15		14		13		
7													
8	19		20		21		22		23		24		
9													
10	30		29		28		27		26		25		
11													
12	31		32		33		34		35		36		
13													

P.A. 345 1990 KENT COUNTY

PEER APPROVED 2/25/99

CHAIRMAN *Harry Huber*

A. Description of original monument and accessories and/or subsequent restoration:

B-5 1837	GLO	Whitcomb	Set Post
	Kent Co. Wits		No information
1979	LCRC #1315	Nederveld	Set Capped Rerod at prorated distance between A-5 & C-5
1982	LCRC #2640	Jonker	Set Kent County Monument
1994	LCRC #7550	J. Glaza	Kent County Monument

The position of this corner was previously approved by the Kent County Remonumentation Peer Group, monumented by Robert J. Jonker on 2-17-82 and was recorded per LCRC #2640.

B. Description of corner evidence found and/or method applied in restoring or reestablishing corner:

B-5 Found Kent County Monument (Harrison) per witnesses from above LCRC as set by Robert J. Jonker in place of the Capped Rerod he found. Said Capped Rerod checks with LCRC #1315.	
LCRC #2640	LCRC #7550
Nail & Remon. tag P. Pole S07°E 83.0'	Nail & Remon. tag P. Pole S07°E 83.05'
Nail & Remon. tag 6" Cherry S50°W 67.13'	NE corner house foundation S55°E 125.70'
Nail & Remon. tag 6" Cherry N32°W 35.15'	Nail & Remon. tag wood fence post S64°E 62.53'
Nail & Remon. tag 6" Cherry N15°E 29.03'	G & A Capped Iron N00°E 15.92'
NE corner house foundation S55°E 125.7'	

The selected location is accepted by me and is generally accepted by professional surveyors as the best available evidence of the position of the original corner.

C. Description of monument for corner and accessories established to perpetuate locating the position of the corner:

B-5 Standard Kent County Monument	
Nail & KC Remon. tag W. side P. Pole	S07°E 83.05'
NE corner house foundation (#4390)	S55°E 125.70'
Nail & KC Remon. tag N. side wood fence post	S64°E 62.53'
Nail & KC Remon. tag SE side 6" Apple	N40°E 33.77'
Nail & KC Remon. tag NE side 6" Apple	N40°W 35.63'

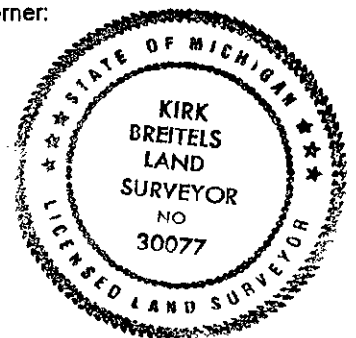

Signed by *Kirk Breitels*  
Surveyor's Michigan License No. 30077

Date 2/25/99