

MAY 22 2000

SECTION

KENT COUNTY REMONUMENTATION

LAND CORNER RECORDATION CERTIFICATE
Filing Requirement of Act 74, Mich. P.A. 1970

\$7.00
\$2.00

For corners in

KENT COUNTY
(County)

Located In:

Corner Code #

Tyrone Twp.
B-6

- 1. Public Land Survey T 10N R 12W
 T R
 T R
 T R
- 2. Property Controlling S T R
 in Section S T R
- 3. Miscellaneous S T R
 Property in Sec. S T R

- 4. Lot No. _____, Recorded Plat _____
- 5. Private Claims _____

I, Kirk Breitels, in a field survey on Nov. 9, 19 99 do hereby state that under requirements of P.A. 74, Michigan P.A. of 1970, the corner points mentioned in lines 1 and 2 above were in conformance with regulations and rules therefore as required in the current manual of survey instructions of the United States Department of the Interior, Bureau of Land Management or by a decree of a Court of Law and /or that the corner points mentioned in lines 3, 4 and 5 above were in conformance with the rules of the Michigan Board of Land Surveyors or by a Decree of a Court of Law; established, re-established, monumented, recovered, found as expressed below:

NOTE: Not more than 2 corners, all in the same town and range, may be recorded on this certificate.

A. Description of original monument and accessories and/or subsequent restoration:

B-6	1837	GLO	Not Set
		Williams & Works	No information
		Kent Co. Wits	No information

P.A. 345 1990 KENT COUNTY
PEER APPROVED 12/02/99
CHAIRMAN Harry Huber

B. Description of corner evidence found and/or method applied in restoring or reestablishing corner:

B-6 Established Intersection of 1/4 lines and found location to be at East edge of a 3' wide North-South ditch. Ditch angles to East 7' ± North of Intersection of 1/4 lines and follows 1/4 line to East ± 30' East of Intersection of 1/4 lines.

Intersection of 1/4 lines agrees with minimal survey information in this section.

The Intersection of 1/4 lines is accepted by me and is generally accepted by professional surveyors as the best available evidence of the position of the corner.

C. Description of monument for corner and accessories established to perpetuate locating the position of the corner:

- B-6. Set series of Iron Pipes and Rerods (48" long total) with "Kent Co. Remon." cap at Intersection of 1/4 lines
- Nail & KC Remon. tag NE side 24" Elm S50°E 9.99'
- Nail & KC Remon. tag S. side 12" Ash S85°E 46.95'
- Nail & KC Remon. tag NE side 4" Ash N55°W 28.47'
- Nail & KC Remon. tag N. side 8" Maple S75°W 34.92'
- At East edge of N-S 3' wide ditch
- Angle point of N-S ditch is N10°W 7' ±
- 30' ± East of Intersection of 1/4 lines, ditch running East is on 1/4 line ±

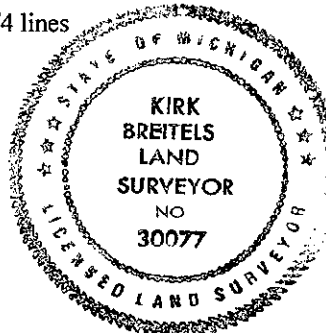

Signed by Kirk Breitels
Surveyor's Michigan License No. 30077

Date 12/6/99

1	A	B	C	D	E	F	G	H	I	J	K	L	M
2		6		5		4		3		2		1	
3													
4		7		8		9		10		11		12	
5													
6		18		17		16		15		14		13	
7													
8		19		20		21		22		23		24	
9													
10		30		29		28		27		26		25	
11													
12		31		32		33		34		35		36	
13													

STATE OF MICHIGAN
COUNTY OF KENT
RECEIVED FOR RECORD
1999 DEC 15 AM 9:56
REG. OF DEEDS

11599

Register of Deeds Stamp & File Number