

\$7.00  
\$2.00

JUL 24 2000

KENT COUNTY REMONUMENTATION

SECTION

LAND CORNER RECORDATION CERTIFICATE  
Filing Requirement of Act 74, Mich. P.A. 1970

REG. OF DEEDS

1999 JUL -9 AM 11:20

STATE OF MICHIGAN  
COUNTY OF KENT  
RECEIVED FOR RECORD

11250

Register of Deeds Stamp & File Number

For corners in

KENT COUNTY

(County)

Located in:

Corner Code #

Tyrone Twp.

- 1. Public Land Survey      T 10N R 12W      C-2
- T    R
- T    R
- T    R
- T    R
- 2. Property Controlling    S    T    R
- in Section                S    T    R
- 3. Miscellaneous            S    T    R
- Property in Sec.         S    T    R

- 4. Lot No. \_\_\_\_\_, Recorded Plat \_\_\_\_\_
- 5. Private Claims \_\_\_\_\_

I, Kirk Breitels, in a field survey on May 25, 1999 do hereby state that under requirements of P.A. 74, Michigan P.A. of 1970, the corner points mentioned in lines 1 and 2 above were in conformance with regulations and rules therefore as required in the current manual of survey instructions of the United States Department of the Interior, Bureau of Land Management or by a decree of a Court of Law and /or that the corner points mentioned in lines 3, 4 and 5 above were in conformance with the rules of the Michigan Board of Land Surveyors or by a Decree of a Court of Law; established, re-established, monumented, recovered, found as expressed below:

NOTE: Not more than 2 corners, all in the same town and range, may be recorded on this certificate.

A	B	C	D	E	F	G	H	I	J	K	L	M
1												
2	6	●	5	4	3	2	1					
3												
4	7		8	9	10	11	12					
5												
6	18	17	16	15	14	13						
7												
8	19	20	21	22	23	24						
9												
10	30	29	28	27	26	25						
11												
12	31	32	33	34	35	36						
13												

A. Description of original monument and accessories and/or subsequent restoration:

- C-2 1837 GLO Whitcomb Set Post
- Kent Co. Wits Iron
- 1973 LCRC #537 Spicer 3/4" Iron
- 1979 LCRC #1262 Campbell 3/4" Iron
- 1982 LCRC #2709 Jonker Set Kent County Monument
- 1994 LCRC #7526 J. Glaza Kent County Monument

P.A. 345 1990 KENT COUNTY  
PEER APPROVED 6/24/99  
CHAIRMAN Harry Huber

The position of this corner was previously approved by the Kent County Remonumentation Peer Group, monumented by Robert J. Jonker on 3-10-82 and was recorded per LCRC #2709.

B. Description of corner evidence found and/or method applied in restoring or reestablishing corner:

C-2 Found Kent County Monument (Harrison) per witnesses from above LCRC as set by Robert J. Jonker in place of the 3/4" Iron he found. Said 3/4" Iron checks with Kent Co. Wits. and LCRC's #537 & 1262.

- |            |  |  |
|------------|--|--|
| LCRC #2709 | Nail & Remon. tag 20" Maple S30°W 15.21' | Nail & Remon. tag 22" Maple S30°W 15.10' |
|            | Nail & Remon. tag 10" Maple S10°W 6.23'  | Nail & Remon. tag 14" Maple S80°W 6.08'  |
|            | Nail & Remon. tag 18" Maple N30°W 34.90' | Nail & Remon. tag 16" Maple N30°W 45.82' |
|            | Nail & Remon. tag 12" Maple N37°E 41.82' | Nail & Remon. tag 20" Maple N37°E 41.89' |
|            | Nail & Remon. tag 6" Maple S85°E 16.85'  | Nail & Remon. tag 8" Maple S85°E 16.79'  |
|            | Fence corner N-W-S is 6' ± West          | Fence corner N-W-S is 6' ± West          |

The selected location is accepted by me and is generally accepted by professional surveyors as the best available evidence of the position of the original corner.

C. Description of monument for corner and accessories established to perpetuate locating the position of the corner:

- C-2 Standard Kent County Monument
- Nail & KC Remon. tag E. side 24" Maple S30°W 15.10'
- Nail & KC Remon. tag N. side 16" Maple S80°W 6.08'
- Nail & KC Remon. tag SW side 18" Maple N30°W 45.82'
- Nail & KC Remon. tag N. side 10" Maple S85°E 16.79'
- Nail & KC Remon. tag NW side 18" Pine N45°E 53.54'
- Fence corner to N-W-S is 6' ± West
- On line with S. edge of woods to East, at NW corner of orchard ±

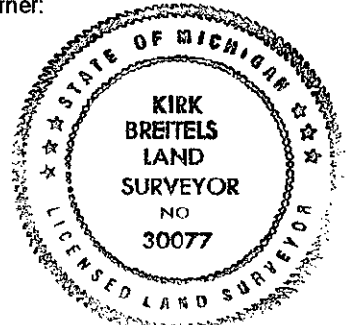

Signed by Kirk Breitels  
Surveyor's Michigan License No. 30077

Date 6/24/99