

MAY 22 2000

KENT COUNTY REMONUMENTATION

SECTION

LAND CORNER RECORDATION CERTIFICATE
Filing Requirement of Act 74, Mich. P.A. 1970

For corners in
KENT COUNTY

(County)

Located in: Corner Code #
Tyrone Twp.
C-8

T10N R 12W
T R
T R
T R
S T R
S T R
S T R
S T R

- 1. Public Land Survey
- 2. Property Controlling in Section
- 3. Miscellaneous Property in Sec.

4. Lot No. _____, Recorded Plat _____
5. Private Claims _____

I, Kirk Breitels, in a field survey on Jan. 26, 1999 do hereby state that under requirements of P.A. 74, Michigan P.A. of 1970, the corner points mentioned in lines 1 and 2 above were in conformance with regulations and rules therefore as required in the current manual of survey instructions of the United States Department of the Interior, Bureau of Land Management or by a decree of a Court of Law and/or that the corner points mentioned in lines 3, 4 and 5 above were in conformance with the rules of the Michigan Board of Land Surveyors or by a Decree of a Court of Law; established, re-established, monumented, recovered, found as expressed below:

NOTE: Not more than 2 corners, all in the same town and range, may be recorded on this certificate.

A. Description of original monument and accessories and/or subsequent restoration:

C-8 1837	GLO	Whitcomb	Set Post
1972	Kent Co. Wits		Stone
1981	LCRC #2079	Nederveld	Angle Iron
1982	LCRC #3016	Starr	Set Kent County Monument
1994	LCRC #7589	J. Glaza	Kent County Monument

P.A. 345 1990 KENT COUNTY
PEER APPROVED 2/25/99
CHAIRMAN Thomas C. Starr

The position of this corner was previously approved by the Kent County Remonumentation Peer Group, monumented by Thomas C. Starr on 8-2-82 and was recorded per LCRC #3016.

B. Description of corner evidence found and/or method applied in restoring or reestablishing corner:

C-8 Found Kent County Monument (Harrison) per witnesses from above LCRC as set by Thomas C. Starr in place of the 1" Angle Iron he found. Said Angle Iron checks with Kent Co. Wits. and LCRC #2079.

LCRC #3016		LCRC #7589	
Nail & Remon. tag P. Pole	S20°E 114.16'	Nail & Remon. tag P. Pole	S20°E 114.16'
Nail & Remon. tag P. Pole	S35°W 81.01'	Nail & Remon. tag P. Pole	S35°W 81.01'
Nail & Remon. tag 18" Oak	N15°E 44.42'	Nail & Remon. tag 24" Oak	N15°E 44.40'
Nail & Remon. tag 18" Oak	N40°E 89.84'	Nail & Remon. tag 22" Oak	N40°E 89.85'
Nail & Remon. tag 10" Pine	N85°E 26.85'	Nail & Remon. tag 12" Pine	N85°E 26.85'
SW cor. brick house	S40°E 129.75'	SW corner brick house	S40°E 129.75'

The selected location is accepted by me and is generally accepted by professional surveyors as the best available evidence of the position of the original corner.

C. Description of monument for corner and accessories established to perpetuate locating the position of the corner:

C-8 Standard Kent County Monument

Nail & KC Remon. tag W. side P. Pole	S20°E	114.16'
Nail & KC Remon. tag W. side P. Pole	S35°W	81.01'
Nail & KC Remon. tag NW side 26" Oak	N15°E	89.88'
Nail & KC Remon. tag NW side 26" Oak	N40°E	44.42'
Nail & KC Remon. tag S. side 14" Pine	N85°E	26.87'
SW corner brick house	S40°E	129.70'

On C/L N-S bit. road

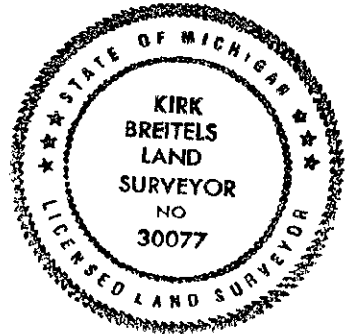

Signed by Kirk Breitels
Surveyor's Michigan License No. 30077

Date 2/25/99

STATE OF MICHIGAN
COUNTY OF KENT
RECEIVED FOR RECORD
1999 MAR 24 AM 8:01
REG. OF DEEDS

11134

Register of Deeds Stamp & File Number

	A	B	C	D	E	F	G	H	I	J	K	L	M
1													
2	6		5		4		3		2		1		
3													
4	7		8		9		10		11		12		
5													
6	18		17		16		15		14		13		
7													
8	19		20		21		22		23		24		
9													
10	30		29		28		27		26		25		
11													
12	31		32		33		34		35		36		
13													