

\$7.00
\$2.00

MAY 22 2000

KENT COUNTY REMONUMENTATION

LAND CORNER RECORDATION CERTIFICATE
Filing Requirement of Act 74, Mich. P.A. 1970

SECTION

For corners in

KENT COUNTY (County)	Located In:	Corner Code #
1. Public Land Survey	T <u>10</u> N R <u>12</u> W	Tyrone Twp. C-11
	T ___ R ___	_____
	T ___ R ___	_____
	T ___ R ___	_____
2. Property Controlling in Section	S ___ T ___ R ___	_____
	S ___ T ___ R ___	_____
3. Miscellaneous Property in Sec.	S ___ T ___ R ___	_____
	S ___ T ___ R ___	_____

REG. OF DEEDS

[Signature]

STATE OF MICHIGAN
COUNTY OF KENT
RECEIVED FOR RECORD
1999 NOV -4 AM 8:37

11492

Register of Deeds Stamp & File Number

4. Lot No. _____, Recorded Plat _____
5. Private Claims _____

I, Kirk Breitels, in a field survey on Sept. 21, 1999 do hereby state that under requirements of P.A. 74, Michigan P.A. of 1970, the corner points mentioned in lines 1 and 2 above were in conformance with regulations and rules therefore as required in the current manual of survey instructions of the United States Department of the Interior, Bureau of Land Management or by a decree of a Court of Law and /or that the corner points mentioned in lines 3, 4 and 5 above were in conformance with the rules of the Michigan Board of Land Surveyors or by a Decree of a Court of Law; established, re-established, monumented, recovered, found as expressed below.

NOTE: Not more than 2 corners, all in the same town and range, may be recorded on this certificate.

A	B	C	D	E	F	G	H	I	J	K	L	M
1												
2	6		5		4		3		2		1	
3												
4	7		8		9		10		11		12	
5												
6	16		17		16		15		14		13	
7												
8	19		20		21		22		23		24	
9												
10	30		29		28		27		26		25	
11												
12	31		32		33		34		35		36	
13												

A. Description of original monument and accessories and/or subsequent restoration:

C-11 1837 GLO	Whitcomb	Set Post
1958 Kent Co. Wits		1" Iron in Mon. Box
1983 LCRC #3359	Glaza	1" Iron in Mon. Box
1986 LCRC #4455	Kolehouse	Set Kent County Monument in Mon. Box
1994 LCRC #7513	J. Glaza	Kent County Monument

P.A. 345 1990 KENT COUNTY
PEER APPROVED 9/23/99
CHAIRMAN [Signature]

The position of this corner was previously approved by the Kent County Remonumentation Peer Group, monumented by Randy J. Kolehouse on 4-5-86 and was recorded per LCRC #4455.

B. Description of corner evidence found and/or method applied in restoring or reestablishing corner:

C-11 Found BROKEN Kent County Monument (Harrison) in Mon. Box per witnesses from above LCRC as set by Randy J. Kolehouse in place of a 1" Iron he found inside a Mon. Box over a 2" Iron. Both Irons check with Kent Co. Wits. and LCRC #3359. Removed and reset Kent County Monument in Mon. Box LCRC #4455 LCRC #7513

Nail & Remon. tag G. Pole	N30°E 74.00'	Nail & Remon. tag G. Pole	N30°E 74.00'
Nail & Remon. tag P. Pole	N30°W 67.55'	Nail & Remon. tag P. Pole	N30°W 67.55'
Nail & Remon. tag P. Pole	N52°W 57.85'	Nail & Remon. tag P. Pole	N52°W 57.85'
PK Nail & Remon. tag in curb joint	S45°W 37.50'	PK Nail & Remon. tag in curb joint	S45°W 37.50'
PK Nail & Remon. tag in curb joint	S45°E 40.80'	NW corner stone address monument	S45°E 86.00'

The selected location is accepted by me and is generally accepted by professional surveyors as the best available evidence of the position of the original corner.

C. Description of monument for corner and accessories established to perpetuate locating the position of the corner:

C-11 Standard Kent County Monument in Mon. Box	
Nail & KC Remon. tag W. side Guy Pole	N30°E 74.00'
Nail & KC Remon. tag NE side P. Pole	N30°W 67.53'
Nail & KC Remon. tag SW side P. Pole	N52°W 57.85'
PK Nail & KC Remon. tag in curb joint	S45°W 37.50'
NW'ly corner stone address monument	S45°E 85.95'
On C/L E-W & N-S asphalt roads.	

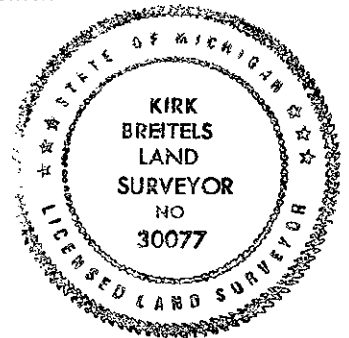

Signed by [Signature]
Surveyor's Michigan License No. 30077

Date 10/28/99