

\$7.00  
\$2.00

MAY 28 2000

KENT COUNTY REMONUMENTATION

SECTION LAND CORNER RECORDATION CERTIFICATE  
Filing Requirement of Act 74, Mich. P.A. 1970

For corners in

KENT COUNTY (County)	Located In:	Corner Code #
	Tyrone Twp.	
1. Public Land Survey	T 10N R 12W	E-1
	T R	
	T R	
	T R	
2. Property Controlling in Section	S T R	
	S T R	
3. Miscellaneous Property in Sec.	S T R	
	S T R	

REG. OF DEEDS

1999 JUL -9 AM 11:20

STATE OF MICHIGAN  
COUNTY OF KENT  
RECEIVED FOR RECORD

11251

Register of Deeds Stamp & File Number

4. Lot No. \_\_\_\_\_, Recorded Plat \_\_\_\_\_

5. Private Claims \_\_\_\_\_

I, Kirk Breitels, in a field survey on May 25, 1999 do hereby state that under requirements of P.A. 74, Michigan P.A. of 1970, the corner points mentioned in lines 1 and 2 above were in conformance with regulations and rules therefore as required in the current manual of survey instructions of the United States Department of the Interior, Bureau of Land Management or by a decree of a Court of Law and /or that the corner points mentioned in lines 3, 4 and 5 above were in conformance with the rules of the Michigan Board of Land Surveyors or by a Decree of a Court of Law; established, re-established, monumented, recovered, found as expressed below:

NOTE: Not more than 2 corners, all in the same town and range, may be recorded on this certificate.

A	B	C	D	E	F	G	H	I	J	K	L	M
1												
2	6		5		4		3		2		1	
3												
4	7		8		9		10		11		12	
5												
6	18		17		16		15		14		13	
7												
8	19		20		21		22		23		24	
9												
10	30		29		28		27		26		25	
11												
12	31		32		33		34		35		36	
13												

A. Description of original monument and accessories and/or subsequent restoration:

E-1 1837	GLO	Whitcomb	Set Post
1959	Kent Co. Wits		1" Iron in Mon. Box
1973	LCRC #536	Spicer	1/2" Iron in Mon. Box
1985	LCRC #4372	Ochs	Set Kent County Monument in Mon. Box
1994	LCRC #7540	J. Glaza	Kent County Monument

P.A. 345 1990 KENT COUNTY  
PEER APPROVED 6/24/99  
CHAIRMAN [Signature]

The position of this corner was previously approved by the Kent County Remonumentation Peer Group, monumented by Norman L. Ochs on 10-18-85 and was recorded per LCRC #4372.

B. Description of corner evidence found and/or method applied in restoring or reestablishing corner:

E-1 Found Kent County Monument (Harrison) per witnesses from above LCRC as set on Twp. line by Norman L. Ochs in place of the 1/2" Pipe he found inside a Mon. Box. Said 1/2" Pipe checks with Kent Co. Wits. and LCRC #536.

LCRC #4372	LCRC #7540
Nail & Remon. tag P. Pole S45°W 65.27'	Nail & Remon. tag P. Pole S45°W 65.27'
Nail & Remon. tag W. Pine N50°W 80.24'	Nail & Remon. tag 10" Twin Pine N50°W 80.24'
Nail & Remon. tag Tri. Beech N55°E 128.29'	Nail & Remon. tag Tri. Beech N55°E 128.29'
Nail & Remon. tag Tri. W. Oak S40°E 160.03'	Nail & Remon. tag Tri. W. Oak S40°E 160.03'
S 1/4 cor. Sec. 33-11-12 East 304.81'	Newaygo Co. Mon. S 1/4, 33-11-12 East 304.81'

The selected location is accepted by me and is generally accepted by professional surveyors as the best available evidence of the position of the original corner.

C. Description of monument for corner and accessories established to perpetuate locating the position of the corner:

E-1 Standard Kent County Monument in Mon. Box

Nail & KC Remon. tag E. side P. Pole	S45°W	65.27'
Nail & KC Remon. tag E. side Twin 15" Pine	N50°W	80.22'
Nail & KC Remon. tag S. side P. Pole	N70°E	152.62'
Nail & KC Remon. tag E. side Tri. 10"-20"-36" Oak	S40°E	160.05'
Newaygo Co. Mon. (S 1/4 corner 33-11-12)	East	304.86'

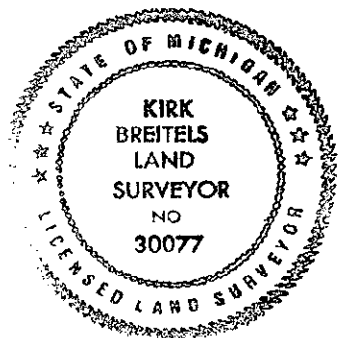

Signed by [Signature]  
Surveyor's Michigan License No. 30077

Date 6/24/99