

\$7.00
\$2.00

MAY 22 2003

KENT COUNTY REMONUMENTATION

SECTION LAND CORNER RECORDATION CERTIFICATE
Filing Requirement of Act 74, Mich. P.A. 1970

For corners in

KENT COUNTY
(County)

Located in:

Corner Code #

1. Public Land Survey		T10N R 12W	Tyrone Twp.
		T R	E-9
		T R	
		T R	
		T R	
2. Property Controlling in Section	S	T R	
	S	T R	
3. Miscellaneous Property in Sec.	S	T R	
	S	T R	

STATE OF MICHIGAN
COUNTY OF KENT
RECEIVED FOR RECORD

1999 MAR 24 AM 8:01

REG. OF DEEDS

11150

Register of Deeds Stamp & File Number

4. Lot No. _____, Recorded Plat _____
5. Private Claims _____

I, Kirk Breitels, in a field survey on Feb. 11, 1999 do hereby state that under requirements of P.A. 74, Michigan P.A. of 1970, the corner points mentioned in lines 1 and 2 above were in conformance with regulations and rules therefore as required in the current manual of survey instructions of the United States Department of the Interior, Bureau of Land Management or by a decree of a Court of Law and /or that the corner points mentioned in lines 3, 4 and 5 above were in conformance with the rules of the Michigan Board of Land Surveyors or by a Decree of a Court of Law, established, re-established, monumented, recovered, found as expressed below:

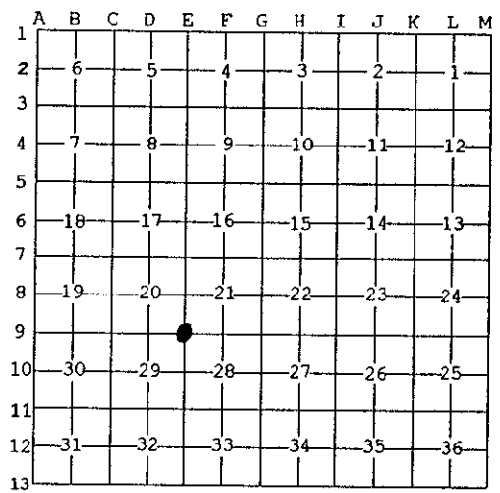

NOTE: Not more than 2 corners, all in the same town and range, may be recorded on this certificate.

A. Description of original monument and accessories and/or subsequent restoration:

E-9 1837	GLO	Whitcomb	Set Post
	Kent Co. Wits		Axlc
1973	LCRC #463	Spicer	Iron in Mon. Box
1982	LCRC #2651	Jonker	Set Kent County Monument in Mon. Box
1994	LCRC #7574	J. Glaza	Kent County Monument

P.A. 345 1990 KENT COUNTY
PEER APPROVED 2/25/99
CHAIRMAN [Signature]

The position of this corner was previously approved by the Kent County Remonumentation Peer Group, monumented by Robert J. Jonker on 1-10-82 and was recorded per LCRC #2651.

B. Description of corner evidence found and/or method applied in restoring or reestablishing corner:

E-9 Found Kent County Monument (Harrison) per witnesses from above LCRC as set by Robert J. Jonker in place of the 1/2" Iron over a 1" Steel bar he found in a Mon. Box. Both check with Kent Co. Wit. and LCRC #463.	
LCRC #2651	LCRC #7574
Nail & Remon. tag P. Pole N35°E 56.34'	Nail & Remon. tag P. Pole N35°E 55.19'
SW corner house N50°E 95.90'	SW corner house N50°E 95.90'
Chiseled "X" on top of curb S46°W 50.94'	Chiseled "X" on top of curb S46°W 50.94'
Chiseled "X" on top of curb N43°W 52.70'	Chiseled "X" on top of curb N43°W 51.78'
Chiseled "X" on top of curb S52°E 52.23'	Chiseled "X" on top of curb S52°E 52.23'
On C/L "X" pavement	On C/L "X" pavement

The selected location is accepted by me and is generally accepted by professional surveyors as the best available evidence of the position of the original corner.

C. Description of monument for corner and accessories established to perpetuate locating the position of the corner:

E-9 Standard Kent County Monument in Mon. Box	
Nail & KC Remon. tag NW side P. Pole	N35°E 55.13'
SW corner house	N50°E 95.90'
"X" cut on top concrete curb	S46°W 50.94'
"X" cut on top concrete curb	N43°W 51.74'
"X" cut on top concrete curb	S52°E 52.23'
On C/L "X" of pavement	

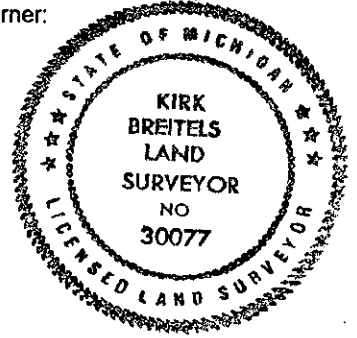

Signed by [Signature]
Surveyor's Michigan License No. 30077

Date 2/25/99