

SECTION LAND CORNER RECORDATION CERTIFICATE
Filing Requirement of Act 74, Mich. P.A. 1970

REG. OF DEEDS

[Handwritten Signature]

1999 JUL -9 AM 11:20
STATE OF MICHIGAN
COUNTY OF KENT
RECEIVED FOR RECORD

11252

Register of Deeds Stamp & File Number

For corners in
KENT COUNTY

Located In:	Corner Code #
(County)	Tyrone Twp.
1. Public Land Survey	T 10N R 12W F-1
	T R
	T R
	T R
	T R
2. Property Controlling in Section	S T R
	S T R
3. Miscellaneous Property in Sec.	S T R
	S T R

4. Lot No. _____, Recorded Plat _____
5. Private Claims _____

I, Kirk Breitels, in a field survey on May 25, 19 99 do hereby state that under requirements of P.A. 74, Michigan P.A. of 1970, the corner points mentioned in lines 1 and 2 above were in conformance with regulations and rules therefore as required in the current manual of survey instructions of the United States Department of the Interior, Bureau of Land Management or by a decree of a Court of Law and /or that the corner points mentioned in lines 3, 4 and 5 above were in conformance with the rules of the Michigan Board of Land Surveyors or by a Decree of a Court of Law; established, re-established, monumented, recovered, found as expressed below:

NOTE: Not more than 2 corners, all in the same town and range, may be recorded on this certificate.

A	B	C	D	E	F	G	H	I	J	K	L	M
1												
2	6		5		4		3		2			1
3												
4	7		8		9		10		11			12
5												
6	18		17		16		15		14			13
7												
8	19		20		21		22		23			24
9												
10	30		29		28		27		26			25
11												
12	31		32		33		34		35			36
13												

A. Description of original monument and accessories and/or subsequent restoration:

F-1	1837	GLO	Whitcomb	Not Set
	1926	Williams & Works		1 1/4" Iron
	1959	Kent Co. Wits		1 1/4" Iron Pipe in Mon. Box
	1985	LCRC #4396	Ochs	Set Kent County Monument
	1994	LCRC #7523	J. Glaza	Kent County Monument

P.A. 345 1990 KENT COUNTY
PEER APPROVED 6/29/99
CHAIRMAN [Signature]

The position of this corner was previously approved by the Kent County Remonumentation Peer Group, monumented by Norman L. Ochs on 4-8-86 and was recorded per LCRC #4396.

B. Description of corner evidence found and/or method applied in restoring or reestablishing corner:

F-1	Found Kent County Monument (Harrison) per wits. from above LCRC as set on Twp. line by Norman L. Ochs 3.82' South of a 1/2" Iron found in a Mon. Box. Said 1/2" Iron checks Williams & Works information and Kent Co. Wits.
	LCRC #4396
	LCRC #7523
SE corner porch foundation	N30°E 59.40'
SW corner porch foundation	North 51.84'
Nail & Remon. tag P. Pole	S55°E 72.22'
NW corner of house	S32°E 122.61'
SE corner porch foundation	N30°E 59.38'
SW corner porch foundation	North 51.81'
Nail & Remon. tag P. Pole	S55°E 72.20'
NW corner of house	S32°E 122.61'
Newaygo C. Mon. (SE cor. 31-11-12) N90°E 351.20'	

The selected location is accepted by me and is generally accepted by professional surveyors as the best available evidence of the position of the corner.

C. Description of monument for corner and accessories established to perpetuate locating the position of the corner:

F-1	Standard Kent County Monument*
SE corner porch siding	N30°E 59.38'
SW corner porch siding	N05°E 51.68'
Nail & KC Remon. tag N. side P. Pole	S55°E 72.18'
NW corner of house	S32°E 122.61'
Nail & KC Remon. tag SE side 15" Pine	S35°W 55.11'
Newaygo Co. Mon. (SE cor. 33-11-12)	N90°E 350.96'

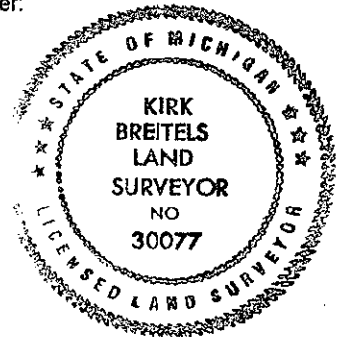

Signed by *[Signature]*
Surveyor's Michigan License No. 30077

Date 6/24/99