

MAY 22 2000

\$7.00
\$2.00

SECTION

KENT COUNTY REMONUMENTATION
LAND CORNER RECORDATION CERTIFICATE
Filing Requirement of Act 74, Mich. P.A. 1970

REG. OF DEEDS

[Signature]

STATE OF MICHIGAN
COUNTY OF KENT
RECEIVED FOR RECORD
1999 DEC 15 AM 8:56

For corners in

<u>KENT COUNTY</u> (County)	Located In:	Corner Code #
	Tyrone Twp.	
1. Public Land Survey	T <u>10N</u> R <u>12W</u>	<u>E-2</u>
	T ___ R ___	_____
	T ___ R ___	_____
	T ___ R ___	_____
2. Property Controlling in Section	S ___ T ___ R ___	_____
	S ___ T ___ R ___	_____
3. Miscellaneous Property in Sec.	S ___ T ___ R ___	_____
	S ___ T ___ R ___	_____
4. Lot No. _____	Recorded Plat _____	
5. Private Claims _____		

11605

Register of Deeds Stamp & File Number

1	A	B	C	D	E	F	G	H	I	J	K	L	M
2		6		5		4		3		2		1	
3													
4		7		8		9		10		11		12	
5													
6		18		17		16		15		14		13	
7													
8		19		20		21		22		23		24	
9													
10		30		29		28		27		26		25	
11													
12		31		32		33		34		35		36	
13													

I, Kirk Breitels, in a field survey on Oct. 8, 19 99 do hereby state that under requirements of P.A. 74, Michigan P.A. of 1970, the corner points mentioned in lines 1 and 2 above were in conformance with regulations and rules therefore as required in the current manual of survey instructions of the United States Department of the Interior, Bureau of Land Management or by a decree of a Court of Law and /or that the corner points mentioned in lines 3, 4 and 5 above were in conformance with the rules of the Michigan Board of Land Surveyors or by a Decree of a Court of Law; established, re-established, monumented, recovered, found as expressed below:

NOTE: Not more than 2 corners, all in the same town and range, may be recorded on this certificate.

A. Description of original monument and accessories and/or subsequent restoration:

F-2	1837	GLO	Not Set
		Williams & Works	No information
		Kent Co. Wits	No information

P.A. 345 1990 KENT COUNTY
PEER APPROVED 10/28/99
CHAIRMAN [Signature]

B. Description of corner evidence found and/or method applied in restoring or reestablishing corner:

F-2 Found Capped Rerod (Fries) that is less than 0.1' N. & E. from intersection of 1/4 lines

The Capped Rerod (Fries) is accepted by me and is generally accepted by professional surveyors as the best available evidence of the position of the corner.

C. Description of monument for corner and accessories established to perpetuate locating the position of the corner:

F-2. Set Standard Kent County Monument in place of the Capped Rerod (Fries)

Nail & KC Remon. tag NE side P. Pole	N55°W	90.30'
Nail & KC Remon. tag SE side 6" Oak	N40°E	134.06'
Nail & KC Remon. tag SW side 12" Oak	S30°E	43.05'
Nail & KC Remon. tag SE side 24" Oak	S60°W	11.98'
Nail & KC Remon. tag		

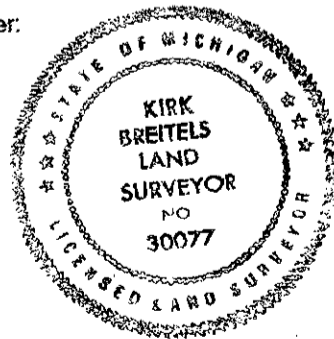

Signed by *Kirk Breitels*
Surveyor's Michigan License No. 30077

Date 12/6/99