

MAY 22 2001

KENT COUNTY REMONUMENTATION

SECTION

LAND CORNER RECORDATION CERTIFICATE
Filing Requirement of Act 74, Mich. P.A. 1970

For corners in

<u>KENT COUNTY</u> (County)	Located in:	Corner Code #
1. Public Land Survey	T <u>10N</u> R <u>12W</u>	Tyrone Twp. F-8
	T ___ R ___	_____
	T ___ R ___	_____
	T ___ R ___	_____
2. Property Controlling in Section	S ___ T ___ R ___	_____
	S ___ T ___ R ___	_____
3. Miscellaneous Property in Sec.	S ___ T ___ R ___	_____
	S ___ T ___ R ___	_____

REG. OF DEEDS

[Signature]

STATE OF MICHIGAN
COUNTY OF KENT
RECEIVED FOR RECORD
1999 NOV -4 AM 8:37

11496

Register of Deeds Stamp & File Number

4. Lot No. _____, Recorded Plat _____
5. Private Claims _____

I, Kirk Breitels, in a field survey on Aug. 23, 19 99 do hereby state that under requirements of P.A. 74, Michigan P.A. of 1970, the corner points mentioned in lines 1 and 2 above were in conformance with regulations and rules therefore as required in the current manual of survey instructions of the United States Department of the Interior, Bureau of Land Management or by a decree of a Court of Law and /or that the corner points mentioned in lines 3, 4 and 5 above were in conformance with the rules of the Michigan Board of Land Surveyors or by a Decree of a Court of Law; established, re-established, monumented, recovered, found as expressed below:

NOTE: Not more than 2 corners, all in the same town and range, may be recorded on this certificate.

A	B	C	D	E	F	G	H	I	J	K	L	M
1												
2	6		5		4		3		2		1	
3												
4	7		8		9		10		11		12	
5												
6	18		17		16		15		14		13	
7												
8	19		20		21		22		23		24	
9												
10	30		29		28		27		26		25	
11												
12	31		32		33		34		35		36	
13												

A. Description of original monument and accessories and/or subsequent restoration:

F-8	1837	GLO	Not Set
	1895	Williams & Works	Set Stone at corner (Notes indicate intersection of 1/4 lines)
	1953	Williams & Works	Found Stone with Well Point on N. side of Stone
		SE cor. hse. NW 111.90'	MBT Pole NE 55.2' 12" Apple SE 32.7' P. Pole SW 71.5'
		Kent Co. Wits	No information

P.A. 345 1990 KENT COUNTY

PEER APPROVED 8/26/99
CHAIRMAN [Signature]

B. Description of corner evidence found and/or method applied in restoring or reestablishing corner:

F-8 Found Stone 15" under asphalt road with Well Point 0.4' North of Stone per the following witnesses:
SE corner (stone foundation) house NW 111.9' ± Face of P. Pole SW 71.5' ±

Said Stone is 0.1' E. and 1.7' N. of intersection of 1/4 lines. Well Point had a Rerod stuck into it with the top of it at grade of road and was used in surveys by Roosien. Also found a Rerod within 0.2' of intersection of 1/4 lines set by All Points in 1983 and used by them in surveys. This Rerod being 1.6' South of the Stone.

Based on the existence of the Stone with witnesses and adjacent Well Point per Williams & Works notes, the Stone is accepted by me and is generally accepted by professional surveyors as the best available evidence of the position of the corner.

C. Description of monument for corner and accessories established to perpetuate locating the position of the corner:

F-8	Set Standard Kent County Monument in Mon. Box over Stone
	SE corner stone foundation of house N55°W 111.9'
	Nail & KC Remon. tag NE side P. Pole S40°E 79.00'
	Nail & KC Remon. tag SE side P. Pole S20°W 71.83'
	Nail & KC Remon. tag S. side 30" Oak S90°W 30.77'

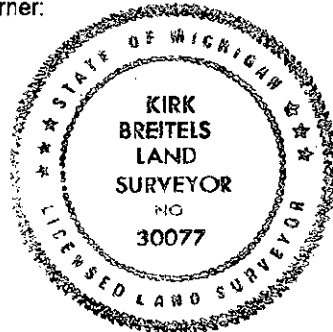

Signed by [Signature]
Surveyor's Michigan License No. 30077

Date 10/20/99