

\$7.00
\$2.00

MAR 24 2000

KENT COUNTY REMONUMENTATION

SECTION

LAND CORNER RECORDATION CERTIFICATE Filing Requirement of Act 74, Mich. P.A. 1970

For corners in

KENT COUNTY
(County)

Located in:

Corner Code #

Tyrone Twp.
G-8

- 1. Public Land Survey
- 2. Property Controlling in Section
- 3. Miscellaneous Property in Sec.

T	10N	R	12W
T		R	
T		R	
T		R	
S		T	R
S		T	R
S		T	R
S		T	R

1999 MAR 24 AM 9:02
STATE OF MICHIGAN
COUNTY OF KENT
RECEIVED FOR RECORD

REG. OF DEEDS

11163

Register of Deeds Stamp & File Number

4. Lot No. _____, Recorded Plat _____
5. Private Claims _____

I, Kirk Breitels, in a field survey on Jan. 19, 19 99 do hereby state that under requirements of P.A. 74, Michigan P.A. of 1970, the corner points mentioned in lines 1 and 2 above were in conformance with regulations and rules therefore as required in the current manual of survey instructions of the United States Department of the Interior, Bureau of Land Management or by a decree of a Court of Law and/or that the corner points mentioned in lines 3, 4 and 5 above were in conformance with the rules of the Michigan Board of Land Surveyors or by a Decree of a Court of Law; established, re-established, monumented, recovered, found as expressed below:

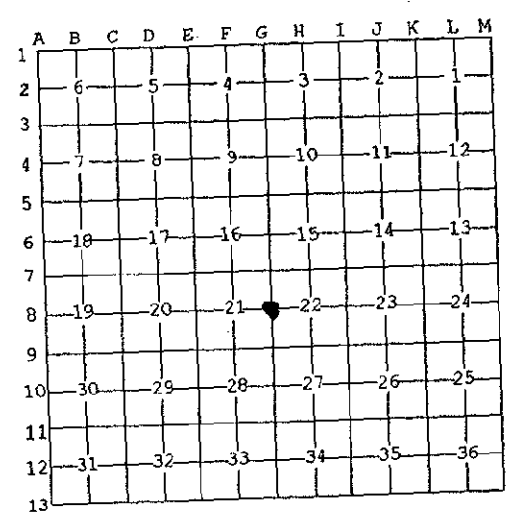

NOTE: Not more than 2 corners, all in the same town and range, may be recorded on this certificate.

A. Description of original monument and accessories and/or subsequent restoration:

G-8 1837	GLO	Whitcomb	Set Post
	Kent Co. Wits		Stone & Iron
1983	LCRC #3702	Hay	Iron & Cap
1983	LCRC #3689	Bueche	Set Kent County Monument
1994	LCRC #7585	J. Glaza	Kent County Monument

P.A. 345 1990 KENT COUNTY
PEER APPROVED 2/25/99
CHAIRMAN Harry Hubel

The position of this corner was previously approved by the Kent County Remonumentation Peer Group, monumented by John C. Bueche on 12-5-83 and was recorded per LCRC #3689.

B. Description of corner evidence found and/or method applied in restoring or reestablishing corner:

G-8 Found Kent County Monument (Harrison) per witnesses from above LCRC as set by John C. Bueche in place of the Capped Iron he found. Said Capped Iron checks with LCRC #3702.

LCRC #3689	NE cor. conc headwall	S20°E 63.05'	"V" cut SW leg of tower	N40°E 63.77'
	NW cor. conc. headwall	S25°W 61.90'	Nail & Remon. tag fence post	N90°E 28.06'
	"V" cut SW leg of tower	N40°E 63.77'	Nail & Remon. tag 10" Tree	S88°W 25.77'
	Nail & Remon. tag fence post	N90°E 27.00'	Nail & Remon. tag 10" Tree	S32°W 46.18'
	Bt. Spike in 8" Elm	S40°W 37.05'	On fence line East	
	C/L blacktop road N-S is East 3.5'		C/L blacktop road N-S is East 3.5'	

The selected location is accepted by me and is generally accepted by professional surveyors as the best available evidence of the position of the original corner.

C. Description of monument for corner and accessories established to perpetuate locating the position of the corner:

G-8 Standard Kent County Monument	"V" cut (2.5' up) SW leg of tower	N40°E 63.83'
	Nail & KC Remon. tag N. side fence post	N90°E 28.32'
	Nail & KC Remon. tag S. side 12" Aspen	S88°W 25.10'
	Nail & KC Remon. tag SE side 12" Aspen	S32°W 46.18'
	NE corner concrete headwall	S20°E 63.05'
	NW corner concrete headwall	S25°W 61.90'
	C/L N-S pavement is East 3.5'	
	On fence line East	

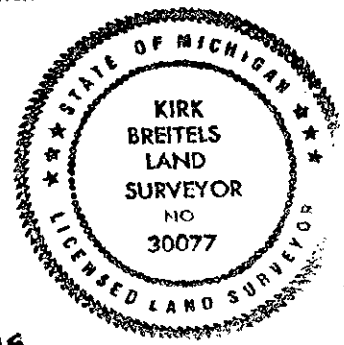

Signed by Kirk Breitels
Surveyor's Michigan License No. 30077

Date 2/25/99