

**KENT COUNTY REMONUMENTATION
LAND CORNER RECORDATION CERTIFICATE**
Filing Requirement of Act 74, Mich. P.A. 1970

For corners in

<u>KENT COUNTY</u> (County)	Located In:	Corner Code #
1. Public Land Survey	T <u>10</u> N R <u>12</u> W	<u>G-9</u>
	T <u> </u> R <u> </u>	<u> </u>
	T <u> </u> R <u> </u>	<u> </u>
	T <u> </u> R <u> </u>	<u> </u>
2. Property Controlling in Section	S <u> </u> T <u> </u> R <u> </u>	<u> </u>
	S <u> </u> T <u> </u> R <u> </u>	<u> </u>
3. Miscellaneous Property in Sec.	S <u> </u> T <u> </u> R <u> </u>	<u> </u>
	S <u> </u> T <u> </u> R <u> </u>	<u> </u>

REG. OF DEEDS
11164
Register of Deeds Stamp & File Number

STATE OF MICHIGAN
COUNTY OF KENT
RECEIVED FOR RECORD
1999 MAR 24 AM 8:02

4. Lot No. _____, Recorded Plat _____
5. Private Claims _____

I, Kirk Breitels, in a field survey on Jan. 19, 1999, do hereby state that under requirements of P.A. 74, Michigan P.A. of 1970, the corner points mentioned in lines 1 and 2 above were in conformance with regulations and rules therefore as required in the current manual of survey instructions of the United States Department of the Interior, Bureau of Land Management or by a decree of a Court of Law and /or that the corner points mentioned in lines 3, 4 and 5 above were in conformance with the rules of the Michigan Board of Land Surveyors or by a Decree of a Court of Law; established, re-established, monumented, recovered, found as expressed below:

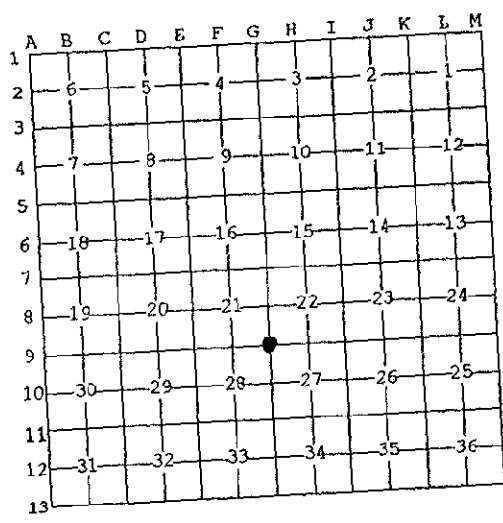

NOTE: Not more than 2 corners, all in the same town and range, may be recorded on this certificate.

A. Description of original monument and accessories and/or subsequent restoration:

G-9 1837	GLO	Whitcomb	Set Post
1931	Kent Co. Wits		Iron
1971	LCRC #1	Ratekin	1/2" Iron in Mon. Box
1981	LCRC #1956	Bonnema	1/2" Iron in Mon. Box
1982	LCRC #2653	Jonker	Set Kent County Monument in Mon. Box
1994	LCRC #7584	J. Glaza	Kent County Monument

The position of this corner was previously approved by the Kent County Remonumentation Peer Group, monumented by Robert J. Jonker on 2-8-82 and was recorded per LCRC #2653.

P.A. 345 1990 KENT COUNTY
PEER APPROVED 2/25/99
CHAIRMAN Harry Huber

B. Description of corner evidence found and/or method applied in restoring or reestablishing corner:

G-9 Found Kent Co. Mon. (Harrison) per witnesses from above LCRC as set by Robert J. Jonker in place of the 1/2" Iron he found in a Mon. Box over a Pointed Stone. Both Iron and Stone check with Kent Co. Wits. and LCRC's #1 & #1956.
LCRC #7584
Nail & Remon. tag P. Pole N45°W 70.10'
Nail & Remon. tag P. Pole N76°E 152.20'
Nail & Remon. tag P. Pole N76°E 152.20'
"V" notch SW leg of tower N32°E 78.15'
Nail & Remon. tag G. Pole S25°W 153.01'
C/L top utility ped. S17°W 158.7'
Nail & Remon. tag P. Pole N40°E 77.24'
C/L top East utility ped. S61°W 55.8'
C/L street sign S63°E 54'

C. Description of monument for corner and accessories established to perpetuate locating the position of the corner:

The selected location is accepted by me and is generally accepted by professional surveyors as the best available evidence of the position of the original corner.

G-9 Standard Kent County Monument in Mon. Box	
Nail & KC Remon. tag NE side P. Pole	N45°W 70.10'
Nail & KC Remon. tag S. side P. Pole	N76°E 152.06'
Nail & KC Remon. tag NW side G. Pole	S25°W 153.01'
Nail & KC Remon. tag NW side P. Pole	N40°E 77.24'
C/L Tyrone Ave. is 1' East	
C/L 18 Mile Rd. is 1' South	

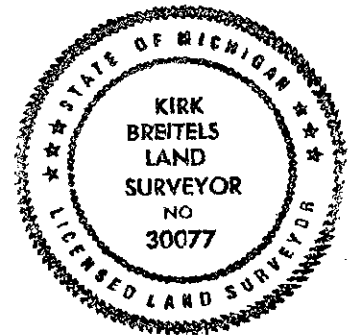

Signed by Kirk Breitels
Surveyor's Michigan License No. 30077

Date 2/25/99