

\$7.00
\$2.00

MAY 28 2000

KENT COUNTY REMONUMENTATION

SECTION

LAND CORNER RECORDATION CERTIFICATE Filing Requirement of Act 74, Mich. P.A. 1970

For corners in

KENT COUNTY
(County)

Located in:

Corner Code #

Tyrone Twp.

1. Public Land Survey

T 10 N R 12 W

H-3

T ___ R ___

T ___ R ___

T ___ R ___

T ___ R ___

2. Property Controlling
in Section

S ___ T ___ R ___

S ___ T ___ R ___

3. Miscellaneous
Property in Sec.

S ___ T ___ R ___

S ___ T ___ R ___

4. Lot No. _____, Recorded Plat _____

5. Private Claims _____

REG. OF DEEDS

1999 JUL -9 AM 11:20

STATE OF MICHIGAN
COUNTY OF KENT
RECEIVED FOR RECORD

11255

Register of Deeds Stamp & File Number

I, Kirk Breitels, in a field survey on May 26, 1999 do hereby state that under requirements of P.A. 74, Michigan P.A. of 1970, the corner points mentioned in lines 1 and 2 above were in conformance with regulations and rules therefore as required in the current manual of survey instructions of the United States Department of the Interior, Bureau of Land Management or by a decree of a Court of Law and /or that the corner points mentioned in lines 3, 4 and 5 above were in conformance with the rules of the Michigan Board of Land Surveyors or by a Decree of a Court of Law; established, re-established, monumented, recovered, found as expressed below:

NOTE: Not more than 2 corners, all in the same town and range, may be recorded on this certificate.

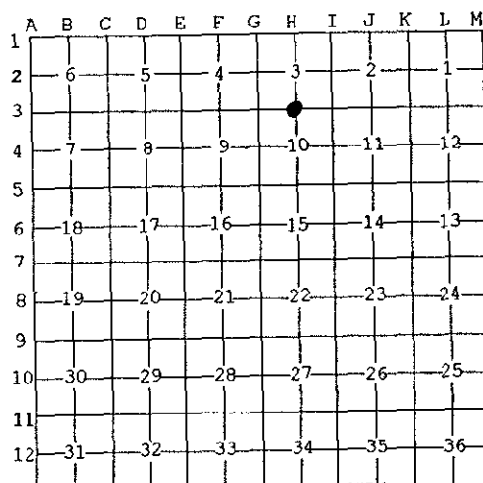

P.A. 345 1990 KENT COUNTY

PEER APPROVED 6/29/99
CHAIRMAN Harry Faber

A. Description of original monument and accessories and/or subsequent restoration:

H-3 1837	GLO	Whitcomb	Set Post
	Kent Co. Wits		Iron
1975	LCRC #825	Bonnema	Set 1/2" Iron at midpoint and on line with Section corners
1982	LCRC #3265	Hay	3/4" Iron
1982	LCRC #3006	Starr	Set Kent County Monument
1991	LCRC #5996	Byl	Reset Kent County Monument

The position of this corner was previously approved by the Kent County Remonumentation Peer Group, monumented by Thomas C. Starr on 8-2-82 and was recorded per LCRC #3006.

B. Description of corner evidence found and/or method applied in restoring or reestablishing corner:

H-3 Found BROKEN Kent County Monument (Harrison) per witnesses from above LCRC as set by Thomas C. Starr in place of the 1/2" Iron Pipe he found. Said Iron Pipe checks Kent Co. Wits. and LCRC's #825 & 3265.

LCRC #3006		LCRC #5996	
Nail & Remon. tag 10" Poplar	S60°E 59.20'	Nail & Remon. tag 12" Poplar	S60°E 59.23'
Nail & Remon. tag Twin 12" Ash	S30°E 23.18'	Nail & Remon. tag Twin 12" Ash	S30°E 23.32'
Nail & Remon. tag 6" Poplar	S20°W 24.34'	Nail & Remon. tag 8" Poplar "	S20°W 24.34'
Nail & Remon. tag 4" Elm	S70°W 44.89'	Nail & Remon. tag 8" Elm	S70°W 44.91'
Nail & Remon. tag 4 - 8" Maples	N60°W 42.58'	Nail & Remon. tag 4 - 8" Maples	N60°W 42.61'
Nail & Remon. tag top fence post	N70°E 45.73'	Nail & Remon. tag top fence post	N70°E 45.5' ±

The selected location is accepted by me and is generally accepted by professional surveyors as the best available evidence of the position of the original corner.

C. Description of monument for corner and accessories established to perpetuate locating the position of the corner:

H-3 Removed and Replaced Standard Kent County Monument

Nail & KC Remon. tag N. side 14" Poplar	S60°E 59.13'
Nail & KC Remon. tag E. side Twin 14" Ash	S30°E 23.32'
Nail & KC Remon. tag W. side 10" Poplar	S20°W 24.34'
Nail & KC Remon. tag S. side clump 4 - 8" Maples	N60°W 42.61'
Nail & KC Remon. tag SE side 10" Poplar	N45°E 26.54'
Nail & KC Remon. tag W. side 8" Poplar	N10°W 21.61'

In C/L gravel road ±

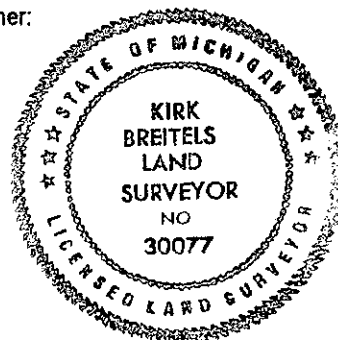

Signed by Kirk Breitels

Date 6/24/99

Surveyor's Michigan License No. 30077