

\$7.00
\$2.00

MAY 22 2000

KENT COUNTY REMONUMENTATION

SECTION

LAND CORNER RECORDATION CERTIFICATE
Filing Requirement of Act 74, Mich. P.A. 1970

For corners in

<u>KENT COUNTY</u> (County)	Located In:	Corner Code #
		Tyrone Twp.
1. Public Land Survey	T <u>10N</u> R <u>12W</u>	<u>H-6</u>
	T _____ R _____	_____
	T _____ R _____	_____
	T _____ R _____	_____
2. Property Controlling in Section	S _____ T _____ R _____	_____
	S _____ T _____ R _____	_____
3. Miscellaneous Property in Sec.	S _____ T _____ R _____	_____
	S _____ T _____ R _____	_____

4. Lot No. _____, Recorded Plat _____
5. Private Claims _____

I, Kirk Breitels, in a field survey on Aug. 20, 1999 do hereby state that under requirements of P.A. 74, Michigan P.A. of 1970, the corner points mentioned in lines 1 and 2 above were in conformance with regulations and rules therefore as required in the current manual of survey instructions of the United States Department of the Interior, Bureau of Land Management or by a decree of a Court of Law and /or that the corner points mentioned in lines 3, 4 and 5 above were in conformance with the rules of the Michigan Board of Land Surveyors or by a Decree of a Court of Law; established, re-established, monumented, recovered, found as expressed below:

NOTE: Not more than 2 corners, all in the same town and range, may be recorded on this certificate.

A. Description of original monument and accessories and/or subsequent restoration:

- H-6 1837 GLO Not Set
- 1894 Williams & Works Old Stake & "corrected" location
- Kent Co. Wits No information
- 1987 LCRC #4498 Hackbardt Set 1/2" Rebar at intersection of 1/4 lines
- MBT S20°W 64.52' C.P. S85°E 72.5' 36" Maple N30°W 69.55' SE cor. blk. hse. N45°W 138.25'

P.A. 345 1990 KENT COUNTY
PEER APPROVED 8/26/99
CHAIRMAN [Signature]

B. Description of corner evidence found and/or method applied in restoring or reestablishing corner:

H-6 Found 1/2" Rebar (no cap) per the following remaining witnesses:
Nail in MBT S20°W 64.60' Nail in C.P. S85°E 72.47' C/L 40" Maple N30°W 69'

Said 1/2" Rebar is 0.2' S. & less than 0.1' W. from intersection of 1/4 lines and has been used in surveys by Hackbardt and Roosien.

The 1/2" Rebar is accepted by me and is generally accepted by professional surveyors as the best available evidence of the position of the corner.

C. Description of monument for corner and accessories established to perpetuate locating the position of the corner:

- H-6 Set Standard Kent County Monument in place of the 1/2" Rebar
- Nail & KC Remon. tag W. side Tel. Pole S10°E 62.81'
- Nail & KC Remon. tag W. side Tel. Pole S20°W 64.60'
- Nail & KC Remon. tag S. side 36" Maple N75°W 30.71'
- Nail & KC Remon. tag SW side 40" Maple N30°W 69.10'
- Nail & KC Remon. tag N. side P. Pole S85°E 72.47'
- In C/L N-S gravel road ±

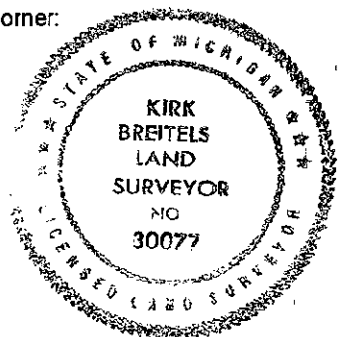

Signed by [Signature]
Surveyor's Michigan License No. 30077

Date 10/28/99

REG. OF DEEDS

1999 NOV -4 AM 8:37

STATE OF MICHIGAN
COUNTY OF KENT
RECEIVED FOR RECORD

11500
Register of Deeds Stamp & File Number

	A	B	C	D	E	F	G	H	I	J	K	L	M
1													
2		6		5		4		3		2		1	
3													
4		7		8		9		10		11		12	
5													
6		18		17		16		15		14		13	
7													
8		19		20		21		22		23		24	
9													
10		30		29		28		27		26		25	
11													
12		31		32		33		34		35		36	
13													